



True Blue Sheds

**Phone:** 1300 445 889

**Email:** [sales@trueblusheds.com.au](mailto:sales@trueblusheds.com.au)

**TrueBlueSheds**



**Zac Richards,  
Quote #91507916, 24/11/2022**

**Building Specifications**

**Building Site Address:**

48 Kilchatten Crescent, West Busselton, WA, 6280

**Building and Site Requirement:**

Design Roof Snow Load: N/A  
Wind Load/Exposure: 31.0 m/s  
Building Class: 10a  
Wind Region: A  
Importnce Level: 2  
Shielding: 0.83  
Terrain Category: 3  
Topography: 1

**Building Dimensions:**

Width: 5.000 m  
Length: 8.000 m  
Eave Height: 2.700 m  
Roof Pitch: 10 deg  
# Sidewall Bays: 2 4.000 m  
# Endwall Bays: 2 2.500 m

**Building Specs:**

Columns: C15019  
Rafters: C15019  
Endwall Column: C15012  
Roof Purlins: Z10010  
Side Wall Girts: Z10010  
End Wall Girts: Z10010

**Leanto A Details:**

|                  |                |
|------------------|----------------|
| Span: N/A        | Bays: N/A      |
| Drop: N/A        | Roof Pitch:N/A |
| Eave Height: N/A |                |

**Leanto B Details:**

|                  |                 |
|------------------|-----------------|
| Span: N/A        | Bays: N/A       |
| Drop: N/A        | Roof Pitch: N/A |
| Eave Height: N/A |                 |

### Sheeting and Trim Details:

Roof Type: Trimclad 0.42 CB  
Roof Color: Windspray  
Wall Type: Trimclad 0.42 CB  
Wall Color: Windspray  
Eave Trim/Gutter Type: Patio Line Gutter  
Trim Color: Windspray (WY)

### Opening Details:

Personnel doors: 1x Larnec 2040 x 820 x 35mm - Pre Hung - Colorbond Single Skin - P/C Tube Frame - Wind Class N4 & C1 Knob/Knob Basalt

- 

Roller Doors: H2100xW2600 ROW Roller Door Basalt (actual opening size 2100h x 2400w) in Center of bay 1 of Sidewall B

- 

Windows: None

- 

Framed Openings: None

- 

Open Bays: None

- 

Translucent Panels: None

### Insulation Details:

None

### Mezzanine:

Floor Height: N/A      Bays: N/A  
Live Load: N/A      Joist Spacing: N/A

### Extra Options:

N/A

### Total Building Weight:

1197.14kg

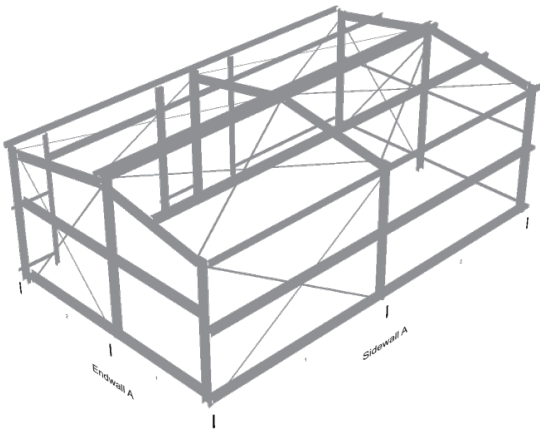
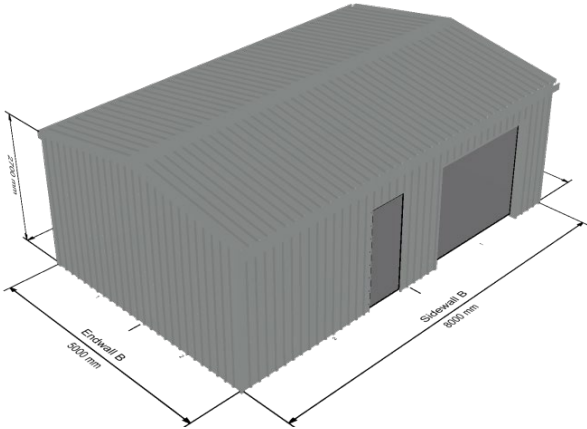
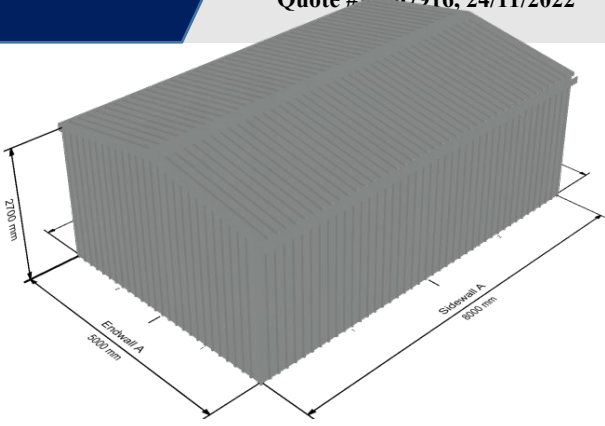

## Important Terms & Conditions

### 1. **Payment**

- (a) The Customer shall pay the Supplier the amount(s) stated as per payment schedule accompanying the order.
- (b) The Supplier is not obliged to deliver any Goods unless the Customer has paid all amounts in full.
- (c) The Customer must pay to the Supplier all debt collection costs, including any legal fees associated with the recovery or attempted recovery of any amount due to the Supplier under the Agreement.
- (d) Goods for each building are made as required, any orders cancelled after order placement will not be refunded.

### 2. **Ownership**

- (a) Ownership of the Goods does not pass to the Customer until all amounts due are paid to the Supplier. ( b) Unless payment for the Goods is made to the Supplier by due date, the Supplier, or its agents or employees, may at any time enter on to the site where the Goods are stored and remove the Goods.
- (c) The Customer must indemnify the Supplier in respect of any claims, losses, costs, or damages that the Supplier may incur as a result of the Supplier taking action under clause 2(b).
- (d) Until the Customer has paid for the Goods;
- (i) The Customer must not use, sell, lease, dispose, assign, or encumber the Goods (by mortgage, lien, charge or otherwise) without the consent of the Supplier; and
- (ii) The Customer must store the Goods separately in a readily identifiable state.

### 3. **Council**

- (a) The Customer agrees to pay any additional costs incurred should the Local Council require any changes be made to the building.
- (b) A rejection of any building application or scope of works by the Local Council does not constitute a cancellation of the order and all moneys payable by the Customer to the Supplier shall become immediately due and payable.

### 4. **Delivery**

- (a) The Customer will at his expense provide or cause to be provided full and clear access to the delivery site.
- (b) Times for delivery are approximate and the Supplier can in no way be held responsible for variations to the proposed times.
- (c) Where delivery is specified to be made to a site, any additional mechanical assistance required to unload the Goods (e.g. crane, etc) must be paid for and organised by the Customer.
- (d) The Customer is to immediately notify the Supplier in writing upon discovery of any defect or shortage in the Goods. The Customer is deemed to have accepted the Goods and shall not have any claim in respect of defects or shortage unless the Supplier is notified in writing within forty-eight (48) hours of delivery of the Goods.

5. General

(a) Minor variations in measurements from those shown in the order shall not give rise to any claim for damages or breach of Agreement.

(b) To the extent permitted by law, the Supplier’s liability with respect to the supply of defective or faulty Goods is limited to the lowest of:

(i) The replacement or repair of the Goods; or

(ii) Payment of the costs of replacing the Goods or supplying equivalent Goods, in each case, at the Suppliers discretion. The Supplier shall not be liable for any labour costs associated with such repair or replacement.

(c) The Customer warrants that he has carried out his own inquiries and investigations as to adequacy or suitability of the Goods for the purpose for which the Customer intends to use the Goods and the Customer has not relied on the Supplier or the supplier’s employees, agents or distributors in determining the adequacy or suitability of the Goods for the Customer’s purposes.

(d) If the Customer defaults under any term of the Agreement or these Terms & Conditions, the Supplier may terminate the Agreement and all moneys payable by the Customer to the Supplier shall become immediately due and payable.

Pricing & Payment Terms

Purchase Conditions:

10% Deposit for stamped engineering drawings

50% Total prior to manufacturing. (40% due if 10% engineering has been paid)

50% Balance to be paid 10 days before delivery

Special Terms – Must Read!!!

Delivery is to the front of the property only unless there is sufficient area for the delivery truck to return around on your property.

The shed package remains the property of True Blue Sheds until fully paid for.

The purchaser agrees to accept the shed package within 8-10 weeks of ORDERING barring any steel shortages or unforeseen issues.

In the event of a material price rise by the material manufacturer, the purchaser agrees to pay the increase.

CLIENT: Zac Richards

Clients Address: 48 Kilchatten Crescent

West Busselton, WA, 6280

Phone: 0410223858

Date: 24/11/2022

Signed Acceptance of Building Price and Design: \_\_\_\_\_

Signed That Terms and Conditions Have Been Read: \_\_\_\_\_

Stamped Engineering Plans

Bored foundation plans included

100mm Slab

Main Column Footings: 500 mm - 400 mm

End Mullion Footings: 500 mm - 400 mm

Total Kit Price: \$8,410.06

Delivery included  
Price valid for 30 days

Your roof is protecting your most precious investments, your home and your family. You can be confident knowing COLORBOND® steel is versatile, lightweight, durable, and capable of meeting the changing needs of your lifestyle. Whether you live close to the coast or you're choosing a colour with energy-efficiency in mind, COLORBOND® steel can meet the needs that your home demands. Simply visit [colorbond.com/create](http://colorbond.com/create) to determine the most suitable COLORBOND® steel choices for your home.



**LEGEND**

① Also available in COLORBOND® Ultra steel for coastal and industrial environments. All other colours are available in COLORBOND® Ultra steel on request, please speak with your supplier.

② Also available in COLORBOND® Stainless steel for severe coastal and industrial environments. Please speak to your supplier for more information regarding availability.

For further details on the legend, please refer to the back page.

**CLASSIC colour range<sup>1</sup>**



**CLASSIC CREAM™**  
SA = 0.32. BCA = L



**PAPERBARK®**  
SA = 0.42. BCA = M



**PALE EUCALYPT®**  
SA = 0.60. BCA = M



**WOODLAND GREY® ②**  
SA = 0.71. BCA = D



**DEEP OCEAN® ②**  
SA = 0.75. BCA = D



**COTTAGE GREEN®**  
SA = 0.75. BCA = D



**MANOR RED®**  
SA = 0.69. BCA = D



**NIGHT SKY®**  
SA = 0.96. BCA = D

**CONTEMPORARY colour range<sup>1</sup>**



**SURFMIST® ②②**  
SA = 0.32. BCA = L



**EVENING HAZE®**  
SA = 0.43. BCA = M



**SHALE GREY™**  
SA = 0.43. BCA = M



**DUNE® ②②**  
SA = 0.47. BCA = M



**COVE™**  
SA = 0.54. BCA = M



**WINDSPRAY® ②②**  
SA = 0.58. BCA = M



**GULLY™**  
SA = 0.63. BCA = D



**MANGROVE™**  
SA = 0.64. BCA = D



**WALLABY™ ②**  
SA = 0.64. BCA = D



**JASPER®**  
SA = 0.68. BCA = D



**BASALT™**  
SA = 0.69. BCA = D



**IRONSTONE®**  
SA = 0.74. BCA = D



**TERRAIN®**  
SA = 0.69. BCA = D



**MONUMENT® ②**  
SA = 0.73. BCA = D