

**ISSUED FOR REVIEW**

DO NOT SCALE FROM DRAWING

REV No	REVISION DESCRIPTION	DRN BY	APP'D BY	CHKD BY	DATE

CLIENT: STEVEN THOMPSON & JANE SOICH		PROJECT: 65 YVONNE STREET, HIGHWORTH (7SP306842)		SHEET SIZE <b>A3</b>
DRAWN BY: SWT	DATE: 16-02-2025	DESIGNED BY:	DATE:	
DES. CHECKED BY: DATE: RPEQ:		DRAWING No: <b>1000-02</b>		REVISION <b>1</b>
CAD FILE No:		SCALE: 1:500	JOB CODE: 1	

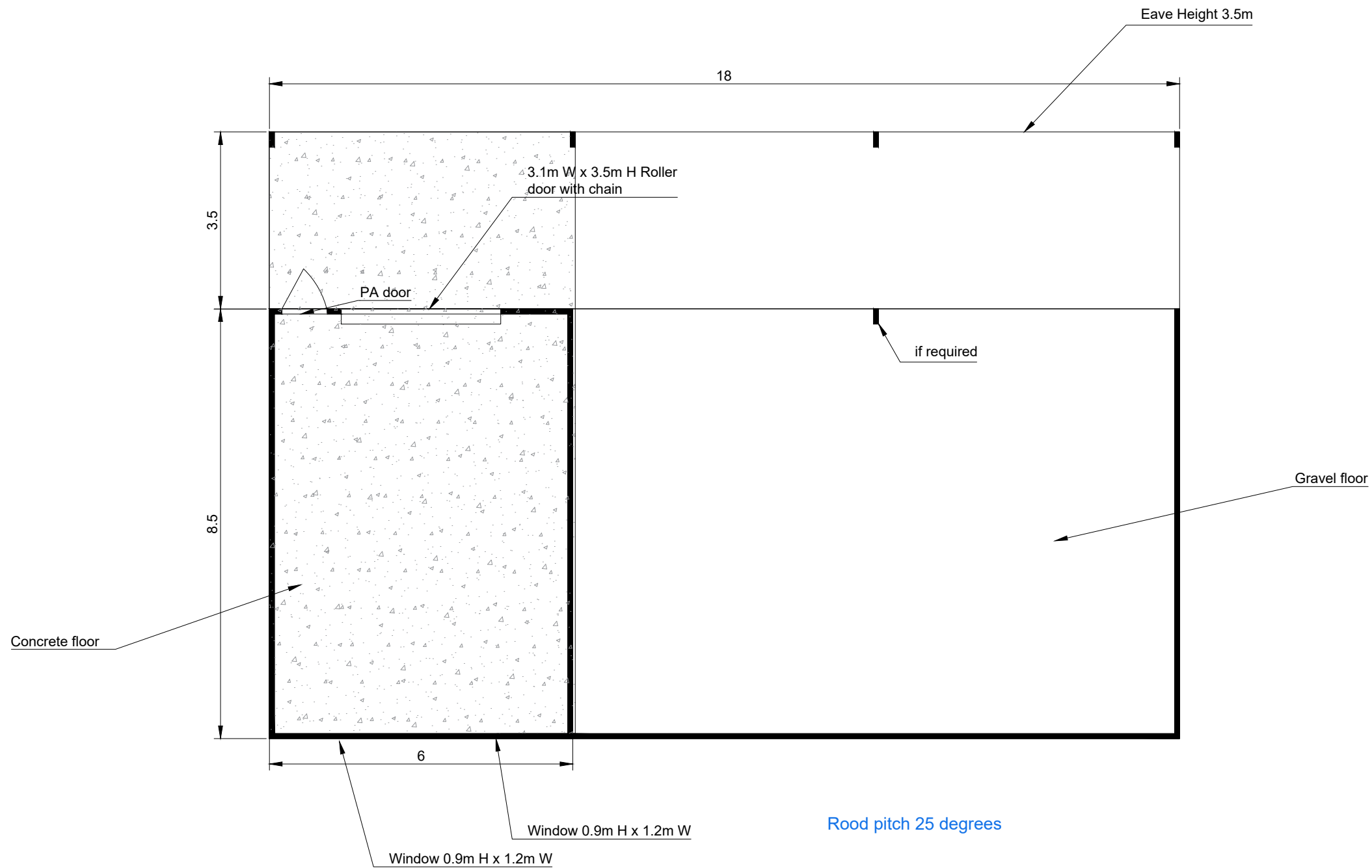

ISSUED FOR CONSTRUCTION

DO NOT SCALE FROM DRAWING

REV No	REVISION DESCRIPTION	DRN BY	APP'D BY	CHKD BY	DATE

CLIENT: STEVEN THOMPSON & JANE SOICH		PROJECT: 65 YVONNE STREET, HIGHWORTH (7SP306842)		SHEET SIZE <b>A3</b>
DRAWN BY: SWT	DATE: 13-08-'24	DESIGNED BY:	DATE:	
DES. CHECKED BY: DATE:		RPEQ:		REVISION <b>1</b>
CAD FILE No:		SCALE: 1:100	DRAWING No: <b>1000-03</b>	
		JOB CODE: 1		

# Summary

Our Ref: 25al019-A/AA  
Client: Stylemaster Homes  
Project: Residence for S & J Thompson & Soich  
65 (Lot 7) Yvonne Street, Highworth QLD

---

Nominal AS2870 Classification: "P" with an equivalent reactivity to class "S"

Wind Speed Recommendation **N4**

---

## Preliminary Slab Recommendations:

Solely for the purposes of Stylemaster Homes for preliminary cost estimation only and is based on a typical Stylemaster Homes 2 storey residence. **NOT TO BE USED FOR CONSTRUCTION.**

<b>Waffle Raft Depth</b>	310mm
<b>Slab Reinforcing</b>	N12 Bars - SL82 Slab Mesh
<b>Pier Requirements</b>	Piers will be required for soft natural soils, any root zones for existing or removed trees and any uncontrolled platform fill. If any part of the edge rib or footings found into rock, then all the edge rib and footings should be pried to rock.
<b>Pier Founding Material</b>	<b>Footings/Edge Rib:</b> Natural firm material / weathered rock (refer above) <b>Slab:</b> Natural firm material
<b>Tree proximity alert</b> (based on current site conditions at time of soil test only)	<b>No.</b> At the time of the investigation there were trees on or within close proximity to the site, however due to the nature of the soils found no significant tree effects are expected. It is recommended for trees close to the proposed structure that an arborist be engaged to confirm the effect of the trees and any measures to be taken to protect the building structure.

---

**Refer to full report**