

Domestic Shed

Specifications

1. 14mL x 9m W x 4.5m H
2. Roof insulation
3. 15° Roof pitch
4. Vermin proofed
5. Colourband
6. Gutters + Down pipe
7. Gabled Roof
8. Motorised doors

- A - Roller Door 3600mmH x 3600W
- B - Roller Door 3600mmH x 3200W
- C - Sectional Door 2700mmH x 4500mmW
- D - Glass sliding door 2100mmH x 2000mmW
- E - Window about 800mmH x 1800mmW

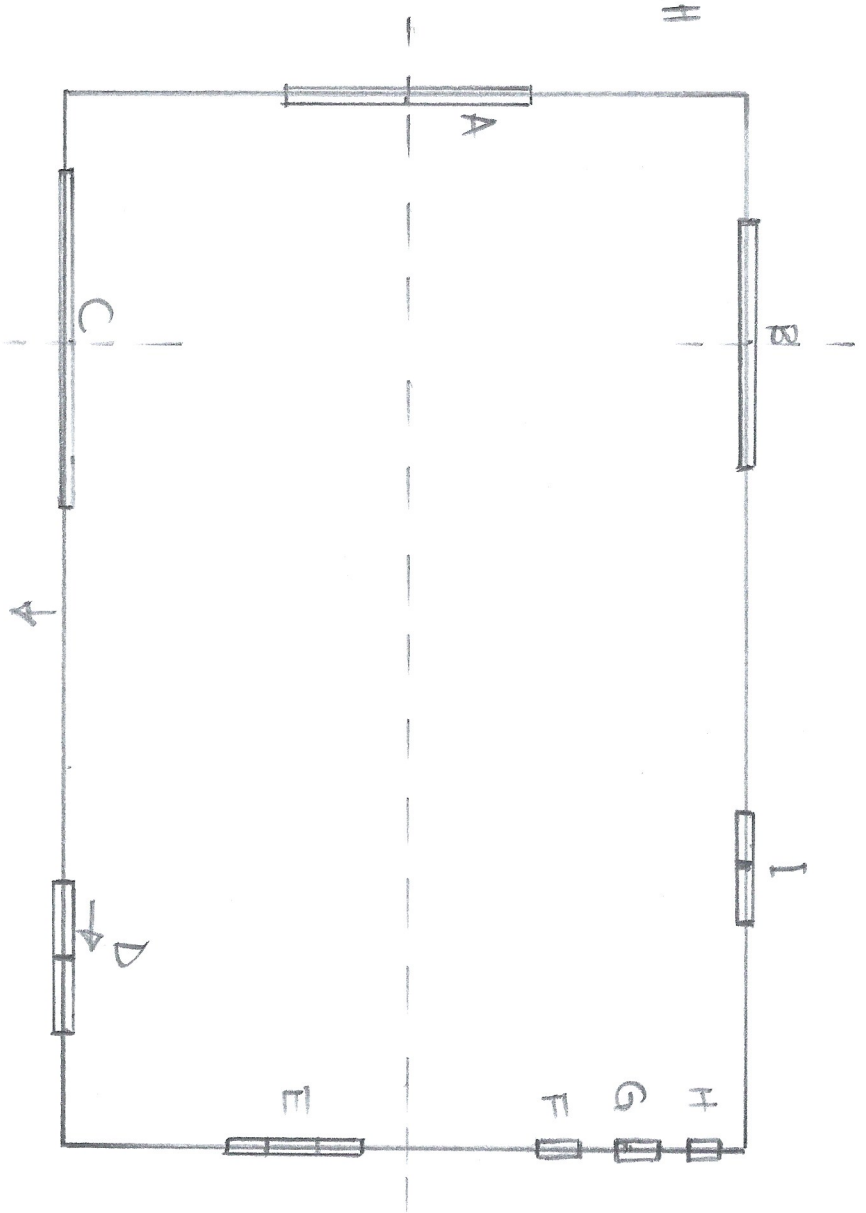

- F, G + H - windows 600mmH x 500mmW
- I - Window 800mmH x 1500mmW

Hammond Citate
 17 English Yew
 Gelorup - 6230
 Phone - 0429344950

19/10/22