

MEMBER SCHEDULE

MARK	DESCRIPTION	NOTES
P1	SUREFOOT FOOTING BY OTHERS	THE DOWN REQUIRED
P2	SUREFOOT FOOTING BY OTHERS	THE DOWN REQUIRED
P3	600Ø MASS CONCRETE PIER x 1000 DEEP	
P4	600Ø MASS CONCRETE PIER x 1500 DEEP	

- ALL FOOTINGS P1 & P2 ARE LOCATED UNDER THE CENTER OF FLOOR CHANNELS (UNLESS NOTED OTHERWISE)
- FACT P1 & P2 FOOTING REQUIRED TO CARRY MINIMUM 15KN IN BEARING & 19KN IN TENSION

NOTES:

- GENERAL
 - Other drawings shall be read in conjunction with all architectural and structural drawings and with any other drawings or documents which may be referred to in any drawing or document.
 - All dimensions are to be indicated from the Architect's drawings or from dimensions indicated on the drawings.
 - Dimensions for the Contractor shall be responsible for maintaining the structure in a stable condition and ensuring no part shall be overstressed under construction activities.
 - Material and workmanship are to be in accordance with the relevant Australian Standards.
 - The approval of a subcontractor by the Engineer is not an authorization for work commences. Any extra involved must be taken up with the Architect before the work commences.
 - The structural work shown on these drawings has been designed for the following live loads:

AREA	UPE (kN/m)
RESIDENCE	3.0
 - Foundation method to be approved before pouring concrete for a site bearing capacity of 17.25 kPa

STRUCTURAL STEELWORK

- All workmanship and materials shall be in accordance with AS 4100.
- Welding shall be performed by an experienced operator in accordance with AS 1511.
- High Strength Bolting shall be in accordance with AS 1511.
- No copies of the shop detail drawings are to be submitted to the Engineer for approval. The Contractor shall provide and have in place until permanent bolting elements are constructed such temporary bolting as is necessary to ensure the structural stability of beams, girders, joists, etc. to 2mm for every 1m of span unless otherwise noted.
- All girths and stiffeners for lining of timber members, etc. to be provided by fabricator.
- Except where otherwise shown connections shall have continuous end plates.
- Concrete encased steelwork shall be mopped with fabric, unless otherwise shown.
- Steelwork shall be thoroughly wet cleaned and given one shop coat of primer.
- Steelwork shall be thoroughly wet cleaned and given two coats of primer where H.S. bolts are used.

CONCRETE

- All workmanship and materials shall be in accordance with AS 3600.
- Concrete cover to all reinforcement (fibres not included)

ELEMENT	SHIELDED	EXPOSED	IN FRESH WORK
Slabs & walls	20mm	20mm	20mm
Columns	40mm	30mm	25mm
Beams	40mm	30mm	25mm
Footing	50mm	50mm	25mm

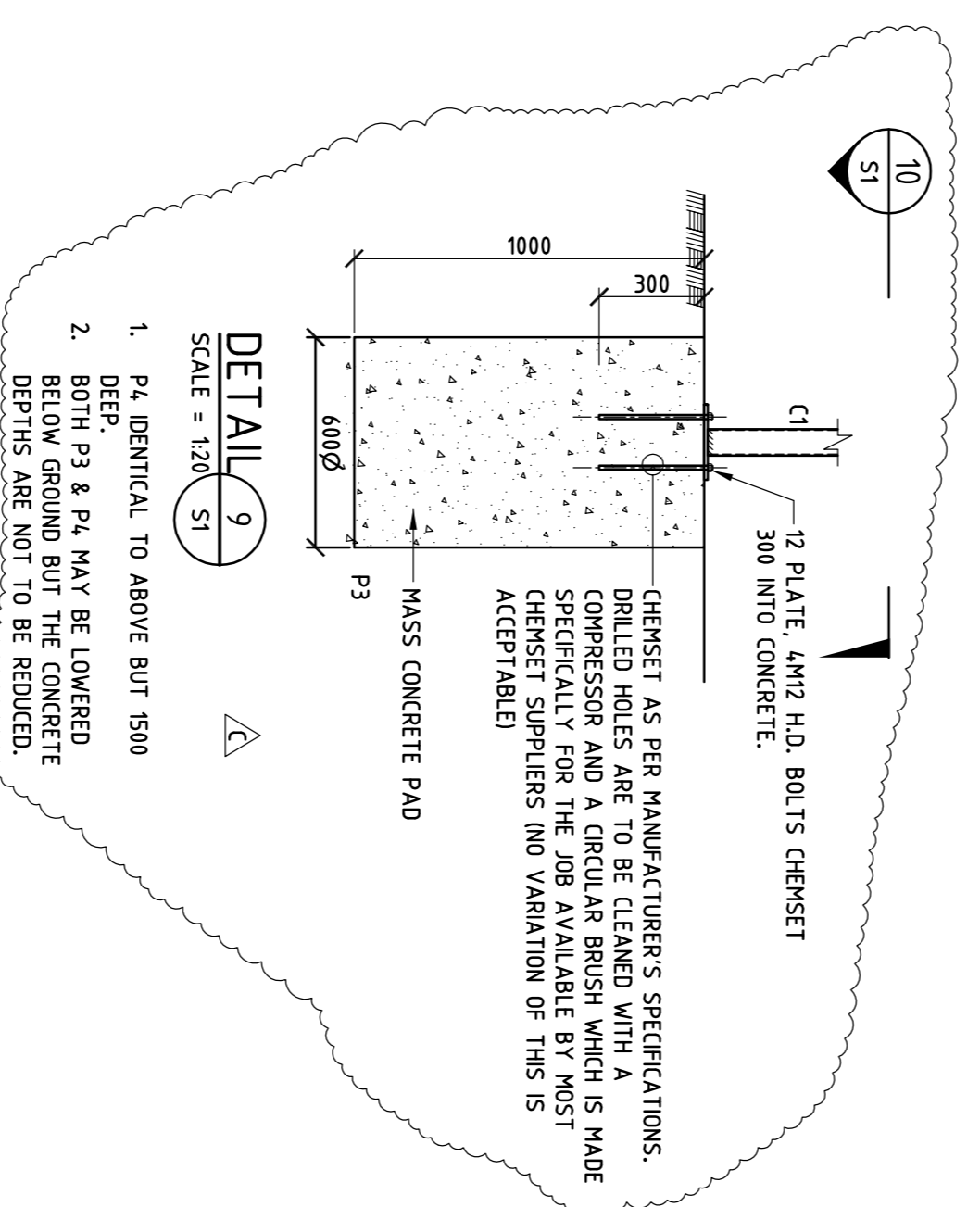

- DETAIL 9
- P4 IDENTICAL TO ABOVE BUT 1500 DEEP. P3 & P4 MAY BE LOWERED BELOW GROUND BUT THE CONCRETE DEPTHS ARE NOT TO BE REDUCED.

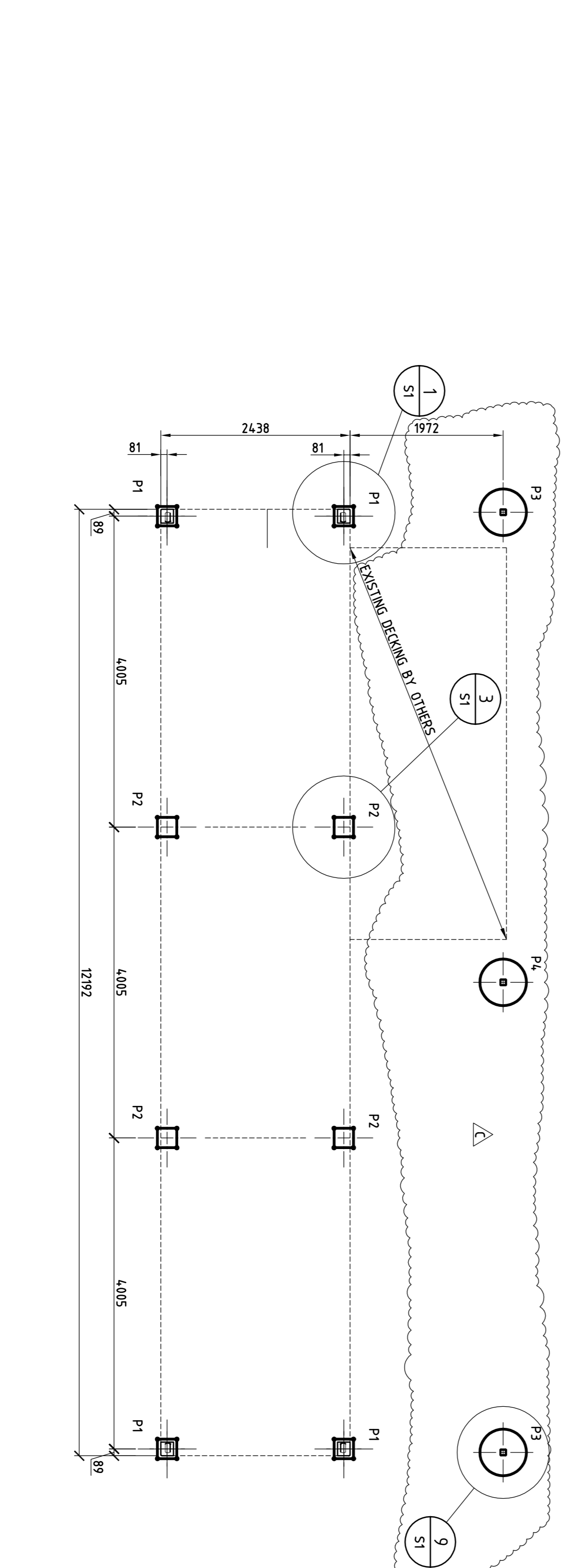

FOOTING LAYOUT

- SCALE = 1:50
- NOTE: ALL FOOTINGS ARE LOCATED UNDER THE CENTER OF FLOOR CHANNELS

REGION	B1
TOPOGRAPHICAL CLASS	T0
TERRAIN CATEGORY	TC2.5
WIND CLASSIFICATION	N3
WIND SPEED	57 m/sec

1. GENERAL NOTES

- Any external pointing to the building to be constructed not to allow water to pond between the building and the concrete pavements.
- Leveling between concrete areas and the building to raise the ground level is not acceptable.

2. DRAINAGE REQUIREMENTS

- Recessed concrete drainage shall be installed as it shall be protected with an adequate system of drainage in accordance with the following:
 - Core shall be taken with surface drainage of the abutment from the start of construction. The drainage system shall be completed by the finish of construction of the units.
 - Penetration flashings shall be spaced away from the building and shall be installed with clay in the top 300mm within 15mm of the building. The clay used for bedding shall be compacted. Where gaps exist under the flashing system, the benches shall be backfilled with clay or concrete to restrict the ingress of water beneath the flashing system.
 - Substance drains shall be free draining and shall be able to be opened and resealed. Substance drains shall be protected by filters and gullyheads.

3. PILING REQUIREMENTS

- Reinforced concrete piles installed as it shall be protected with an adequate system of piling guides in accordance with the following:
 - Connection of stormwater drains and waste drains shall include flexible connectors.
 - All work shall comply with the local planning and drainage regulations.

4. MAINTENANCE REQUIREMENTS TO BE MAINTAINED

- Efficient drainage must be provided and maintained. Water must not be allowed to pond near any structure and on sloping sites storm or underground drains should be installed as appropriate.
- Care shall be taken with the location of trees and as a broad guide these shall be positioned a distance of at least their mature height away from the structure. Large shrubs planted close to footings can also cause problems.
- General garden maintenance should commence from time of occupation with the basic object of maintaining moisture conditions as uniform as possible. The soil should be kept in good condition in favour of water intake. Two years when gardening is neglected in favour of water intake.
- Structural benches should not be loaded too close to the structure. The maximum load should be at a distance away from the structure at least equal to their depth.
- Poles, stumps and other structures should be installed and maintained to ensure that loading does not occur.
- All brickwork structures must be well finished.

5. NOTES

- Site preparation to be in accordance with Section 6 of AS 2870.1. Refer also to the soil report for specific recommendations.

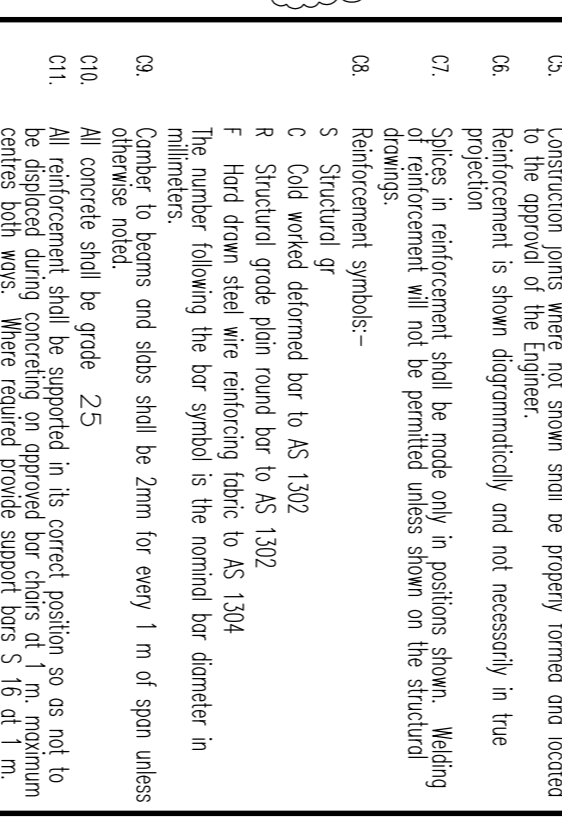
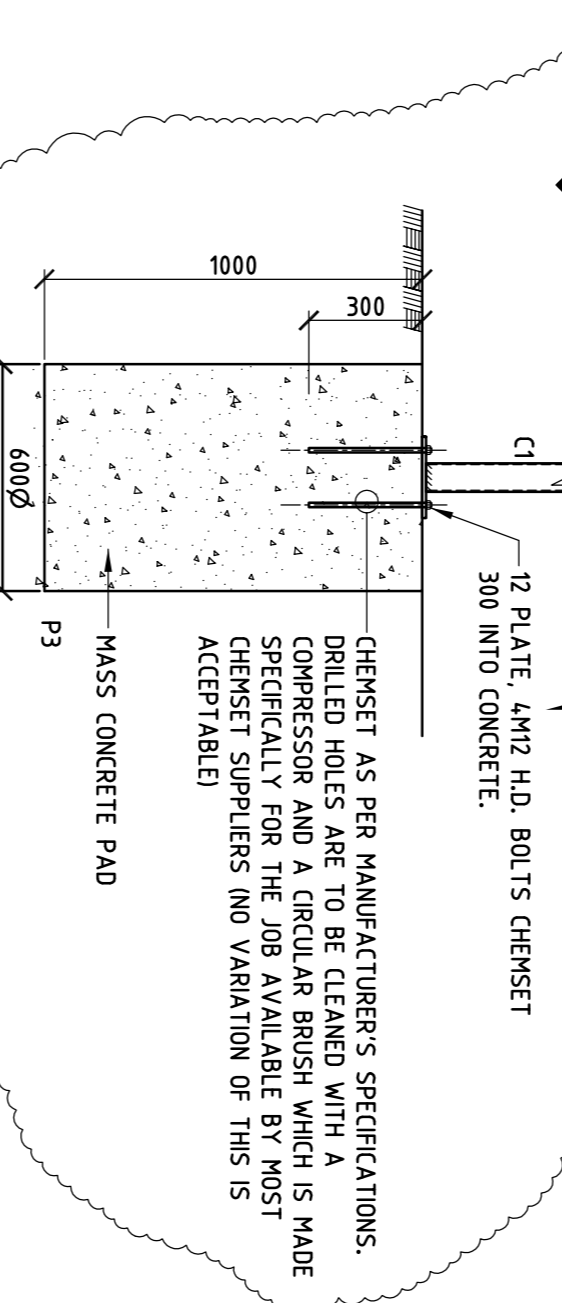
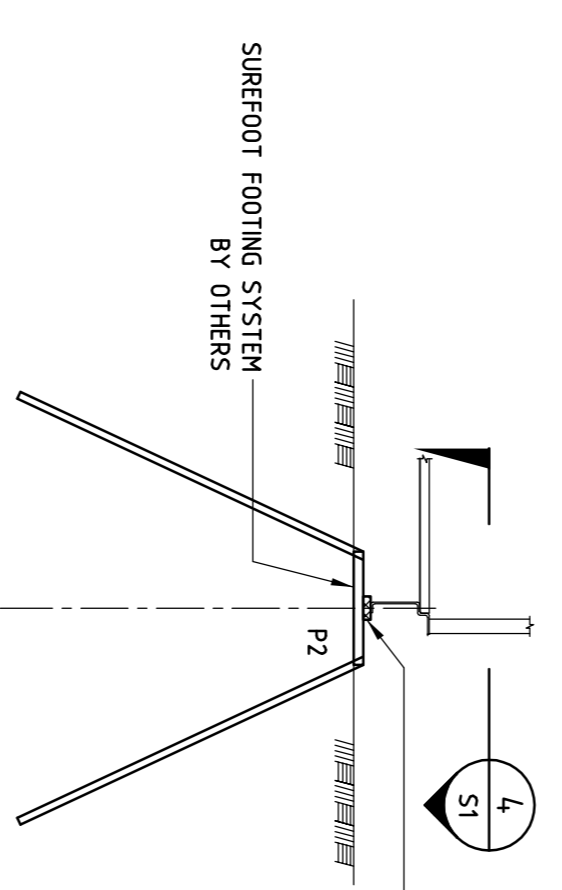
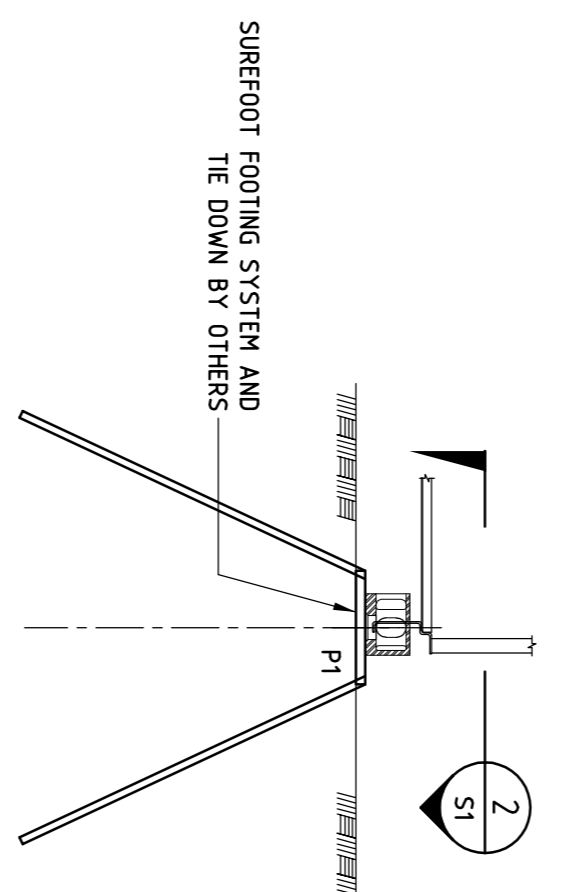

DETAIL 1
SCALE = 1:20

DETAIL 3
SCALE = 1:20

DETAIL 9
SCALE = 1:20

CIVILSTRUT DESIGN PTY LTD

FOR
ANTHONY & KAREN WYATT
LOCATION
LOT 4 SP209636, ANNIE ST MOUNT PERRY, QLD 4671

PROJECT
PROPOSED CONTAINER RESIDENCE

DRAWN: A.T. DATE: AUG. 2023
CHECKED: D.Tambosco

DRAWING No. **S202332** SHEET **1C** OF **2**

4/11 07 07 03 4/11 29 03 01 11 5/11 5/11
CONSULTING STRUCTURAL & CIVIL ENGINEERS
1 Centro Court, Brooklyn VIC 3012
Phone (03) 9314 1580 Fax (03) 9318 9889