

**Garage/ office – Helen Street, Northcote**



Existing space – from carpark/external



Existing space – from internal

---

# What's required – demolition/removal

- Demolition
  - Remove existing garage
  - Remove existing gate
  - Remove existing fence
  - Remove existing pathway
  - Remove existing garden including 2xpalm trees



# What's required

- Build
  - One enclosed garage/office across full back of property
  - Including: Rollerdoor, velux skylight, window, sliding/bifold door facing property, side facing property to have some visual aspects like wood etc
  - Levelling of ground, concrete floor (either polished or painted).
  - Internal walls of garage plasterboard
  - Building of internal storage cavity including it's own sliding door, and shelving.
  - Downlights across garage
  - Build of steps/garden area from new structure to level of garden

# Garage layout

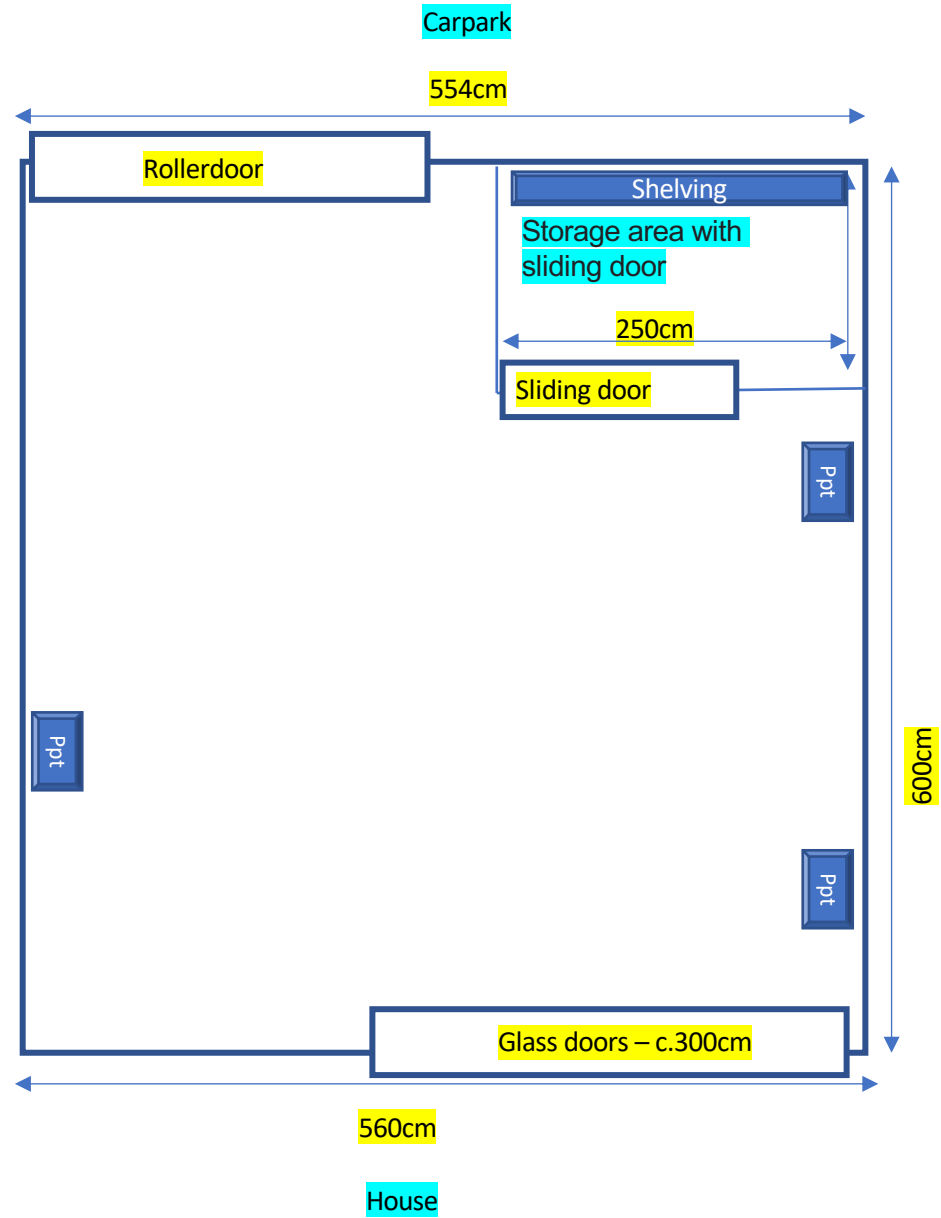

# Facades – back facing carpark

Inspiration:



## Brief

- Rollerdoor right aligned as much as possible
- Colourbond (or Brick like neighbours)
- If there is any surfaces that are deterrent to Graffiti (bonus)

### Stramit SharpLine® architectural wall cladding

- Add elegance and class to your garage through the striking look of SharpLine® cladding
- Let your architectural creativity shine through
- Attaches with direct-fix fasteners.



# Facades - Side facing 108 Helen Street (rental)

## Inspiration:

### Stramit SharpLine® architectural wall cladding

- Add elegance and class to your garage through the striking look of SharpLine® cladding
- Let your architectural creativity shine through
- Attaches with direct-fix fasteners.



COLORBOND® steel  
Monument®

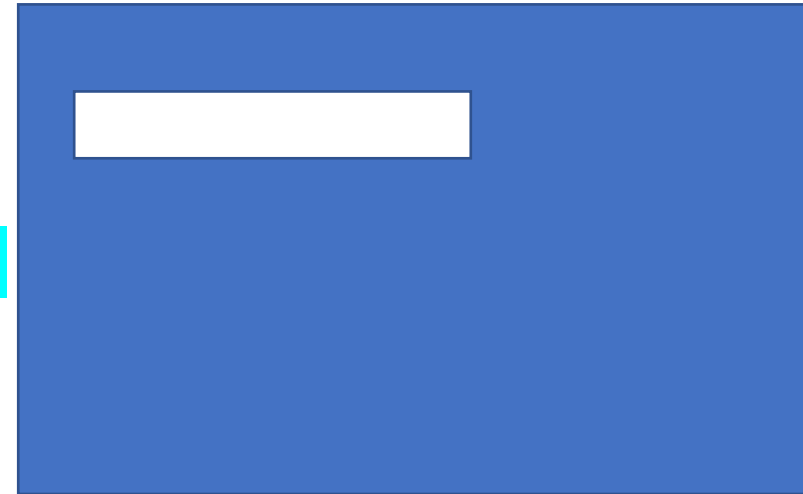

## Brief

- Side – colourboard with one long rectangle window, that is openable). May need to be tinted due to neighbours (TBC – with planning)

# Facades - Side facing Nicks house



Built against brick. No visual.

# Facades - Front facing garden

Inspiration:

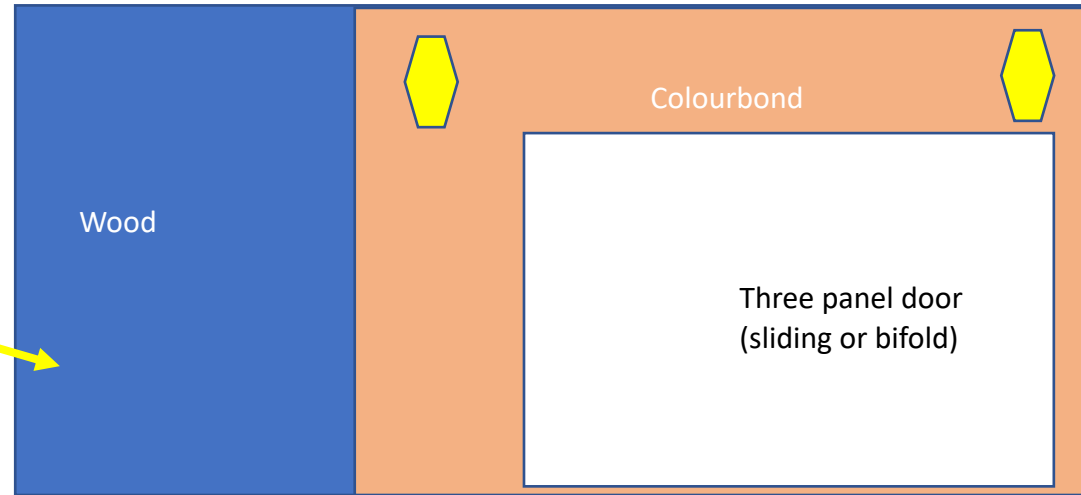
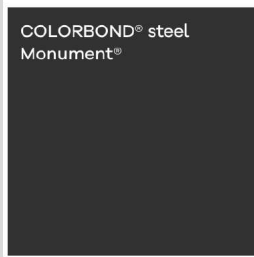

## Brief

- Office/studio style design
- Mix of Colorbond, wood and glass
- Outdoor lights x 2

Ben – or should we reverse the wood and colourbond (easier maintenances)

# Facades – roof



0°-60°  
INSTALLATION PITCH

House

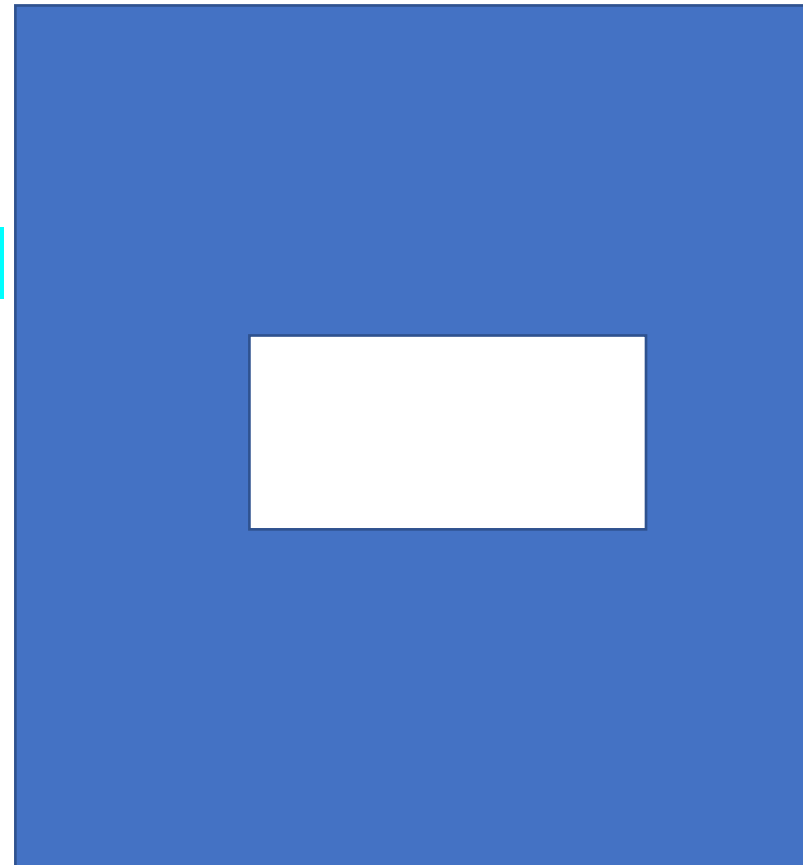

Carpark

## Brief

- Flat roof
- With one 870x1275 Velux non-opening skylight

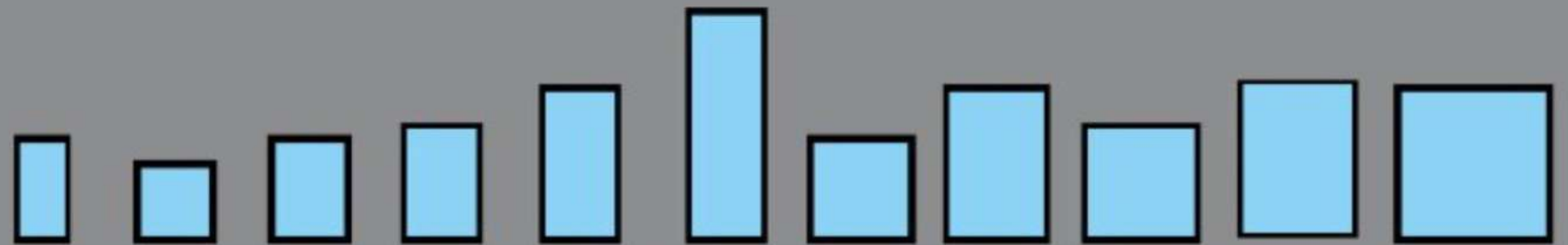

Overall throat dimension wxd mm ▶ 460 x 870 665 x 665 665 x 870 665 x 970 665 x 1275 665 x 1885 870 x 870 870 x 1275 970 x 970 970 x 1275 1275 x 1275

# Interior

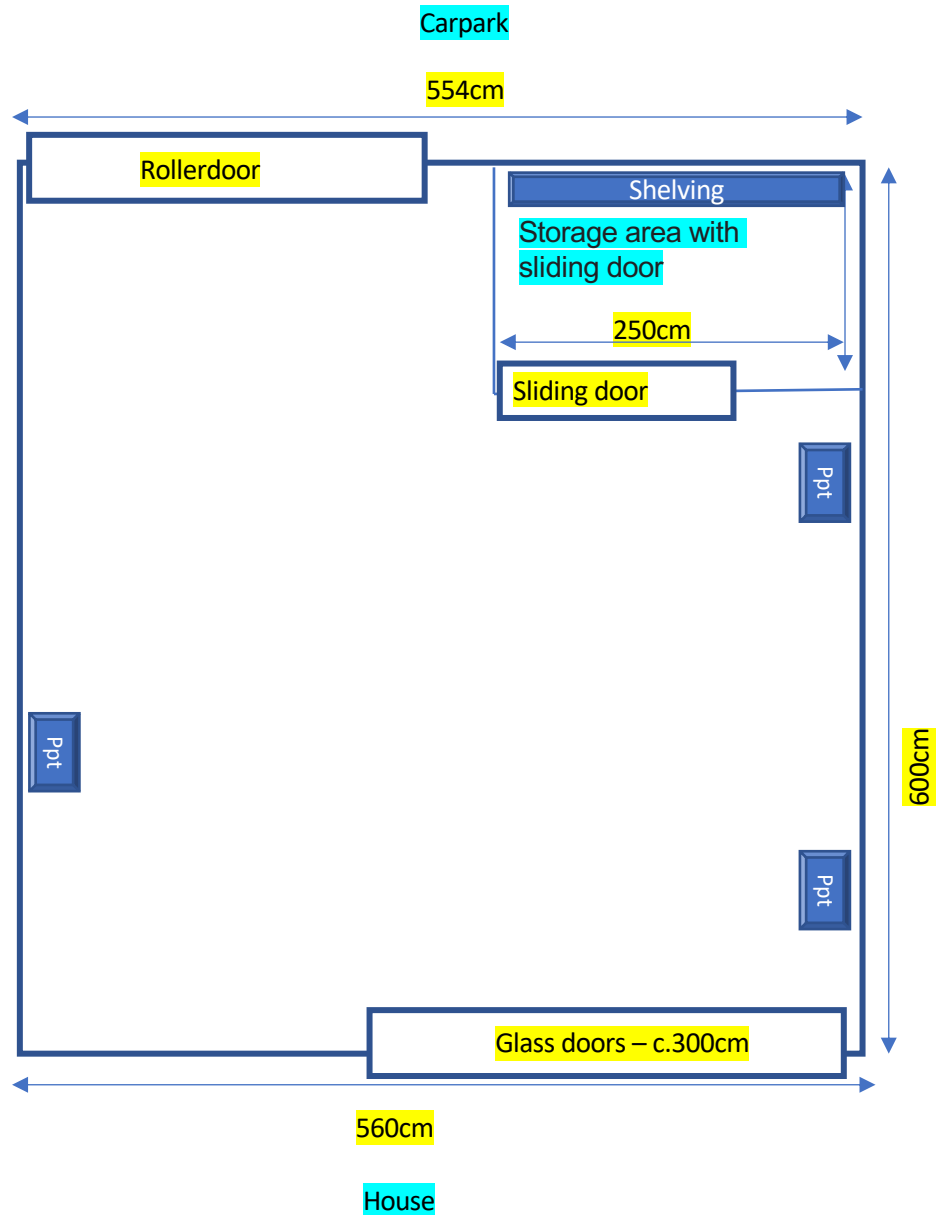

## Brief

- Internal storage including:
  - roof hang for surf boards/ wood etc
  - Shelving along carpark wall – 2 levels
- Polished concrete/ or flat concrete floor
- Walls all plasterboard with skirting, ready for painting
- Open to ceiling
- Downlights fitted across garage – as per reco (estimated 7)
- Powerpoints (ppt) x 3



# From garage to garden

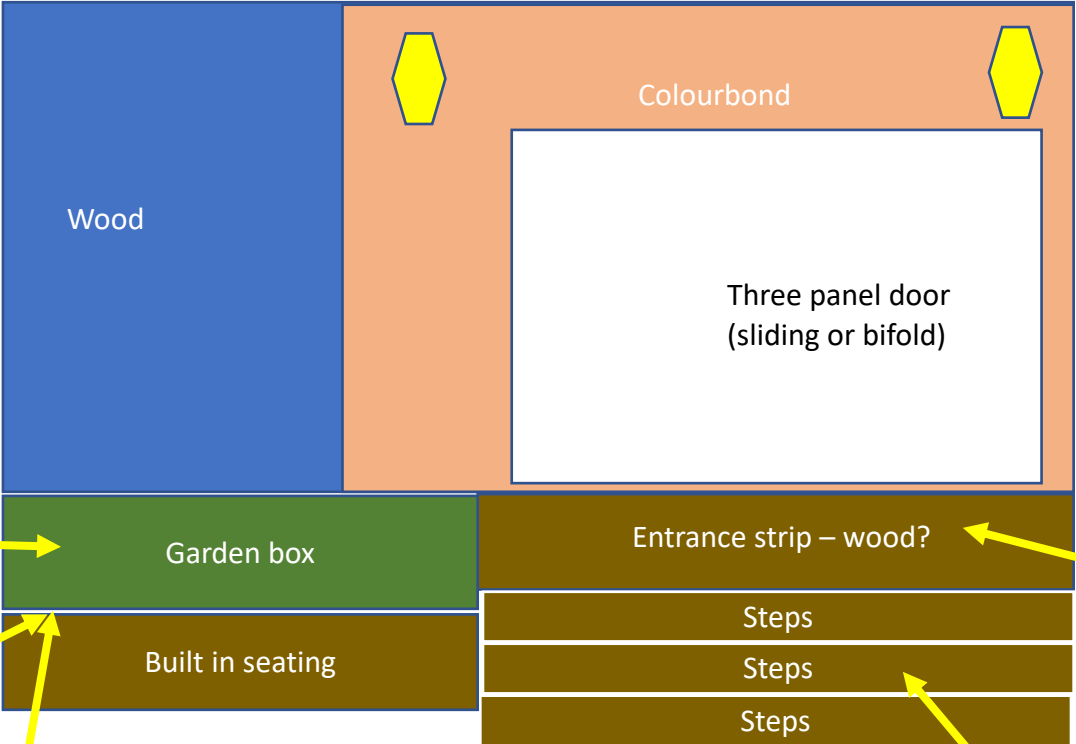



Stepping stones  
from steps to  
house