

Garage Design and Dimensions

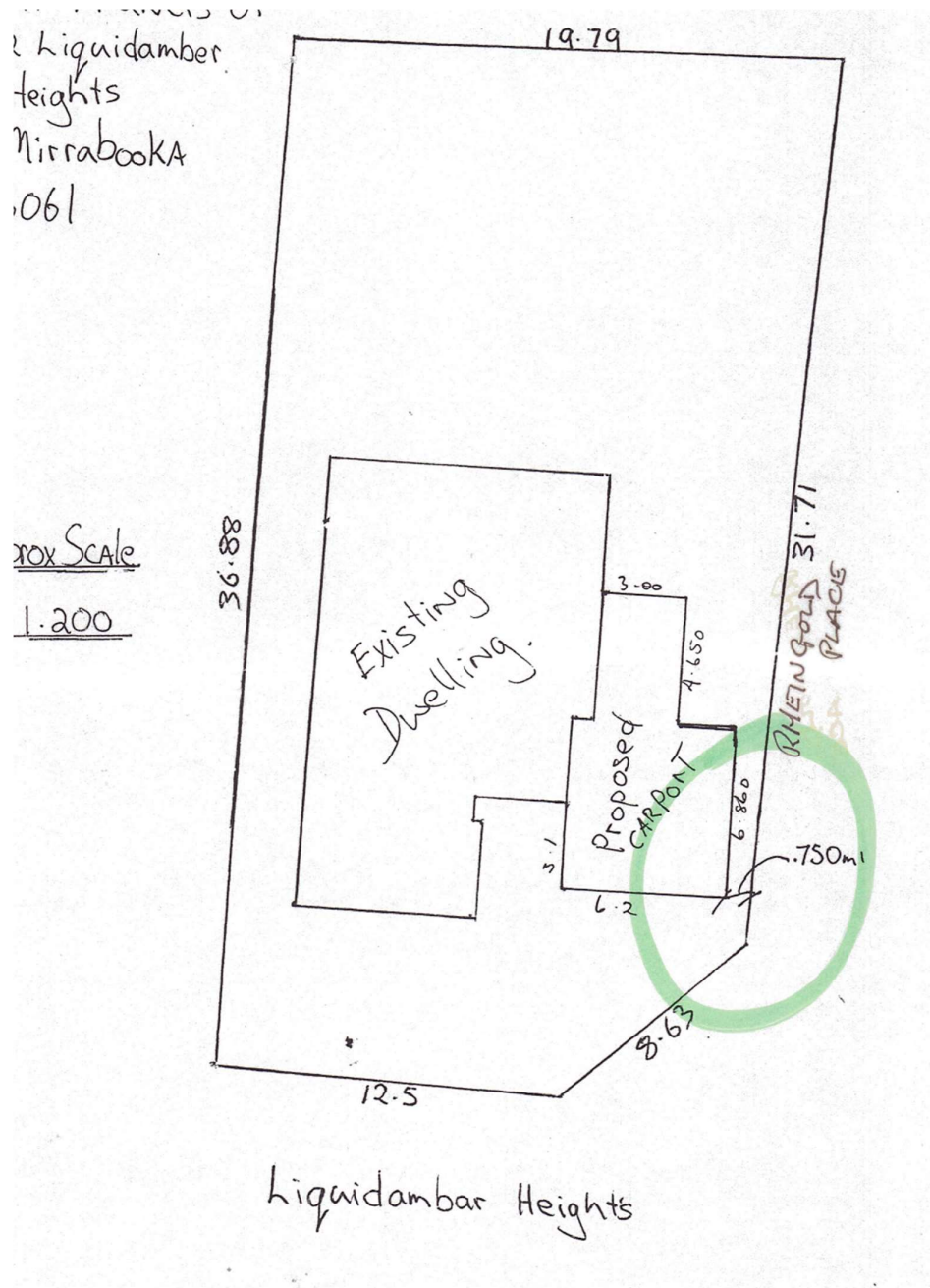

Figure 1 This is the drawing for the existing carport



Figure 2 Existing carport front view



Figure 3: The red-highlighted area of the existing carport is where the garage will be built on.

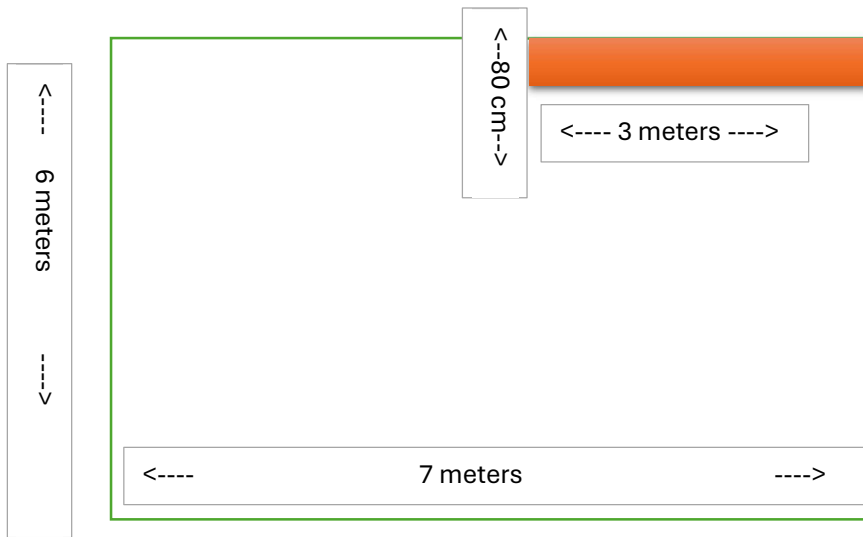

Figure 4 These are the dimensions of the space for the garage

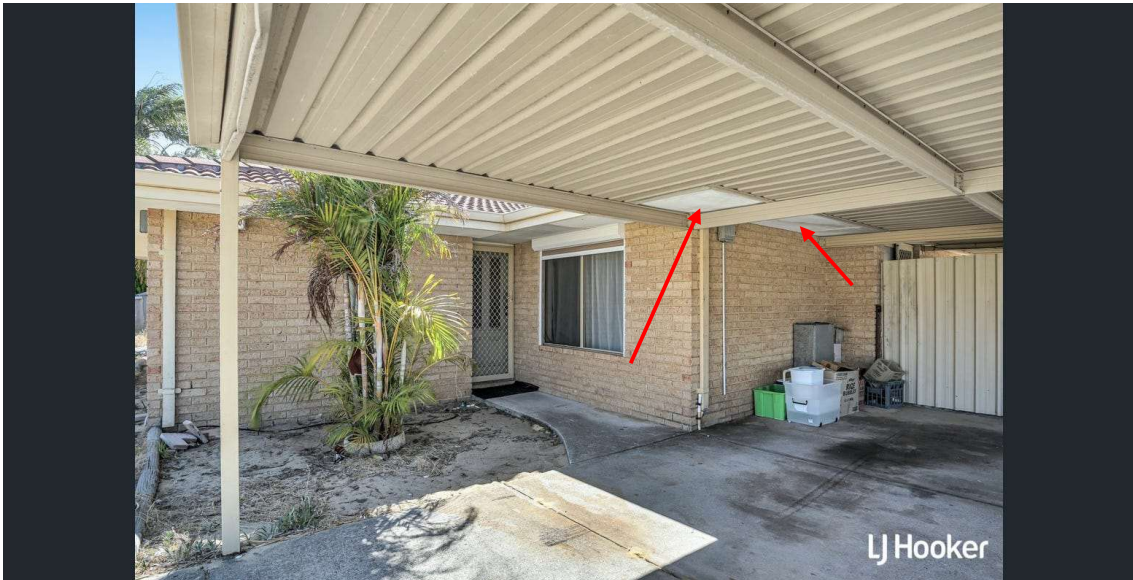

Figure 5 These arrows show where the roof gets on the way of the new design and installation and where some L-shaped structures need to be bolted into the external wall and wrap around the roof and protrude up to be the resting structure for the highest side of the skillion roof.



Figure 6 My suggestion would be to bolt some kind of L shaped metal flush against the external wall and bend it around the gutter and up wards to support the highest side of the skillion slop.

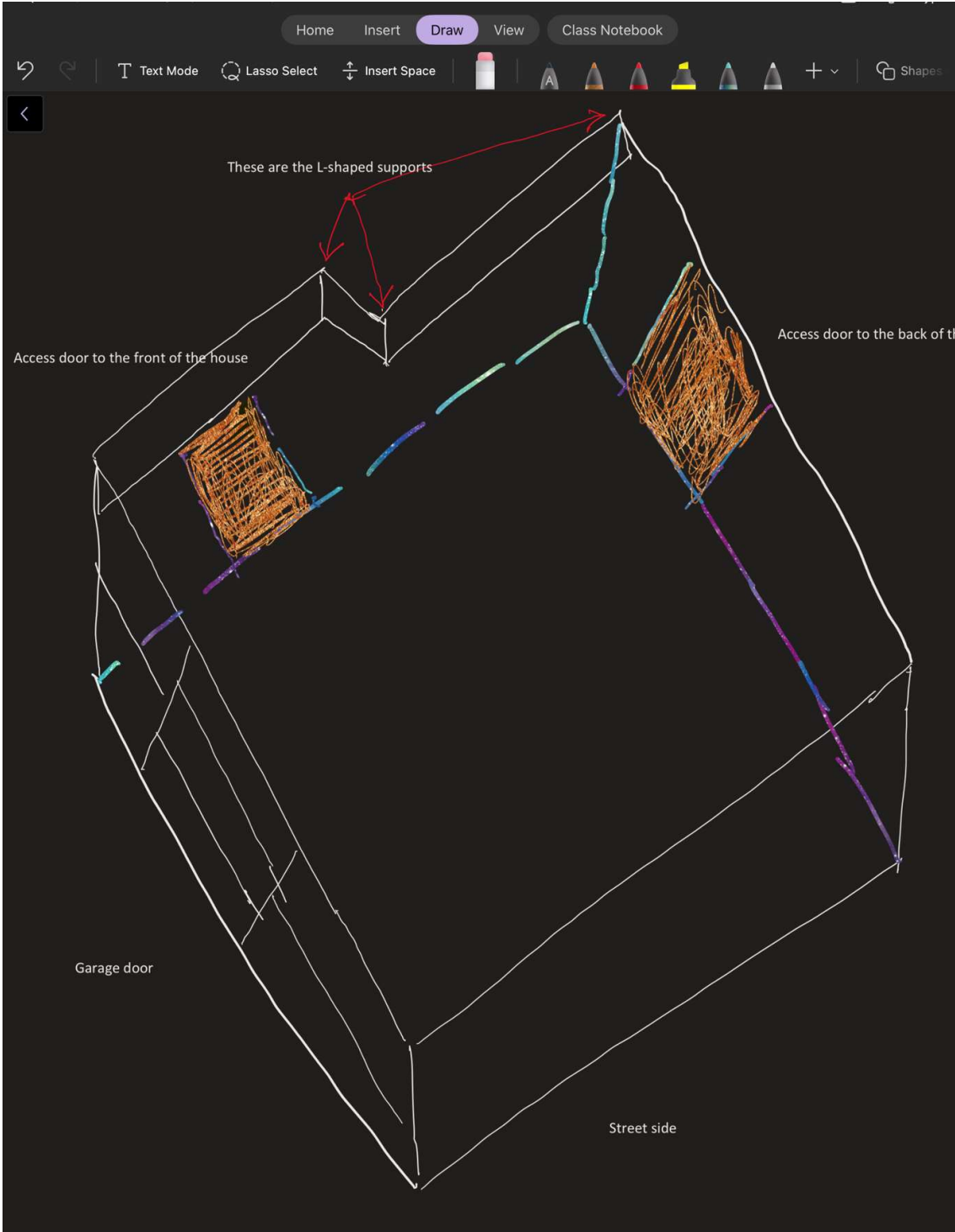

Figure 7: This is what I imagine it to be like - however, I am open to any alternative solutions and designs.