

**Drainage Plan.**



*gutter.*

*down pipe.*

*Stormwater to street*

*downpipe connected to existing stormwater drain.*

Area (estimate only)	
Living	147.2 m <sup>2</sup>
Outdoor Entertaining	45.8 m <sup>2</sup>
Double Carport	37.6 m <sup>2</sup>
Garage / Workshop	19.1 m <sup>2</sup>
Porch	8.6 m <sup>2</sup>
<b>Total</b>	<b>258.3 m<sup>2</sup></b>



For illustrative purposes only.  
All measurements are approximate

**Left Elevation**

**(NORTH ELEVATION)**

Order Reference  
 Sales Person  
 Client Name

Garage  
 Mr Brett Nitschke  
 Joel Shean

Design Number 01086882  
 Date 23/06/2025  
 Site Address 40 Meredith Avenue  
 Glengowrie

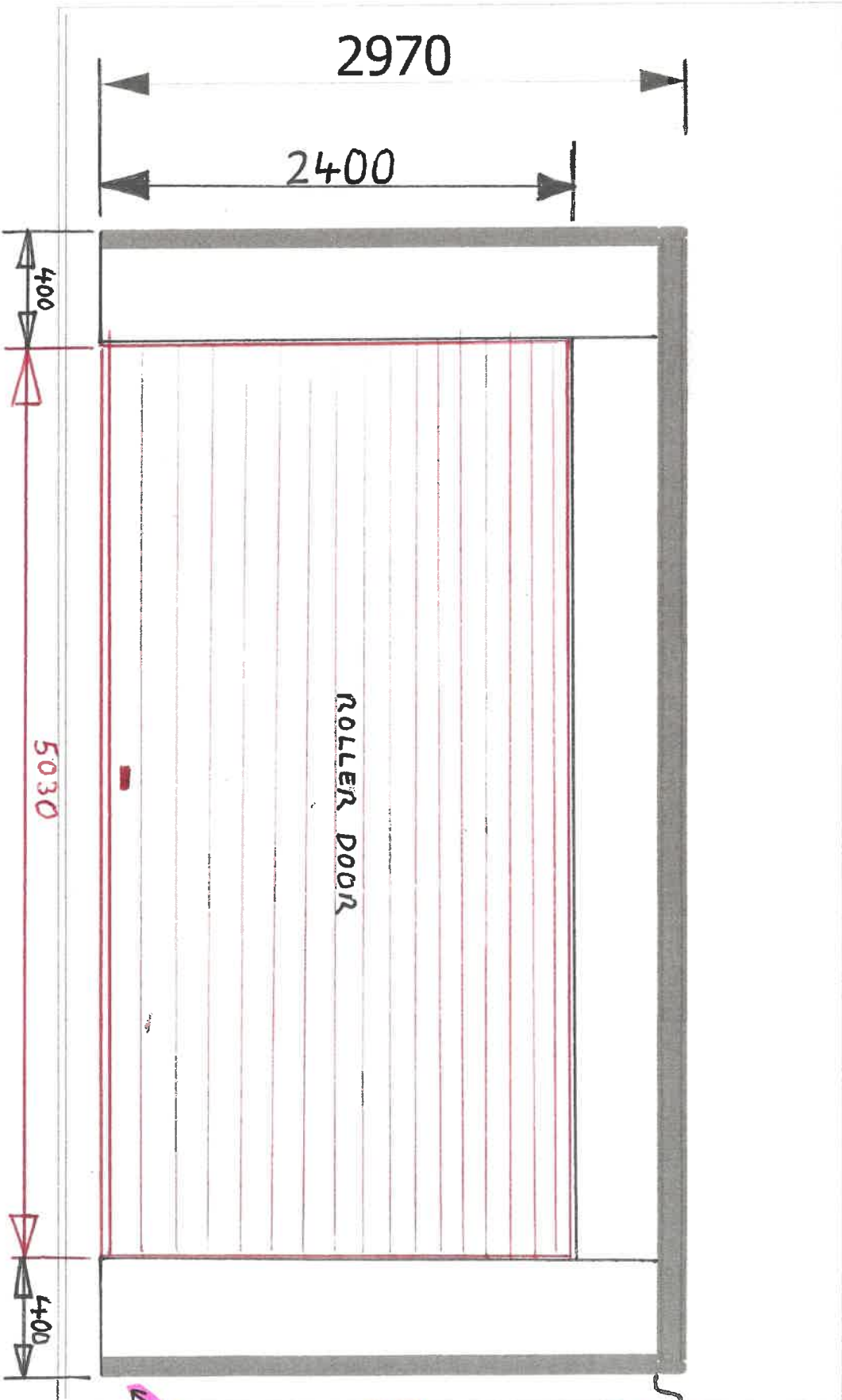

Boundary  
 Gap between gutter & boundary with 25mm  
 Gap between fascia & boundary

DESIGN # 01086882

# How To.



QUEENSLAND  
Tel (07) 3451 4444  
Fax Orders (07) 3451 4545  
NEW SOUTH WALES  
Tel (02) 8811 7200  
Fax Orders (02) 8672 1975  
AUST. CAPITAL TERRITORY  
Tel (02) 6280 5805  
Fax Orders (02) 6280 4551

VICTORIA  
Tel (03) 9409 9200  
Fax Orders 1500 884 1  
SOUTH AUSTRALIA  
Tel (08) 8260 9600  
Fax Orders (08) 8349 71  
WESTERN AUSTRALIA  
Tel (08) 9455 1911  
Fax Orders (08) 9455 2451

NORTHERN TERRITORY  
Tel (08) 8944 2300  
Fax Orders (08) 8947 6293  
ALICE SPRINGS  
Tel (08) 8944 2300  
Fax Orders (08) 8947 6293  
stratco.com.au

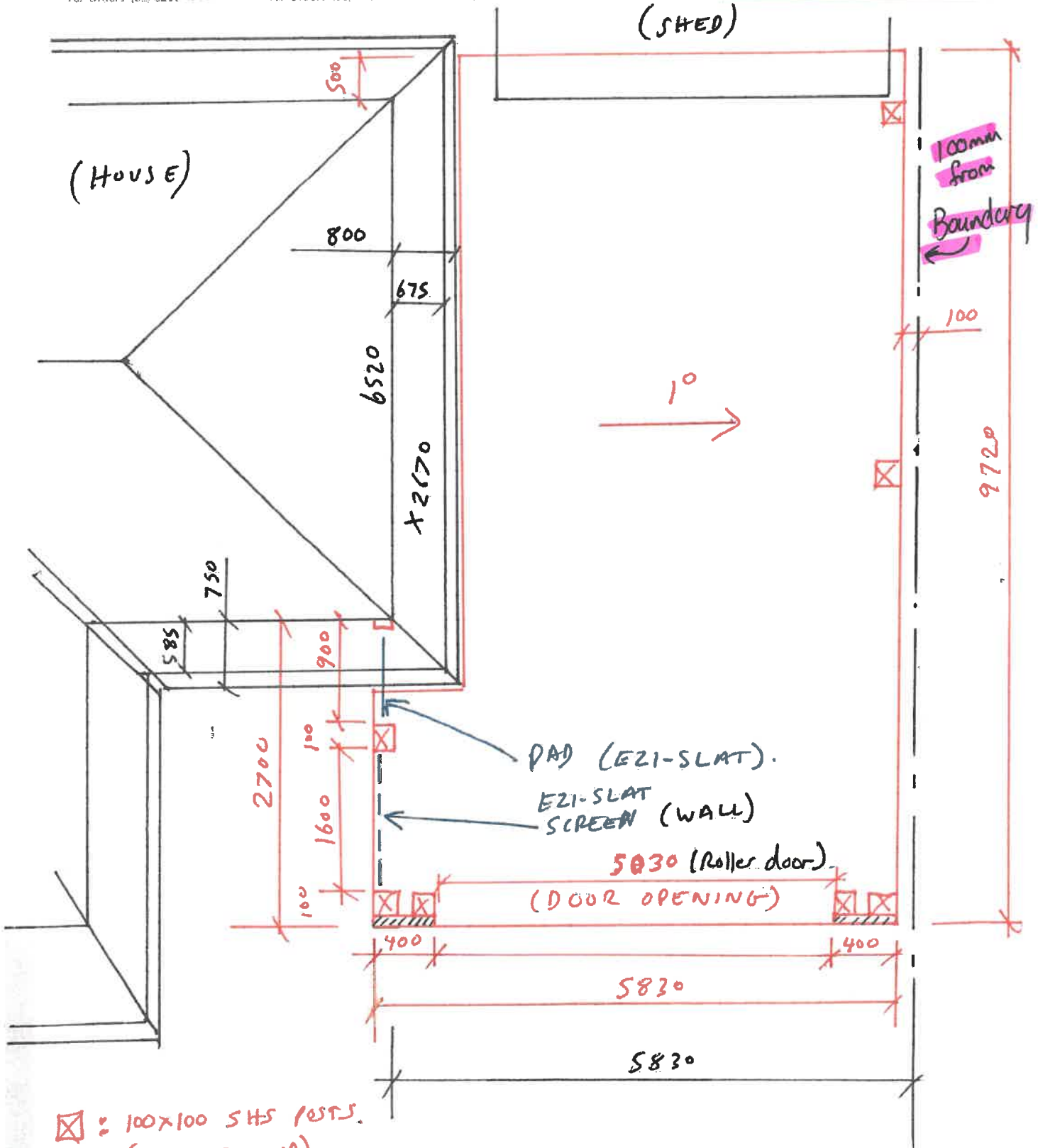

☒ = 100x100 SHS POTS.  
(IN GROUND)

OPTION 2 : ROLLER DOOR.

▨▨▨▨  
Fibre cement wall.

**Column Locations**

Order Reference Garage  
 Sales Person MR Brett Nilschke  
 Client Name Joel Shean

Design Number 01085882  
 Date 23/06/2025  
 Site Address 40 Meredith Avenue  
 Clengowrie

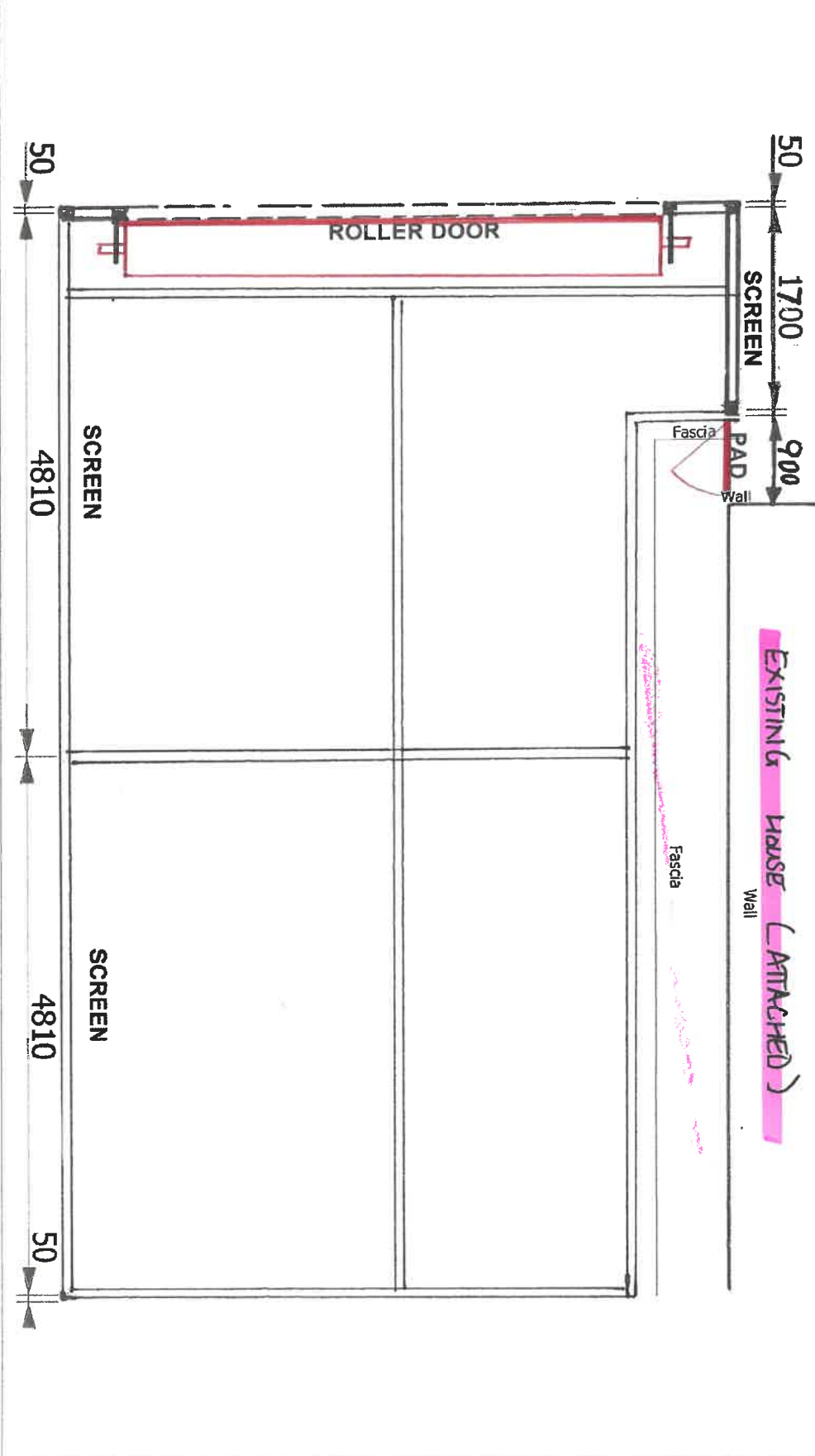

**Plan View**

Order Reference  
 Sales Person  
 Client Name

Garage  
 Mr Brett Mitschke  
 Joel Shean

Design Number  
 Date  
 Site Address

O1086882  
 23/06/2025  
 40 Meredith Avenue  
 Clengowrie

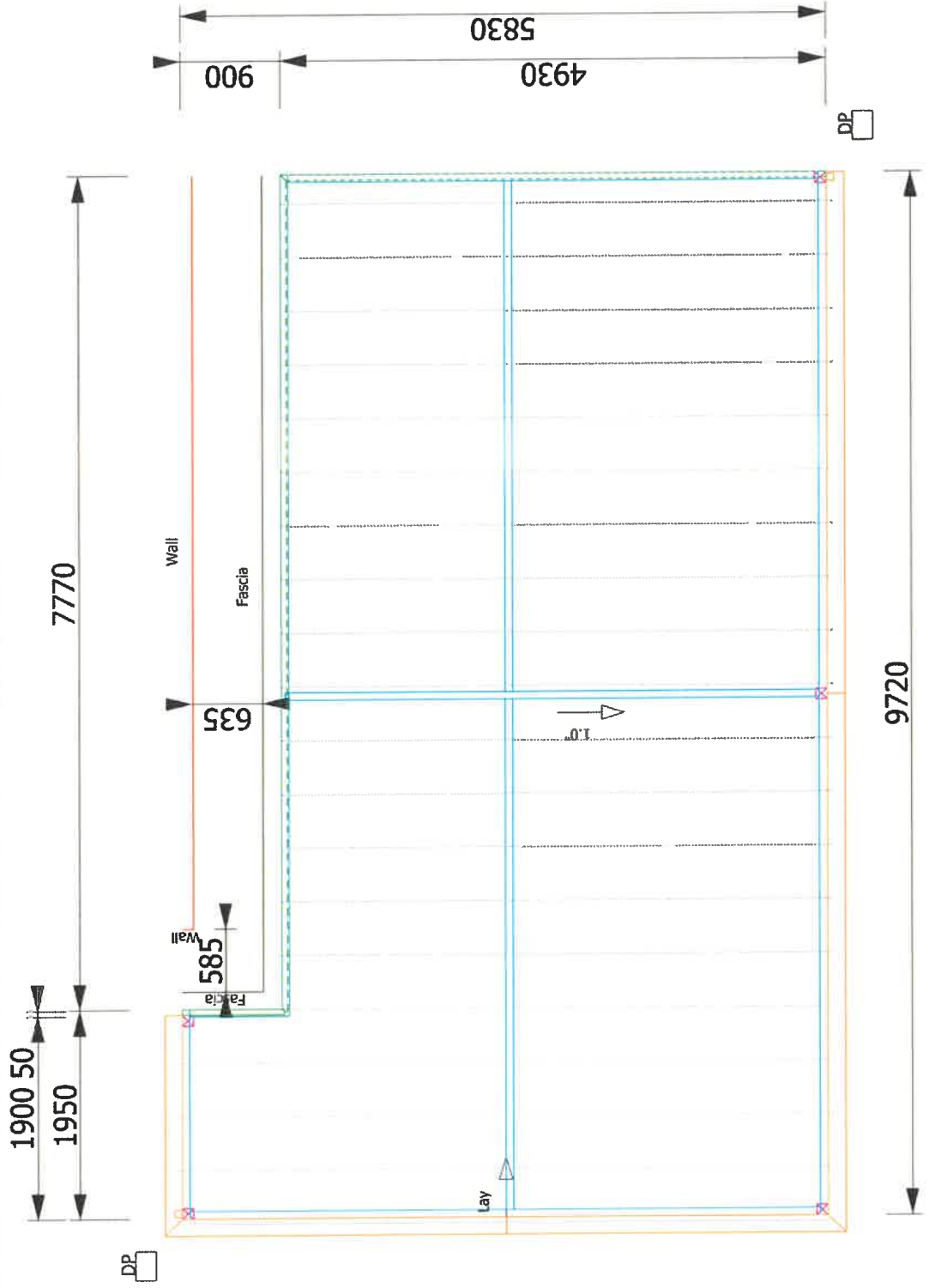

**Column Locations**

Order Reference  
 Sales Person  
 Client Name

Garage  
 Mr Brett Mitschke  
 Joel Shean

Design Number  
 Date  
 Site Address

01086882  
 23/06/2025  
 40 Meredith Avenue  
 Glengowrie

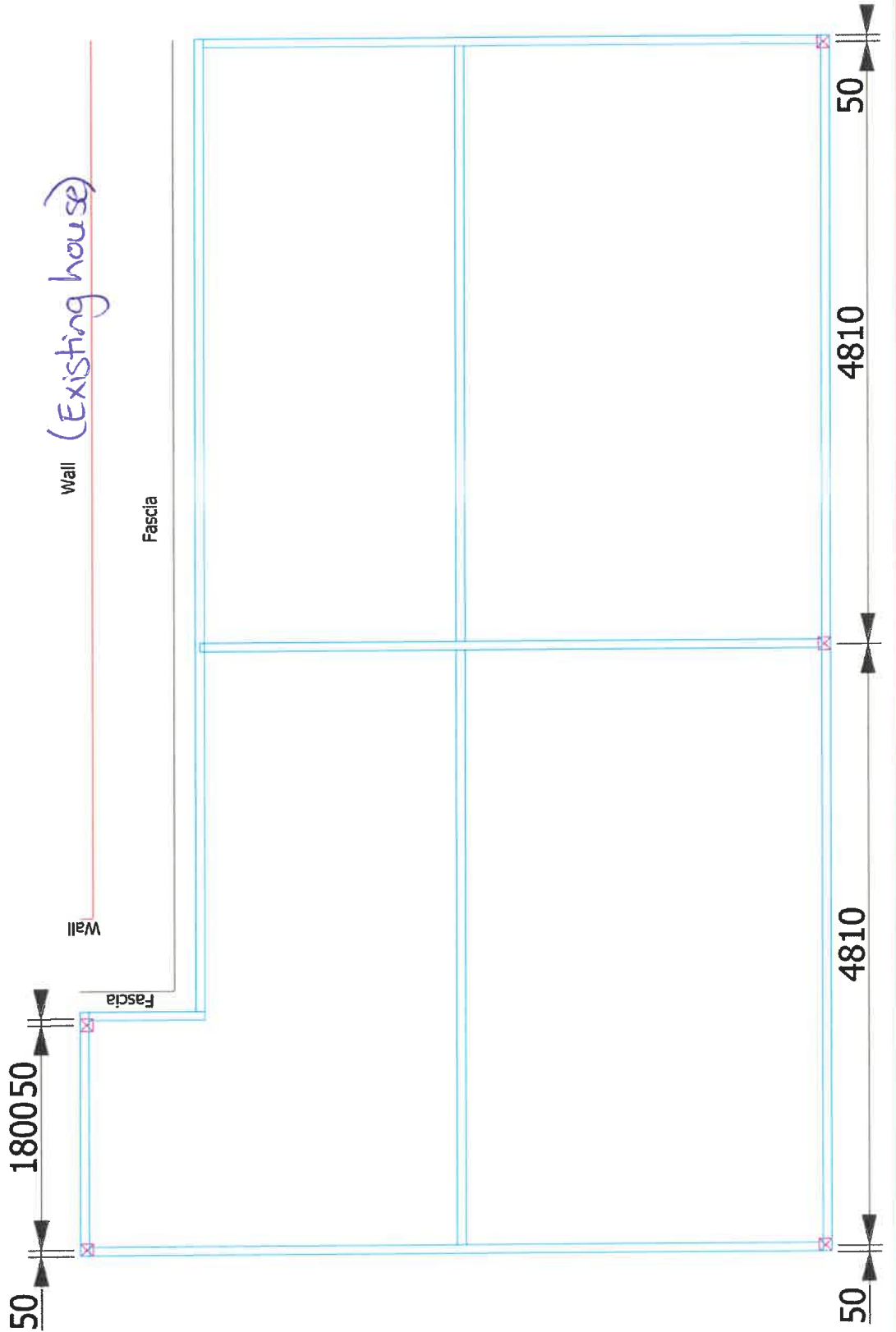

**Attachment Details**

Order Reference: Garage  
 Sales Person: Mr Brett Nitschke  
 Client Name: Joel Shean

Design Number: 01086882  
 Date: 23/06/2025  
 Site Address: 40 Meredith Avenue  
 Clengowrie

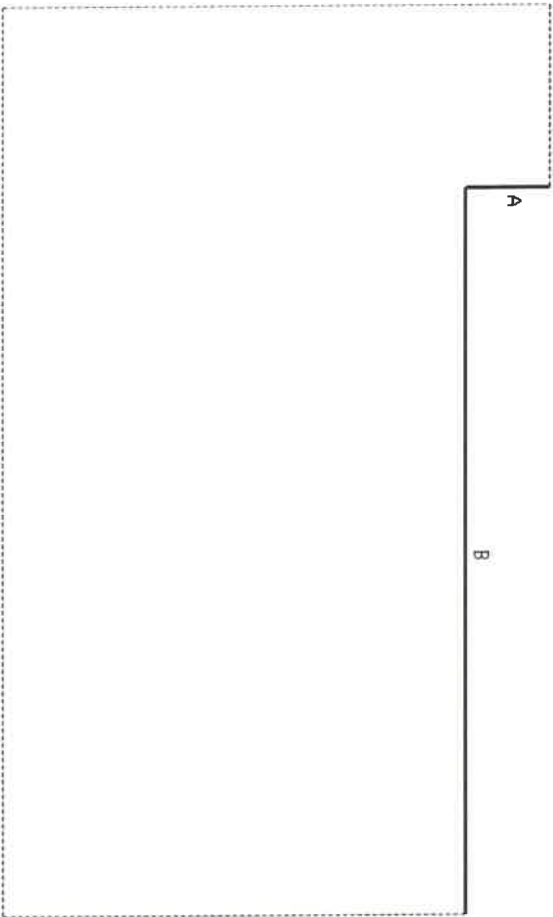

**A - Flat Attached To Fascia Using Attachment Beam**

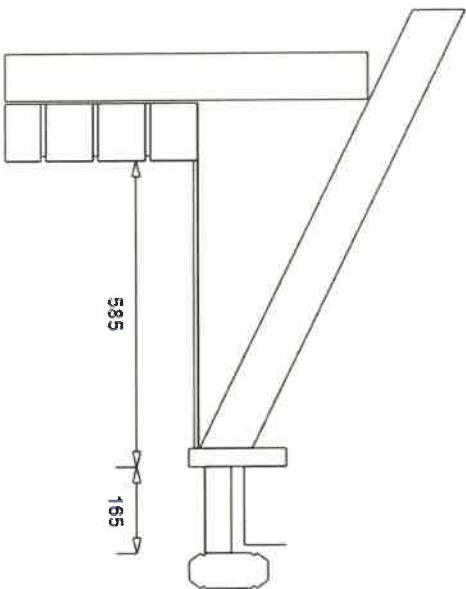

Wall Type: Brick Wall  
 Fascia Type: Flat Timber  
 Fascia Angle: 0°  
 Rafter Type: Timber  
 Roof Pitch: 26.0°  
 Eaves Width: 585mm  
 Has House Gutter: True  
 House Gutter Width: 150mm

**B - Flat Attached To Fascia Using Attachment Beam**

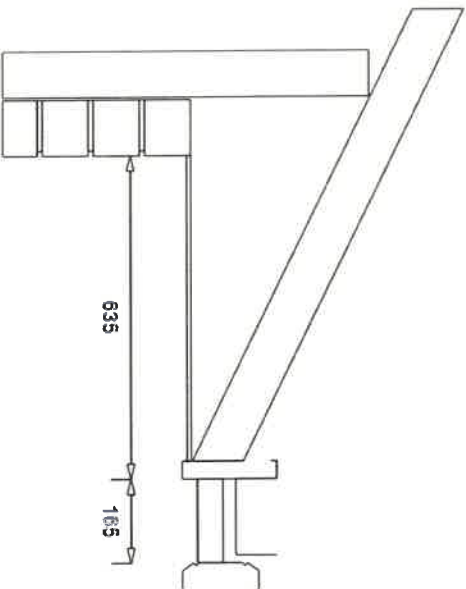

Wall Type: Brick Wall  
 Fascia Type: Flat Steel  
 Fascia Angle: 0°  
 Rafter Type: Timber  
 Roof Pitch: 26.0°  
 Eaves Width: 635mm  
 Has House Gutter: True  
 House Gutter Width: 150mm

**Current View**

Order Reference  
Sales Person  
Client Name

Garage  
Mr Brett Mitschke  
Joel Shean

Design Number  
Date  
Site Address

01086882  
23/06/2025  
40 Meredith Avenue  
Clengowrie

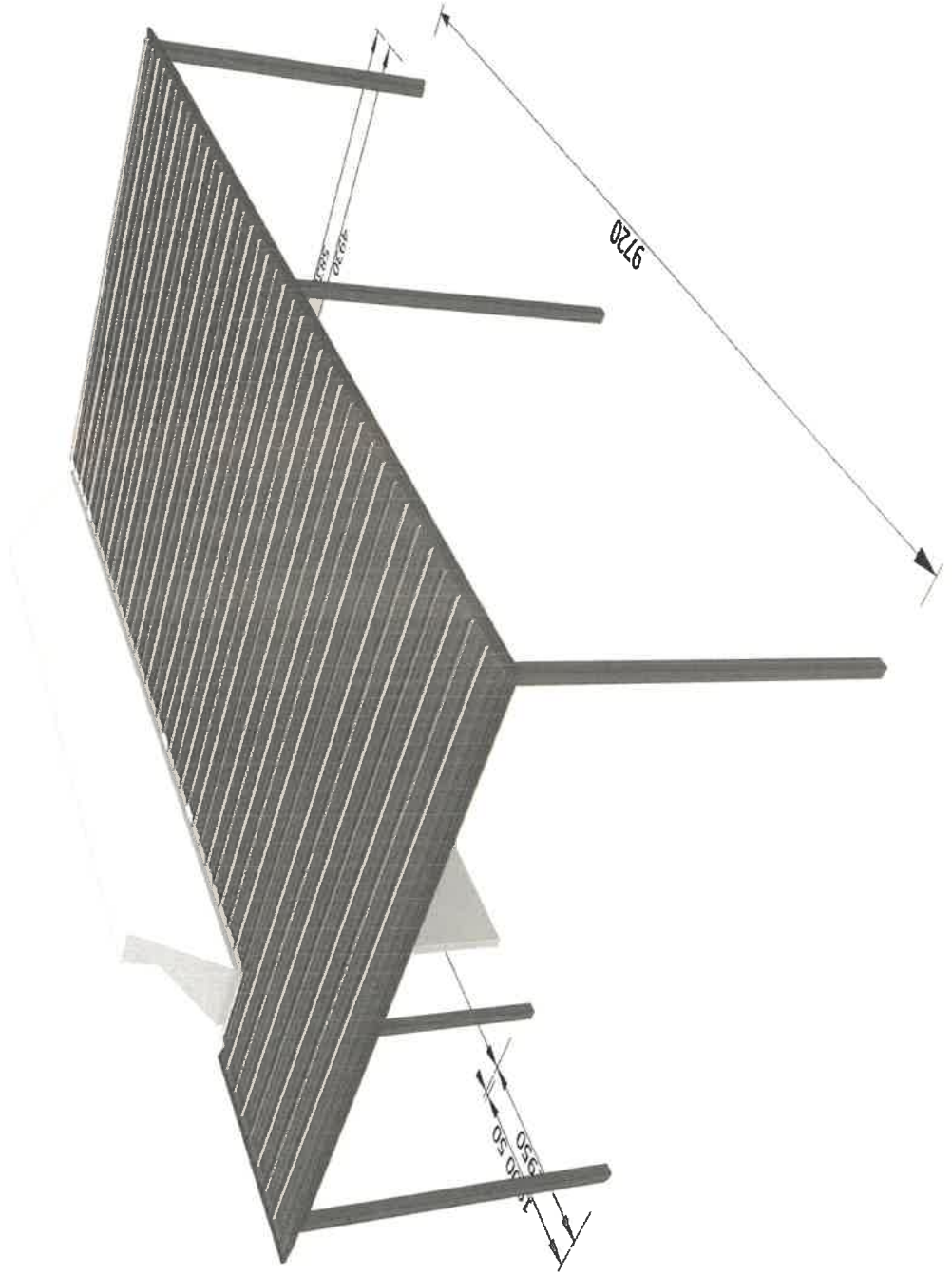

YOU BRING THE DREAM  
WE'LL BRING THE  
How To.

STRATCO  
**OUTBACK**  
VERANDAHS • PATIOS • CARPORTS • SUNROOF

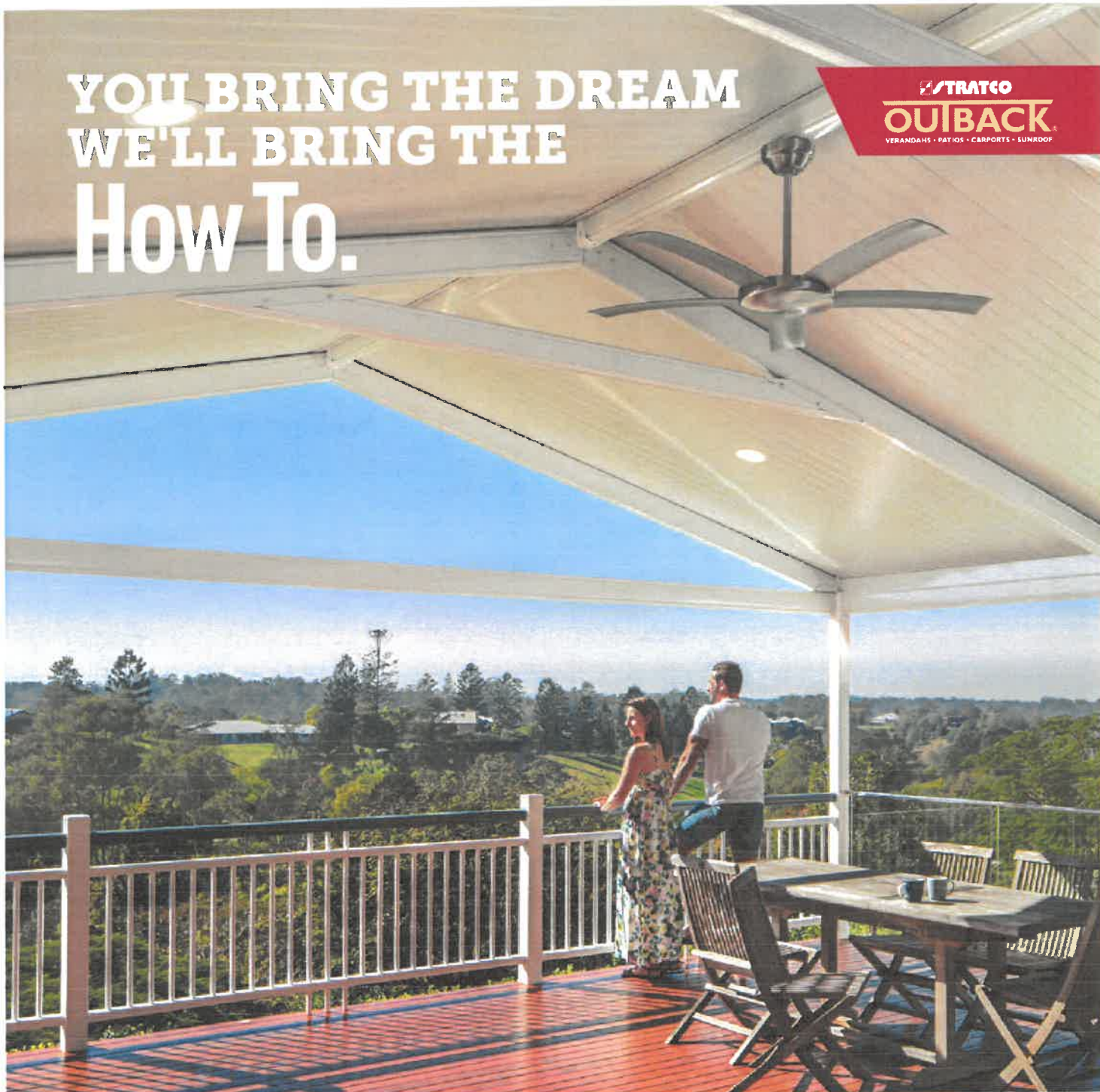

**STRATCO OUTBACK® SPAN TABLES**

VERANDAHS | PATIOS | CARPORTS | SUNROOF

# STRATCO OUTBACK VERANDAHS, PATIOS, CARPORTS & PERGOLAS

Independent Certification

Level 2, 124 South Terrace  
Adelaide SA 5000

GPO Box 2450  
Adelaide SA 5001  
T 61 8 8201 9600  
F 61 8 8201 9650

Fyfe Pty Ltd  
ABN 57 008 116 130  
fyfe.com.au



Our Ref: 50099-3

05 May 2023

Stratco (Australia) Pty. Ltd.,  
P.O. Box 307,  
ENFIELD PLAZA, S.A. 5084

## RE: STRATCO OUTBACK®

We, FYFE Pty. Ltd., practising structural engineers, confirm that we have checked the designs prepared by Stratco (Australia) Pty. Ltd., for the Outback® Verandahs, Patios, Carports & Sunroofs, as detailed in the following document;

### STRATCO OUTBACK® SPAN TABLES – VERANDAHS | PATIOS | CARPORTS | SUNROOF (© May 2023)

We hereby certify that the calculations, materials, forms of construction and systems to which the designs relate will, if installed in accordance with the designs, conform to the structural requirements of the NCC 2022 Building Code of Australia Volume Two – Building Code of Australia Section H, Part H1, and the following Australian Standards:-

- AS/NZS 1170.0:2002 – Structural Design Actions - Part 0: General Principles
- AS/NZS 1170.1:2002 – Structural Design Actions - Part 1: Permanent, imposed and other actions
- AS/NZS 1170.2:2021 – Structural Design Actions - Part 2: Wind actions
- AS/NZS 4600:2018 – Cold-formed steel structures
- AS 1562.1:2018 – Design and installation of sheet roof and wall cladding
- AS 3600:2018 – Concrete structures
- AS 4100:2020 – Steel structures

In the preparation of this certification, we have relied on the load test reports, product data sheets and specifications provided by Stratco (Australia) Pty. Ltd., and other relevant proprietary product specifications.

**Trevor John Fife** Aust CPEng NER APEC Engineer

Principal Structural Engineer

- NER 106278
- QLD Reg. No. 3664
- NT Reg. No. 12178ES
- VIC Reg. No. PE0000400
- TAS Reg. No. CC-4375F

STRATCO OUTBACK® CERTIFICATION 20230505.DOC4

VALUE THROUGH INTEGRATION

# STRATCO OUTBACK VERANDAHS, PATIOS, CARPORTS & PERGOLAS

## General Notes

1. These tables have been prepared for a range of attached and freestanding verandah, patio, pergola, sunroof and carport designs using structural sections and roof sheeting manufactured by the Stratco Group of Companies throughout Australia.
2. The structural components used comply with the following Australian Standards:
  - Beam and Column sections are cold-rolled from hi-tensile steel, conforming to AS1397.
  - Hot rolled plate conforms to AS/NZS1594 and AS/NZS3678.
  - Roof sheeting complies with AS1397 - Steel Sheet Strip.
  - Bolts comply with AS/NZS2451, AS1110.1 and AS1111.1.
  - Self drilling screws comply with AS3566.1.
  - All other proprietary products to be in accordance with the manufacturer's recommendations.
3. The testing and design of structural members comply with the following Australian standards:
  - Structural Design Actions, AS/NZS 1170.0:2002 - General Principles
  - Structural Design Actions, AS/NZS1170.1:2002 - Permanent, Imposed and Other Actions
  - Structural Design Actions, AS/NZS1170.2:2021 - Wind Actions
  - Wind Loads for Housing, AS4055 - 2021.
  - Cold Formed Steel Structures, AS/NZS4600 - 2018.
  - Steel Structures, AS4100 - 2020.
  - Concrete Structures, AS3600 - 2018.
  - Design and Installation of Sheet Roof and Wall Cladding, AS1562.1 - 2018.
4. All erection and connection details to be in accordance with the relevant standard Stratco connection details contained in these span tables.
5. Maximum height shall be 3.0 metres for Outback units unless indicated otherwise, with some units restricted in height for better performance. Refer to the relevant section for further details on allowable unit heights.
6. Recommended minimum roof pitch for "flat" verandahs shall be 1° (1 in 60) for deck spans up to 4000mm and 1.5° (1 in 40) for deck spans exceeding 4000mm. Maximum roof pitch for "flat" verandahs shall be 5° (1 in 12). Recommended minimum roof pitch for corrugated steel sheet shall be 5° (1 in 12). Minimum louvre pitch for Outback Sunroof units shall be 1° (1 in 60)\*. Care must be taken to ensure the minimum roof pitch is maintained to avoid ponding of rainwater. Minimum fall of units towards downpipes is 1 in 200.  
\* Minimum roof pitch shall be 1° for Cooldek Classic and 3° for Cooldek CGI.
7. Unless indicated otherwise footing sizes nominated in the span tables have been determined assuming they are founded into a firm natural sandy clay. Concrete to have a minimum strength of 15MPa with a maximum 80mm slump.
8. Where the Verandah, Patio, Carport or Pergola columns are to be fixed to an existing ground slab the erector / owner is responsible for ensuring that the slab is capable of supporting the structure.
9. Verandahs, Patios and Carport Span Tables are generally not sufficient to provide for enclosures, except for screen enclosures that allow for air movement. A Verandah, Patio or Carport is defined as a structure that has two or more sides that are open and at least one third of its perimeter is open. For a side to be considered open, the roof cladding adjacent to that side must be at least 500mm from another building or allotment boundary.
10. The builder is to ensure that the structure to which the Verandah, Patio or Carport is to be attached is capable of withstanding the additional loads imposed by the Verandah, Patio or Carport or adequately reinforced. It is advisable to first check with a structural engineer or your local government authority to determine any specific requirements for attachment to existing buildings.
11. The roof cladding and supporting structural members are designed to withstand actions incidental to maintenance, roofs are not to be used for floor type activities.

# STRATCO OUTBACK VERANDAHS, PATIOS, CARPORTS & PERGOLAS

**General Notes**

12. Stratco recommends that crawl boards be used across the roof sheeting during installation or maintenance to prevent damage to the roofing. Temporary support of beams at mid span is recommended during fixing of roof sheets.
13. Outback Sunroof units have been designed as non-trafficable and at no stage should be walked on.
14. Generally, structural members have an allowable dead load deflection of span/150, however this has been restricted to a maximum of 25mm for aesthetic and practical purposes.
15. A Flat Verandah, Patio, Carport or Pergola is deemed to be freestanding unless it is attached to an existing house for at least 75% of the length of its shortest side, and its longest side does not exceed twice the length of its shortest side. A Sunroof Verandah, Patio or Carport is deemed to be freestanding unless it is attached to an existing house for at least 75% of the rear attachment beam, unless indicated otherwise. Refer to the explanatory notes in the relevant section for better explanation and further attachment details.
16. The designs contained within these span tables have been developed to the requirements of AS/NZS 1170.2, and have been presented using the AS4055 equivalent wind classifications N1, N2, N3, N4, C1, C2 and C3 applicable to Regions A, B & C. In some cases tables are restricted to N1, N2 and N3. Stratco does not accept liability for any loss or damage suffered as a result of any errors in the interpretation or application of these span tables.
17. The Stratco Outback has been designed as a complete system. Only Stratco Outback components may be used. Any guarantee provided by Stratco will only apply if all components have been supplied by Stratco, and installed in accordance with Stratco details.
18. This booklet is produced in the interest of customer education and good consumer relations and should be read in conjunction with the Stratco Selection, Use and Maintenance brochure. Users should satisfy themselves that they are using the correct materials, approach and techniques. Correct maintenance is considered an essential part of maintaining structural integrity of Stratco Verandah, Patio & Carport products.
19. Stratco takes no responsibility for any misinterpretation of the detail provided or omissions. These tables are subject to change without notice. Users should satisfy themselves they are using the most up to date information available.
20. Alternative columns to those specified in the Span Table Book may be used in accordance with the following table:

Column Specified	Optional Replacement*
Outback Column (68x68x0.6mm BMT)	65x65x2.5mm SHS
Outback Column reinforced with 50x50x1.6mm SHS	75x75x2.5mm SHS
Outback Column reinforced with 50x50x3.0mm SHS	90x90x2.0mm SHS
65x65x2.5mm SHS	100x100x2.5mm SHS
	100x100x3.0mm SHS
75x75x2.5mm SHS	100x100x2.5mm SHS
75x75x3.0mm SHS	100x100x3.0mm SHS
90x90x2.0mm SHS	

\* Any replacement column listed may be used for the column specified.  
All SHS specified shall be minimum C350 grade and only specified SHS connections apply.



Windspeed N1

PLEASE CHECK THAT ALL ORDER DETAILS ARE CORRECT.  
YOUR ORDER IS NOW BEING PROCESSED BASED ON THE FOLLOWING DETAILS.



**JOB DETAILS**

ORDER REFERENCE: Garage  
DESIGN NUMBER: O1086882  
SALES PERSON: Mr Brett Nitschke

**CUSTOMER DETAILS**

CLIENT NAME: Joel Shean  
PHONE NUMBER: 0409 555 751  
ACCOUNT CODE: CRUICONS

**DELIVERY DETAILS**

DELIVERY INSTRUCTIONS: 40 Meredith Avenue  
Glengowrie

ADDITIONAL INSTRUCTIONS: 5044

**Unit**

Design Type Flat Attached Type 4A

**Dimensions**

Deck Overhang 0  
Height Rear 2970mm  
Length 9720mm  
Width 5830mm

**Site Details**

WindSpeed N1

**Engineering**

Column Spacing 6243mm

**Components**

140 Column Wraps No  
Back Channel Details Standard Back Channel  
Beam Type 150 Outback Beam  
Beams Bolt Through Columns No  
Column Size 100x100x3.0 SHS  
Downpipe Type Downpipe 75mm PVC  
Gutter Type Outback Edge 160 Gutter

**Roof Details**

Deck Type Outback Deck  
Number of Rooflites 0

**Colours**

Column Colour Gun Metal Grey  
Downpipe Colour Gun Metal Grey  
External Beam Colour Thunder™  
Gutter Colour Gun Metal Grey  
Internal Beam Colour Thunder™  
Roof Colour Gun Metal Grey (Top), Alpine (Ceiling)

**Footing Details**

Footing Size 300x300x500, 60mm corbel  
Footing Type In Ground

**Reinforcement Components**

Adjustable Rafter Strengthening Bracket 7  
Reinforcing Channel 14

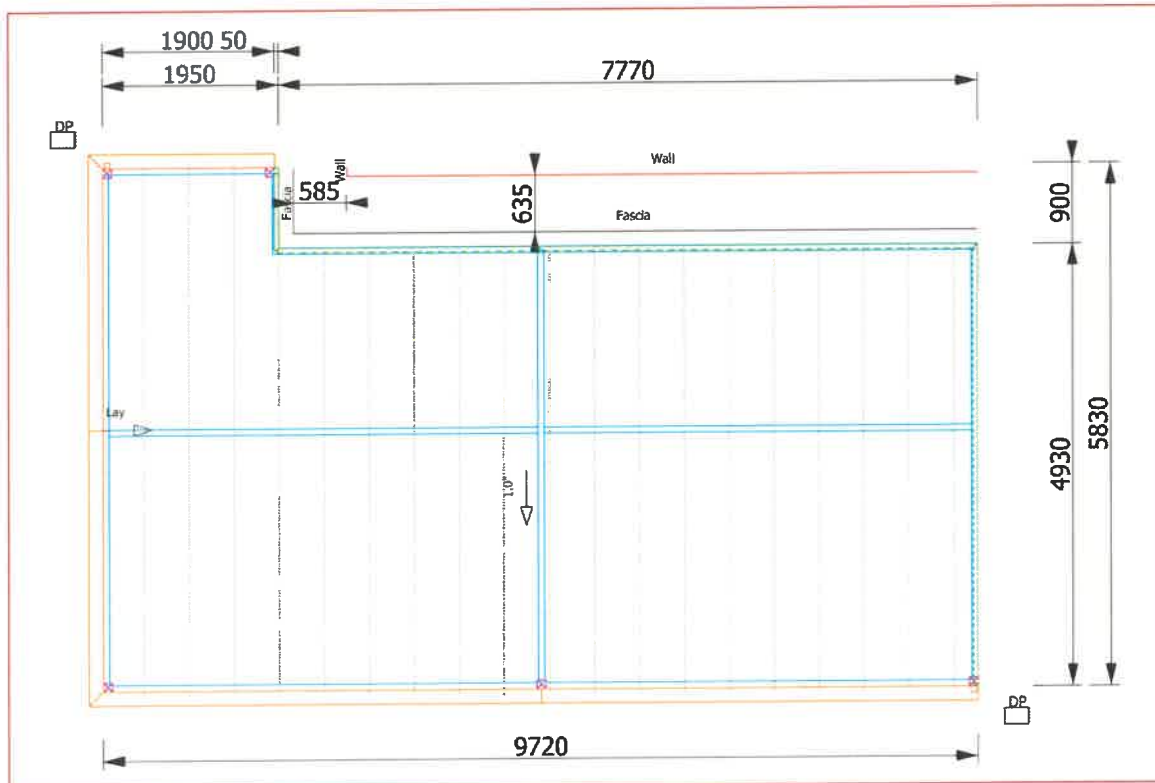

CUSTOMER SIGNATURE:

DATE: 23/06/2025

# STRATCO OUTBACK VERANDAHS, PATIOS, CARPORTS & PERGOLAS

## Wind Factor Checklist

### Design Gust Wind Speed

To identify a Wind Classification for a proposed domestic site there are four variables you must first identify. They are Region (figure 1), Terrain Category, Shielding Factor and Topographic Classification. The Wind Classification can then be determined using table 2.

The appropriate verandah, patio or carport design can now be selected from span tables.

\*This is an approximate method for estimating wind speeds based on an annual probability of exceedance of 1/500 and a maximum height of 5 metres. For full analysis refer to Australian Standards AS/NZS1170.2:2021.

Table 1  
Region A & B: Non-Cyclonic, Region C: Cyclonic

Region	Terrain Category	DESIGN GUST WIND SPEED											
		TOPOGRAPHIC CLASSIFICATION											
		T0			T1			T2			T3		
		F5	PS	NS	F5	PS	NS	F5	PS	NS	PS	NS	
A0	ALL	N1	N2	N2	N2	N3	N3	N2	N3	N3	N3	N4	N4
	1	N2	N3	N3	N3	N3	N3	N3	N4	N4	N4	N4	N4
	2	N1	N2	N2	N2	N3	N3	N2	N3	N3	N3	N3	N4
A1-A5	2.5	N1	N2	N2	N2	N3	N3	N2	N3	N3	N3	N3	N3
	3	N1	N1	N2	N1	N2	N2	N2	N3	N3	N3	N3	N3
	1	N3	N4	N4	N4	N4	N5	N4	N5	N5	N5	N5	N5
B1/B2	2	N3	N3	N3	N3	N4	N4	N4	N4	N4	N4	N4	N5
	2.5	N3	N3	N3	N3	N4	N4	N3	N4	N4	N4	N4	N5
	3	N2	N3	N3	N3	N3	N3	N3	N4	N4	N4	N4	N4
C	1	C2	C3	C3	C3	C3	C4	C3	C4	C4	C4	C4	C4
	2	C2	C2	C2	C2	C3	C3	C3	C3	C3	C3	C3	C4
	2.5	C1	C2	C2	C2	C2	C3	C2	C3	C3	C3	C3	C4
	3	C1	C2	C2	C2	C2	C2	C2	C3	C3	C3	C3	C3

### Shielding Factor

Immediate Modifying Influence



### Terrain Category

Overall Surrounding Environment

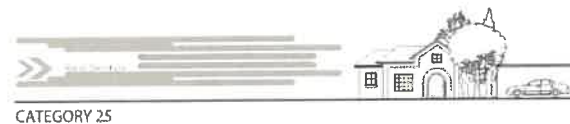

### Region

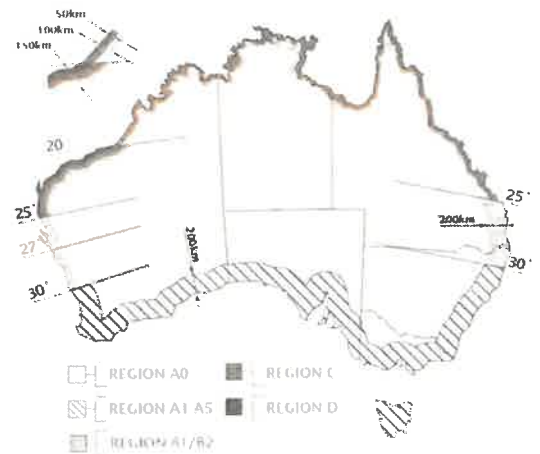

### Topographic Effect

Ground Slope Influence

#### MAXIMUM SLOPE

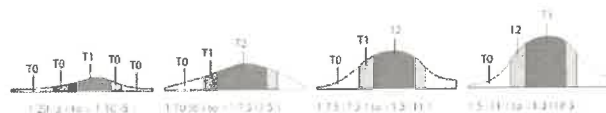

#### ESCARPMENT WIND DIRECTION

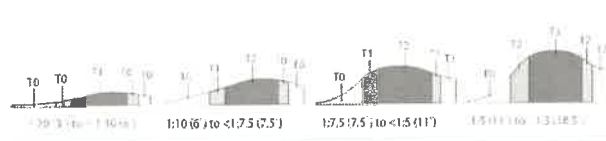

Note: Diagrams suitable for hill or escarpment heights not exceeding 30m.

# STRATCO OUTBACK VERANDAHS, PATIOS, CARPORTS & PERGOLAS

## Explanation of Terms used in "Wind Factor Checklist"

### Terrain Categories

The wind speed at a structure is influenced by the terrain it flows over as it approaches the structure. The terrain category classifications can be described as follows:

#### Category 1

Exposed open terrain with few or no obstructions and enclosed water surfaces. For example, flat, treeless, poorly grassed plains; rivers, canals and lakes; and enclosed bays less than 10km in the wind direction.

#### Category 2

Open terrain, including grassland, with well scattered obstructions having heights typically from 1.5-5m with no more than two obstructions per hectare.

#### Category 2.5

Terrain with a few trees or isolated obstructions, for example terrain in developing outer urban areas with scattered houses.

#### Category 3

Terrain with numerous closely spaced obstructions with heights typically between 3-10m, for example suburban housing.

### Shielding Classification

Shielding classification is required because the wind speed at a structure is influenced by any upwind obstructions of similar size to the structure that are close to the building. In region C and D, trees and vegetation shall not be considered as shielding elements. The three shielding classifications are defined as follows:

#### FS - Represents Full Shielding

Full Shielding is where at least two rows of houses or similar sized permanent obstructions surround the building being considered. In regions A and B, heavily vegetated areas within 100m of the site can provide Full Shielding. The application of Full Shielding is considered appropriate for typical suburban development, equal to or greater than 10 houses and/or similar sized obstructions per hectare.

#### PS - Represents Partial Shielding

Partial Shielding applies to intermediate situations where there are at least 2.5 houses or sheds per hectare upwind of the structure. e.g. Typical "acreage" type suburban development or wooded parklands. The second row of houses abutting open water or parklands may be classified as having partial shielding.

#### NS - Represents No Shielding

No Shielding occurs where there are no (or less than 2.5 obstructions per hectare) permanent obstructions upwind. e.g. The first row of houses or single houses abutting open water, airfields and open parklands.

### Topographic Effect

The topographic classification determines the effect of wind on a structure due to its location on a hill, ridge or escarpment and the height and slope of the hill, ridge or escarpment.

The bottom of a hill, ridge or escarpment is the area at the base of which the average ground slope is less than 1 in 20 or approximately 3°. The maximum slope of a hill, ridge or escarpment (regardless of structure site) is measured as the steepest slope through the top half of the hill, ridge or escarpment. With the maximum slope known, the topographic effect diagrams may be used to determine the topographic classification based on which third of the hill or escarpment the site is located.

In areas where the maximum slope does not exceed 1 in 20 (approximately 3°) the topographic classification shall be T0.

### Note

The method used for calculating the design gust wind speeds has been developed by Stratco with the assistance of suitably qualified engineers in order to comply with the requirements of AS/NZS1170.2:2021 and classified in accordance with the wind classifications allocated in AS4055:2021.

Stratco does not accept liability for any loss or damage suffered as a result of any errors in the interpretation or application of this design guide. Any person wishing to check any calculations made by them pursuant to this method may wish to seek independent engineering advice.

# STRATCO OUTBACK VERANDAHS, PATIOS, CARPORTS & PERGOLAS

## Examples of Wind Speed Application

The examples below show typical applications of the rationalised gust wind speeds. For full analysis refer to AS/NZS 1170.2 : 2021.

Region A W28/N1, Region B W33/N2 & Region C W41/C1

Flat Suburbia

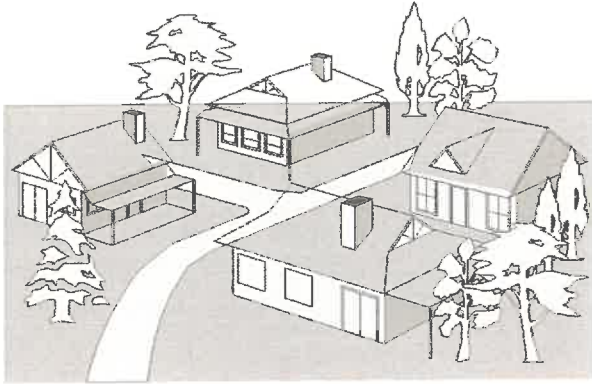

Region A W33/N2, Region B W41/N3 & Region C W50/C2

Structures built adjacent to an oval or large vacant lot subject to prevailing winds.

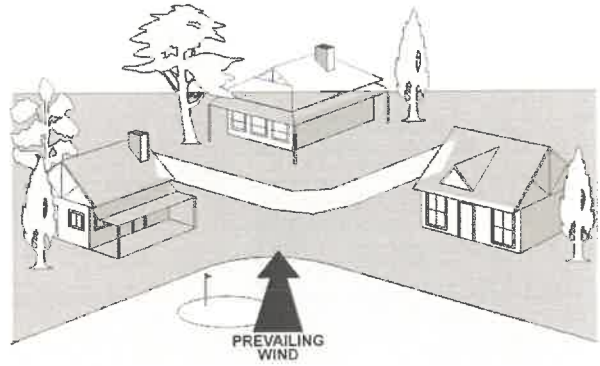

Region A W33/N2, Region B W41/N3 & Region C W50/C2

Structures on undulating terrain in suburbia

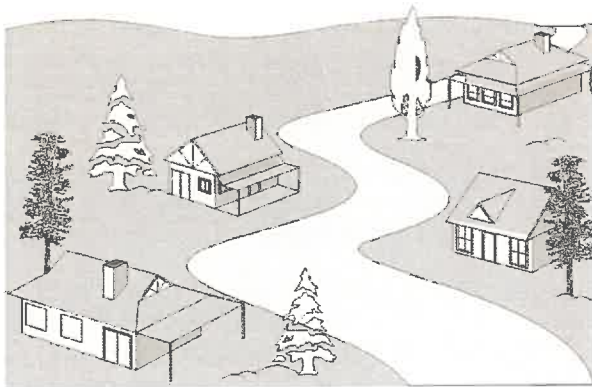

Region A W41/N3, Region B W50/N4 & Region C W60/C3

Structure sited in undulating terrain sparsely populated

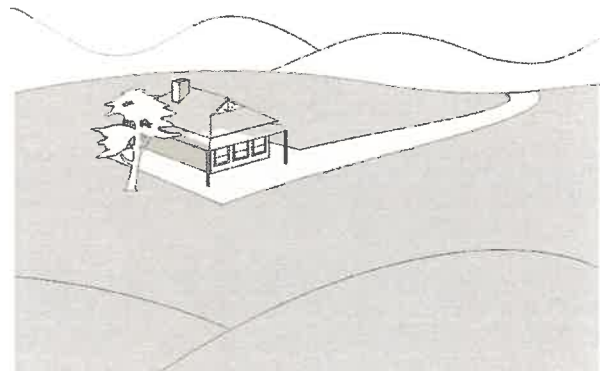

Region A W41/N3, Region B W50/N4 & Region C W60/C3

The first row of buildings adjacent to the sea front

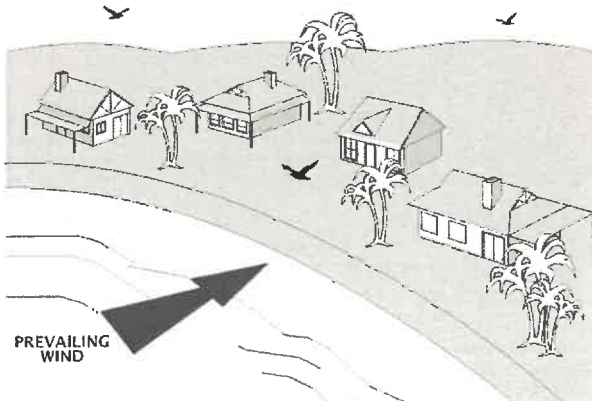

Region A W50/N4

Extremely severe  
Isolated building on the crest of a hill

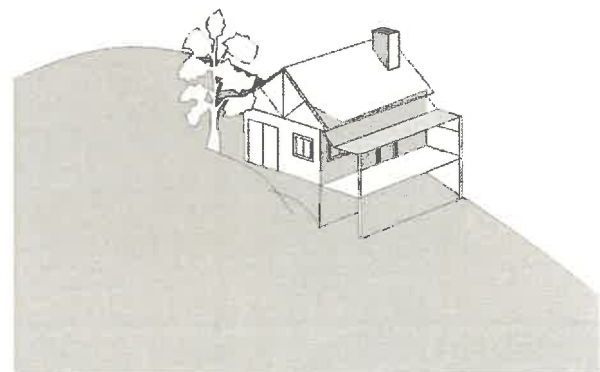

# SPAN TABLES FOR ATTACHED OUTBACK FLAT VERANDAHS, PATIOS & CARPORTS

Wind Classifications: N1, N2, N3, N4, C1, C2 & C3

Regions: A, B & C

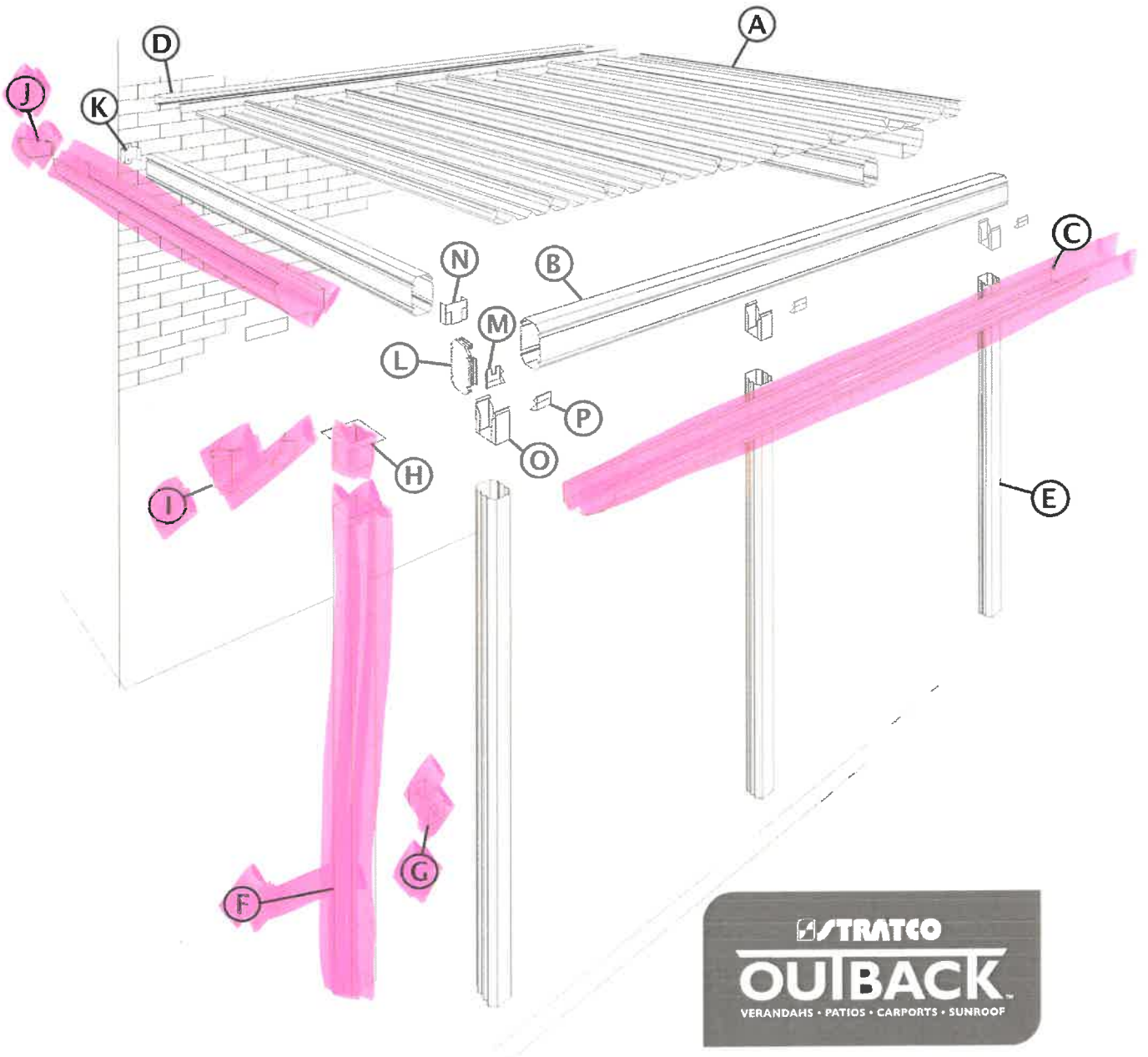

- |                           |                     |
|---------------------------|---------------------|
| (A) Roofing               | (I) Gutter Mitre    |
| (B) Beams                 | (J) Gutter Stop End |
| (C) Gutter                | (K) Wall Bracket    |
| (D) Back Channel & B.I.P. | (L) Beam End Cap    |
| (E) Columns               | (M) Beam Filler     |
| (F) Downpipe              | (N) Beam Bracket    |
| (G) Downpipe Strap        | (O) Post Bracket    |
| (H) Downpipe Outlet       | (P) Post Cap        |

Attached

# STRATCO OUTBACK FLAT VERANDAHS, PATIOS & CARPORTS

Type 4A (Attached)  
120 & 150 Beams

Maximum Allowable Span (mm)															
BEAM SIZE	SPAN S	N1 (W28)		N2 (W33)		W36N		N3, C1 (W41)		N4, C2 (W50)		W55C		C3 (W60)	
		BEAM SPACING B	COLUMN SPACING C	BEAM SPACING B	COLUMN SPACING C	BEAM SPACING B	COLUMN SPACING C	BEAM SPACING B	COLUMN SPACING C	BEAM SPACING B	COLUMN SPACING C	BEAM SPACING B	COLUMN SPACING C	BEAM SPACING B	COLUMN SPACING C
120 Beam	3600	6800	7000	6750	4850	5750	4050	4350	3900	2900	2600	2350	2700	1950	2250
	3900	6700	6850	6150	4750	5100	3950	3900	3850	2550	2550	2100	2700	1750	2250
	4200	6600	6750	5550	4650	4600	3850	3450	3800	2300	2500	1850	2650	1550	2200
	4500	6350	6650	5000	4550	4150	3800	3150	3750	2050	2450	1700	2600	1400	2150
	4800	5450	6550	4550	4500	3750	3700	2850	3700	1850	2450	1550	2550	1250	2150
	5100	4600	6300	4150	4450	3400	3700	2600	3650	1700	2400	1400	2500	1150	2100
	5400	3850	5850	3800	4400	3150	3650	2350	3600	1550	2350	1300	2600	1050	2100
	5700	3250	5550	3250	4350	2900	3550	2200	3500	1450	2300	1150	2450	n/a	n/a
6000	2750	5500	2750	4300	2650	3500	2000	3500	1300	2200	1100	2400	n/a	n/a	
<b>BO MAX:</b>		1000		1000		600		600		600		600		600	
<b>FOOTING TYPE:</b>		1		1		2		2		2		3		3	
150 Beam	3600	7950	7100	7950	6300	7950	5300	6500	5000	4300	3300	3500	2700	2950	2250
	4200	7750	6850	7750	6050	7150	5050	5450	4800	3550	3150	2950	2600	2450	2150
	4800	7550	6600	7100	5850	5850	4800	4450	4650	2900	3050	2400	2500	2000	2100
	5400	6800	6350	5950	5600	4900	4650	3700	4500	2450	2950	2000	2450	1650	2000
	6000	5500	6200	5050	5450	4200	4500	3150	4400	2050	2900	1700	2350	1400	1950
	6600	4550	6050	4400	5300	3600	4400	2750	4250	1800	2800	1450	2300	1200	1900
	7200	3750	5900	3750	5200	3150	4250	2400	4150	1550*	2700*	n/a	n/a	n/a	n/a
	7800	3000	5600	3000	5050	2800	4150	2100	4000	1350*	2700*	n/a	n/a	n/a	n/a
8400	2350	5400	2350	4950	2350	4050	1850	3900	1200*	2550*	n/a	n/a	n/a	n/a	
<b>BO MAX:</b>		1000		1000		600		600		600		600		600	
<b>FOOTING TYPE:</b>		1		2		2		3		3		3		3	

Note: Minimum roof pitch shall be 1° for deck spans up to 4000mm and 1.5° for spans exceeding 4000mm

\* Applies to non-cyclonic designs only

## Notes & Requirements

- These tables must be read in conjunction with General Notes and detail drawings on pages 6 - 11.
- Span S is the distance between the wall or eaves line and the outside face of the fascia beam. Beam Spacing B is the distance between beam centres. Column spacing C is the distance between column centres. Beam overhang BO is the distance between the column centre and the outside face of the side beam. Deck overhang DO is the distance between the outside face of the fascia beam and the inside edge of the gutter.
- The back span shall be a minimum 1.5 x BO for units with a beam overhang.
- Spans shown allow for a maximum 600mm deck overhang DO.
- This design may be rotated through 90° to run the roof sheeting parallel to the wall or eaves line provided that the length does not exceed twice the width of the structure.
- The purlins must be positioned mid - span of distance S.
- Columns are to be 68mm x 68mm x 0.6mm BMT profiled Outback columns.
- Columns on attached units may be fixed to existing concrete slab using the footing plate detail shown on page 7.
- Additional beams and/or columns may be required when a unit is attached in a corner or alcove.
- Interpolation may be used for values required between those shown in the tables.

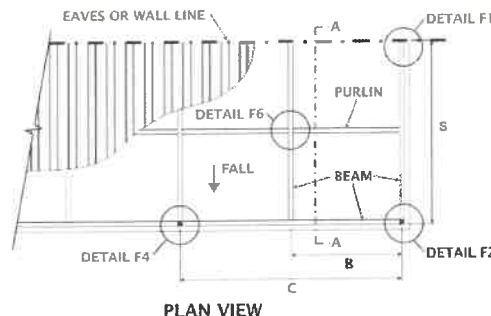
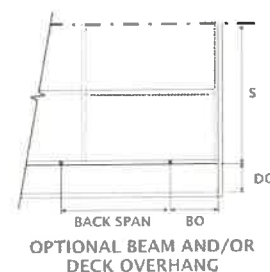
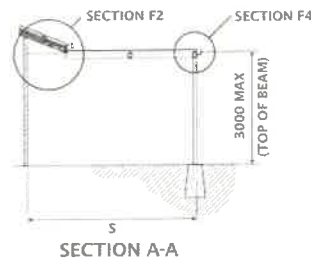

## Footings

- 300 x 300 x 500mm deep with 60mm corbel.
- 300 x 300 x 600mm deep with 60mm corbel.
- 350 x 350 x 650mm deep with 60mm corbel.
- 450 x 450 x 750mm deep with 75mm corbel.

## Height Increase

Units to be located in areas of wind classification N1 (W28), N2 (W33) or N3 (W41), with columns embedded into concrete footings, will be suitable at heights over 3000mm up to a maximum 3600mm with the following requirements:

- All Outback columns shall be reinforced with 50x50x3.0mm SHS with the exception of units in N3 wind classification which require 75x75x2.5mm SHS columns.
- In wind classification N2 & N3 a 15% reduction is required in both beam and column spacing.
- Increase allocated footing type by 1.

# STRATCO OUTBACK FLAT VERANDAHS, PATIOS & CARPORTS

## Connection Details

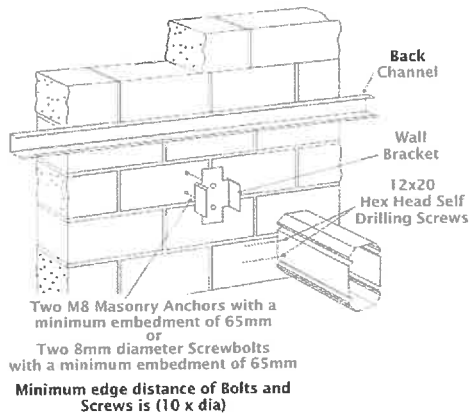

**DETAIL F1**

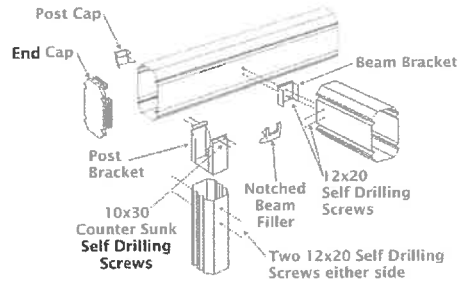

**DETAIL F2**

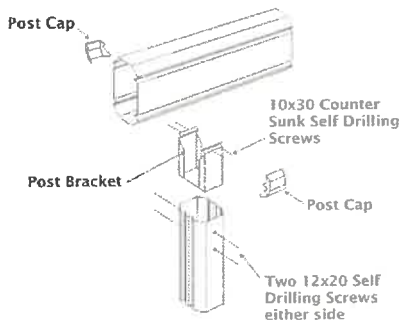

**DETAIL F3**

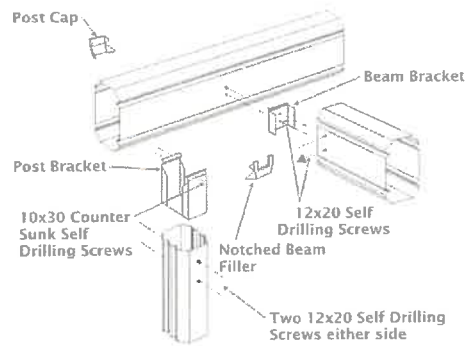

**DETAIL F4**

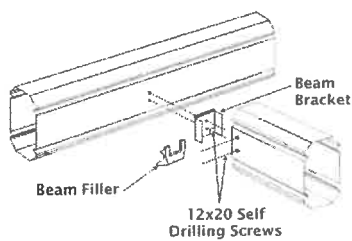

**DETAIL F5**

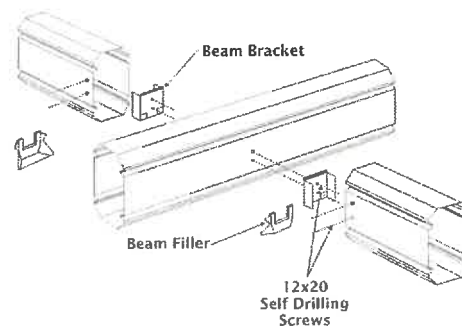

**DETAIL F6**

# STRATCO OUTBACK FLAT VERANDAHS, PATIOS & CARPORTS

## Connection Details

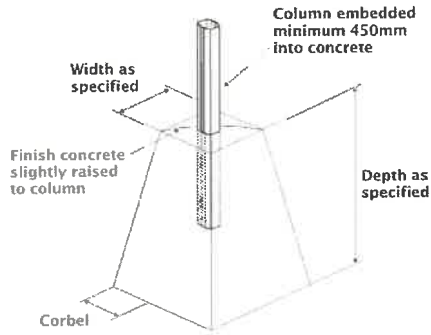

**FOOTING**

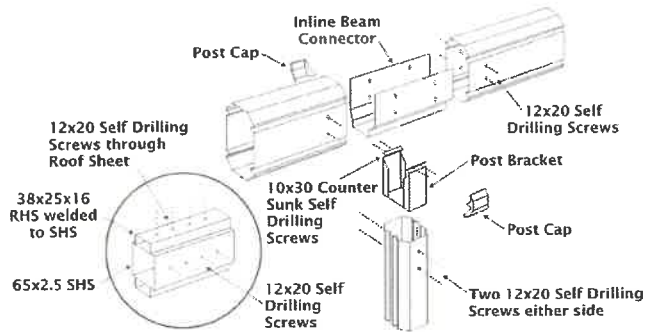

**FULL MOMENT BEAM CONNECTOR**  
(Mid Span Joiner)

**INLINE BEAM CONNECTOR**

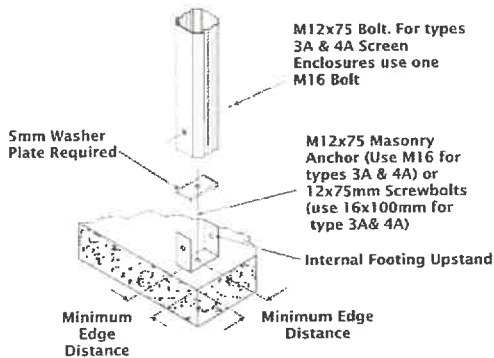

**ATTACHED VERANDAH INTERNAL FOOTING UPSTAND**

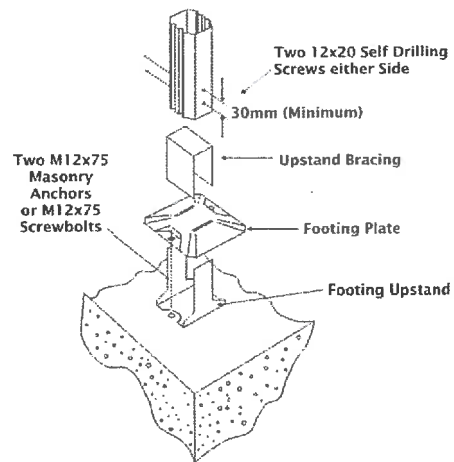

**ATTACHED VERANDAH FOOTING PLATE**

**Note:** The minimum edge distance is 70mm for M10 anchors, 75mm for M12 anchors and 120mm for M16 anchors.

# STRATCO OUTBACK FLAT VERANDAHS, PATIOS & CARPORTS

## Section Details

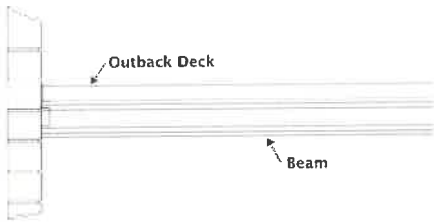

**SECTION F1**

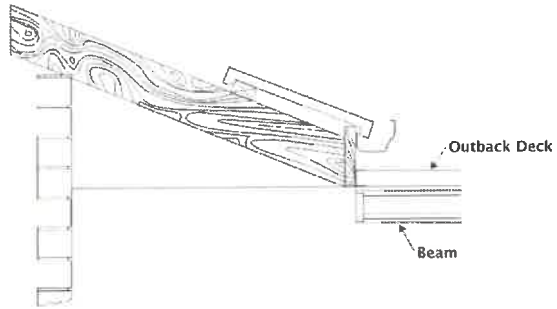

**SECTION F2**

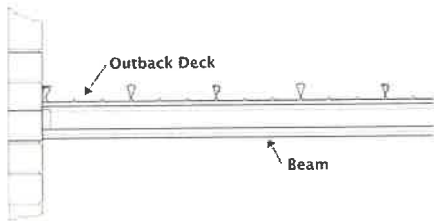

**SECTION F3**

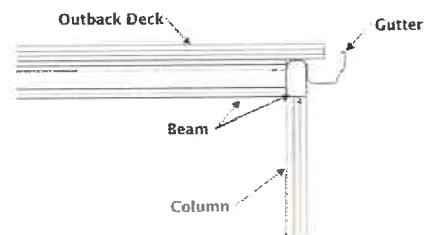

**SECTION F4**

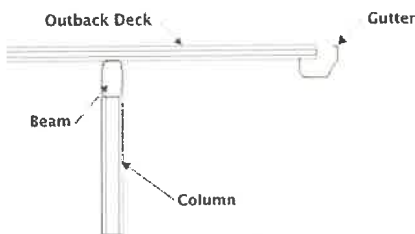

**SECTION F5**

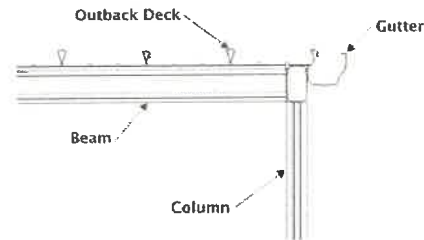

**SECTION F6**

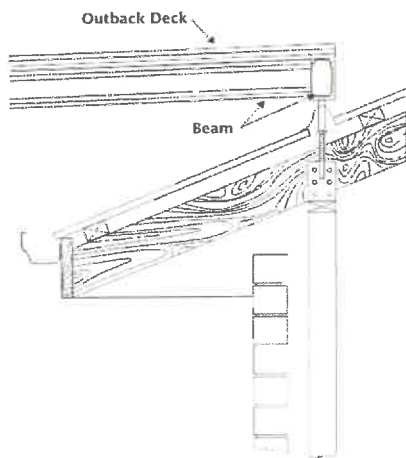

**ROOF EXTENDA\***

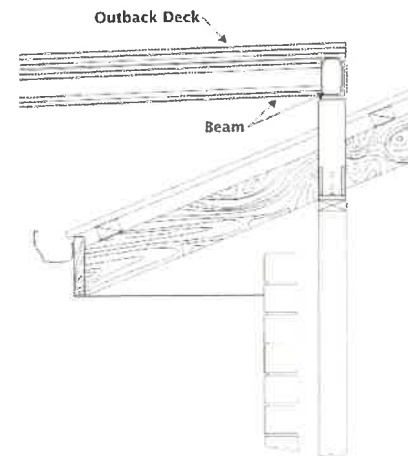

**FLYOVER BRACKETS\*\***

**\*Roof Extenda\* Brackets:**

For additional unit height (not to exceed that specified in the relevant Outback tables) the option of using Roof Extenda\* Brackets is available. Brackets are manufactured by Roof Extenda\* PTY LTD with installation instructions, spacing requirements and engineering limitations specified at [www.roofextenda.com.au](http://www.roofextenda.com.au).

**\*\*Flyover Brackets:**

Flyover Brackets are available for Flat Patio attachments. Refer Stratco for further advice.

# STRATCO OUTBACK FLAT VERANDAHS, PATIOS & CARPORTS

## Back Channel Details

### BACK CHANNEL FIXING DETAILS

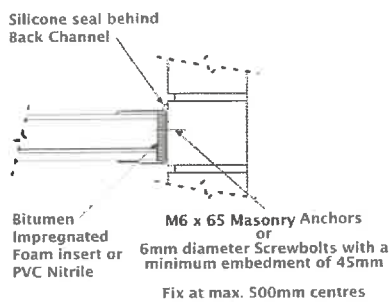

**BRICKWORK**

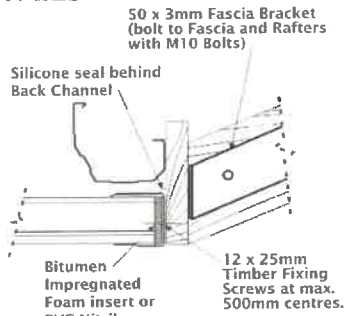

**TIMBER FASCIA**

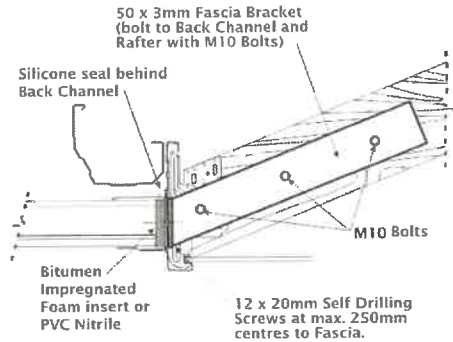

**STEEL FASCIA**

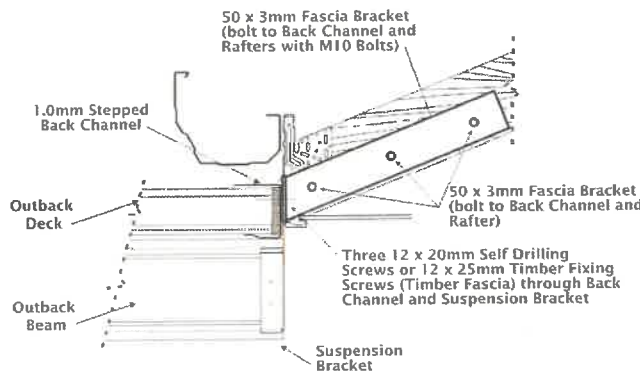

**SUSPENSION BRACKET**

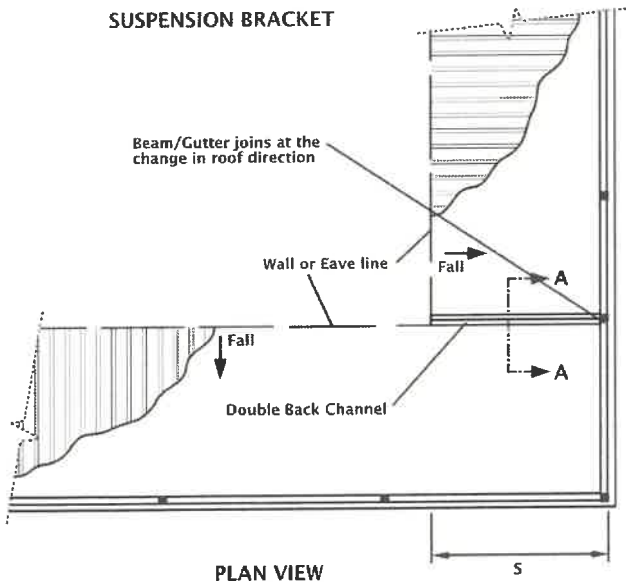

**PLAN VIEW**

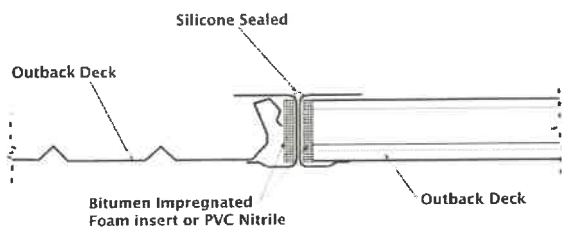

**TYPICAL SECTION A-A  
DOUBLE BACK CHANNEL DETAILS**

Fascia brackets are generally fastened at 1200mm centres to back channel and rafters. Additional strengthening may be required, it is the builder's responsibility to determine the adequacy of the rafters and the frequency of brackets for each individual situation (refer note 10, General Notes)

#### CLICKFORM COVER CHANNEL

If required, rivet cover channel to the outside face and underside edge of fascia at max. 250mm centres.

#### RECOMMENDED BACK CHANNEL FIXINGS

**Timber Fascia:** Use 12x25 timber fixing screws at max. 500mm centres.

**Brickwork:** Use M6x65 masonry anchors

OR

6mm diameter screwbolts with a minimum embedment of 45mm.

Fix at max. 500mm centres.

**Steel Fascia:** Use 12x20 self drilling screws at max. 250mm centres. It is recommended steel fascia brackets are fastened to the side of rafters at 1200mm centres.

SECTION	MAXIMUM ALLOWABLE SPAN (S)						
	N1 (W28)	N2 (W33)	W36N	N3, C1 (W41)	N4, C2 (W50)	W55C	C3 (W60)
Double Back Channel	3700	2850	2450	1950	1500	1500	n/a
Single Re-inforced Back channel	4200	3600	3100	2500	1800	1850	1600
Double Re-inforced Back channel	4500	4500	4150	3400	2500	2550	2200



#### DOUBLE BACK CHANNEL

Back channels fixed with 12x20 Self Drilling Screws from alternating sides at maximum 300mm centres.



#### SINGLE REINFORCED BACK CHANNEL

1 strip 50x5mm galvanised mild steel flat strip fixed by 6mm diameter bolts at maximum 500mm centres.



#### DOUBLE REINFORCED BACK CHANNEL

2 strips 50x5mm galvanised mild steel flat strip fixed by 6mm diameter bolts at maximum 500mm centres.

# STRATCO OUTBACK FLAT VERANDAHS, PATIOS & CARPORTS

Dimensions - Fixing Details

## FIXING REQUIREMENTS:

### For Non Cyclonic Areas:

Two 12 x 20 self drilling screws per pan at each support and two 3.2mm sealed aluminium rivets per pan at the Back Channel. If decking runs parallel to the back channel, secure to channel with rivets at maximum 200mm centres and screw to parallel beams at 500mm centres. All screws are to have neoprene washers.

### For Cyclonic Areas:

Three 12 x 20mm self drilling screws per pan at each support. For deck spans less than 3600mm, two self drilling screws per pan are suitable on the fascia beams. All screws are to have neoprene washers.

Three 4.8mm sealed rivets per pan (or 150mm centres if sheets are parallel) to be used at the back channel.

## ROOF SHEETING



OUTBACK DECK

## STRUCTURAL SECTIONS

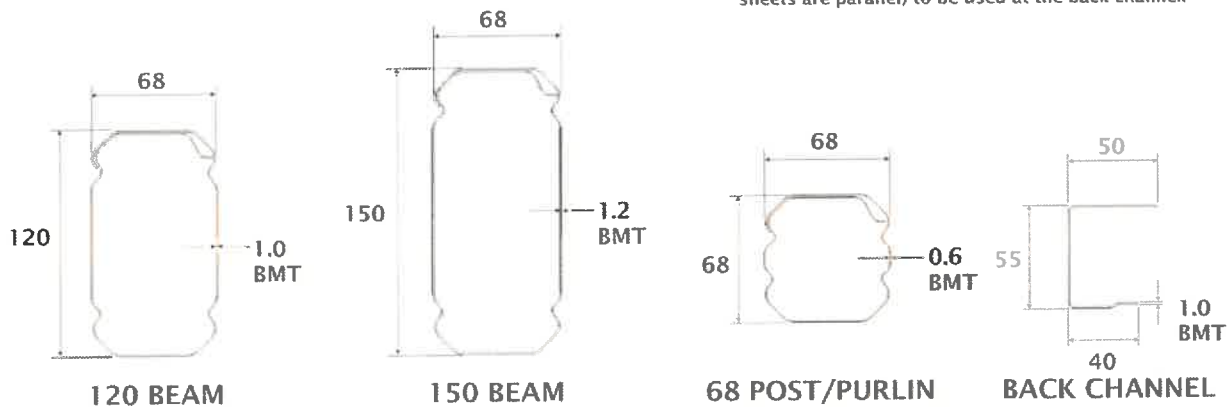

120 BEAM

150 BEAM

68 POST/PURLIN

BACK CHANNEL

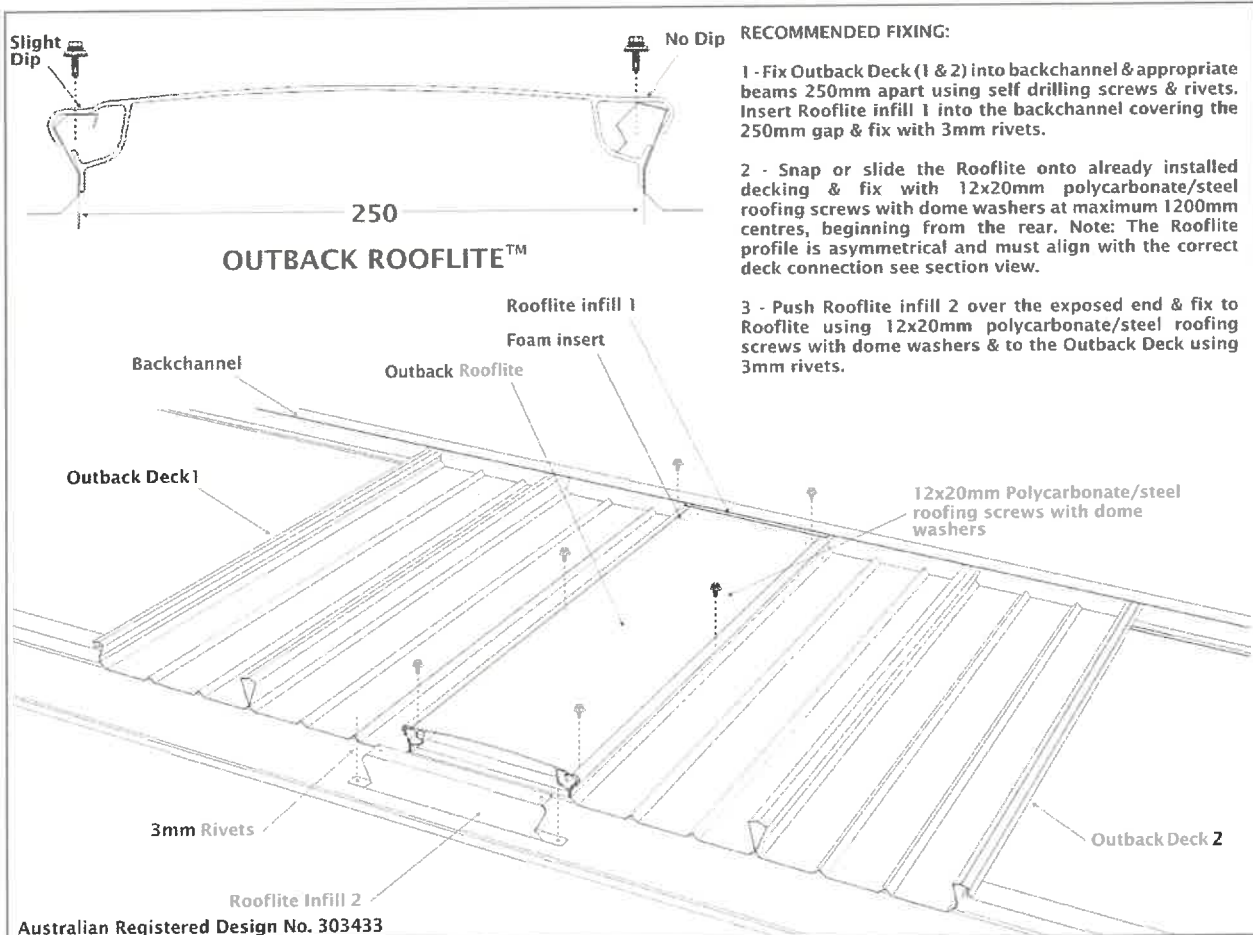

OUTBACK ROOFLITE™

### RECOMMENDED FIXING:

- 1 - Fix Outback Deck (1 & 2) into backchannel & appropriate beams 250mm apart using self drilling screws & rivets. Insert Rooflite infill 1 into the backchannel covering the 250mm gap & fix with 3mm rivets.
- 2 - Snap or slide the Rooflite onto already installed decking & fix with 12x20mm polycarbonate/steel roofing screws with dome washers at maximum 1200mm centres, beginning from the rear. Note: The Rooflite profile is asymmetrical and must align with the correct deck connection see section view.
- 3 - Push Rooflite infill 2 over the exposed end & fix to Rooflite using 12x20mm polycarbonate/steel roofing screws with dome washers & to the Outback Deck using 3mm rivets.

Australian Registered Design No. 303433

**Right Elevation ( SOUTH ELEVATION )**

Order Reference: Garage  
Sales Person: Mr Brett Nitschke  
Client Name: Joel Shean

Design Number: O1 086882  
Date: 23/06/2025  
Site Address: 40 Meredith Avenue  
Clengowrie

From behind existing shed.

will only see this structure of new carport.



**Right Elevation**

( SOUTH ELEVATION )

Order Reference  
Sales Person  
Client Name

Garage  
Mr Brett Nitschke  
Joel Srean

Design Number  
Date  
Site Address  
Clengowrie

01086882  
23/06/2025  
40 Meredith Avenue  
Clengowrie

without the existing  
shed in front of it.