



Gorgon CO₂ Long-term Optimisation

Scope of Supply – DC-D and DC-E Storage Buildings

Document ID: CO2-0000-STR-SOW-CVX-000-00002-00
Revision ID: A
Revision Date: 29 April 2024
Information Sensitivity: Internal

Gorgon CO₂ Long-term Optimisation

Scope of Supply – DC-D and DC-E Storage Buildings

Document Information

Document Number	CO2-0000-STR-SOW-CVX-000-00002-00	Revision	A
Document Owner	Tamsyn Wirtz	Department	Facilities

Revision History

Rev No.	Description	Date	Prepared By	Checked by	Approved By
A	Issued for Review	29/03/2024	Tamsyn Wirtz		

Approvals

	Name	Signature	Date
Author:	Tamsyn Wirtz		
Checked:	James Newton-Howes		
Approved:	Dan Loomes		

Revision Summary (optional)

Rev No.	Brief Description

© 2024 by Chevron Australia Pty Ltd

This document contains proprietary information of Chevron Australia Pty Ltd. Any use of this document without express, prior, written permission from Chevron Australia Pty Ltd and/or its affiliates is prohibited.

Contents

1	Introduction	4
1.1	Scope	4
1.2	Acronyms and Abbreviations	4
2	Scope of Work	4
2.1	Scope of Supply.....	4
2.2	Basis of Design.....	5
2.3	Shed Locations	5
2.4	Design Parameters	5
2.5	Deliverables	6
2.6	Work Excluded.....	6
3	Other Requirements.....	7
3.1	Quarantine, Preservation, Packing, Marking and Documentation.....	7
3.2	Supporting Suspended Loads.....	7
3.3	Insulation and Ventilation	7
3.4	Site Support for Installation	7
3.5	Storage Requirements	7
4	Bidder Documentation.....	8
	Appendix A – Model Shots: Chemical Storage Shed.....	9
	Appendix B – Model Shots: Nitrogen / Instrument Air Shed	13
	Appendix C – SDRL.....	16

1 Introduction

1.1 Scope

This Scope of Supply document defines the requirements for the supply of storage sheds to be installed at Barrow Island (BWI) located approximately 140 km West of Dampier and 95 km North-West of Onslow in Western Australia.

These facilities are intended to store Chemical Injection equipment and Nitrogen / Instrument Air packages at Drill Centres, DC-D and DC-E.

1.2 Acronyms and Abbreviations

Table 1-1 defines the acronyms and abbreviations used in this document.

Table 1-1: Acronyms and Abbreviations

Acronym / Abbreviation	Definition
BWI	Barrow Island
DC-D	Drill Centre D
DC-E	Drill Centre E
CI	Chemical Injection
IA / N2	Instrument Air / Nitrogen Package
PO	Purchase Order
SOW	Scope of Work

2 Scope of Work

2.1 Scope of Supply

This requisition is for storage sheds at DC-D and DC-E as per Table 1-2.

The scope of supply for the building shall as a minimum include, but not necessarily be limited to that as set out below.

Table 1-2: Scope of Supply

Item	Qty	Unit	Definition
1	DC-D		
1.1	1	Each	Storage shed – Chemical Injection 15mx11mx7.5m(H)
1.2	1	Each	Storage shed – Nitrogen and Instrument Air 16.2mx12mx7.2m(H)
2	DC-E		
2.1	1	Each	Storage shed – Chemical Injection 15mx11mx7.5m(H)
2.2	1	Each	Storage shed – Nitrogen and Instrument Air 16.2mx12mx7.2m(H)

2.2 Basis of Design

Appendix A and Appendix B contain model images of the two sheds including details of required roller doors, personnel access doorways and ventilation louvres. It may be noted that some utility pipe is to be supported from building frame (details will be supplied by company).

It is the responsibility of the supplier to incorporate the functional specifications detailed in Appendices A and B into the engineering design and supply of the facilities.

2.3 Shed Locations

Figure 1 shows the locations of the two storage sheds at DC-D. The sheds will have a similar layout at DC-E.

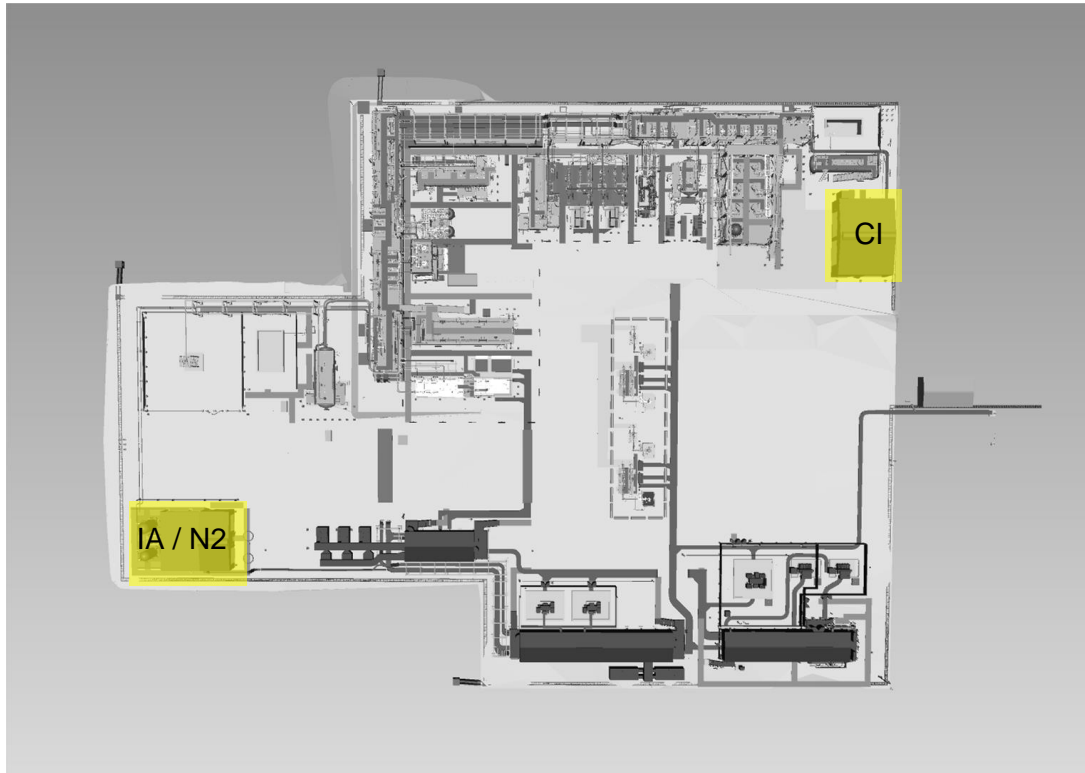

Figure 1: Locations of Chemical Injection and IA / N₂ storage sheds at DC-D.

2.4 Design Parameters

Table 1-3 outlines the the Reference Documents, Specifications and Standards this Scope shall comply with.

Table 1-3: Reference Documents, Specifications and Standards

Document ID	Description	Rev	Rev Date
CHEVRON STANDARDS AND SPECIFICATIONS			
ABU-0000-STR-STD-CVX-00001	ABU Standard Onshore Structures Assessment Basis	1	19 Oct 2023
G1-TE-S-0000-SPC2001	Specification for Structural Steel Design Criteria	3	25 Feb 2010
NATIONAL AND INTERNATIONAL STANDARDS AND SPECIFICATIONS			
AS/NZS 1170.0:2002	Structural design actions, Part 0: General principles	-	
AS/NZS 1170.1:2002	Structural design actions, Part 1: Permanent, imposed and other actions	-	
AS/NZS 1170.2:2021	Structural design actions, Part 2: Wind actions	-	
AS/NZS 1170.4:2007	Structural design actions, Part 4: Earthquake actions in Australia	-	
AS 4100:2020	Steel Structures	-	
AS/NZS 4505:2012	Garage doors and other large access doors	-	

Wind actions are to be determined in accordance with AS/NZS 1170.2:2021, with the following design parameters considered:

- Cyclone Region D
- Importance Level 3
- Terrain Category 2

Seismic design will consider the response spectra described in section 3.4.1 of ABU-0000 STR-STD-CVX-00001.

Specification for Structural Steel Design Criteria (G1-TE-S-0000-SPC2001) outlines connections (section 6.6), serviceability limits (section 6.4) and live loads (section 3.2).

2.5 Deliverables

The Contractor shall provide the deliverables post award as per the SDRL in Appendix C.

2.6 Work Excluded

The following items are specifically excluded from the Supplier's scope:

- Design of foundations (by others , contractor shall supply load-data)
- Transport to site

3 Other Requirements

- 3.1 Quarantine, Preservation, Packing, Marking and Documentation**
BWI is a Class 'A' nature reserve and strict quarantine requirements are mandated for all people, equipment and materials transiting the island. Packages should be clean and free of debris / organic matter to ensure quarantine requirements are met.
- 3.2 Supporting Suspended Loads**
The sheds will need to support suspended loads (eg. piperacks hanging from the roof). The supplier should be open to suggestions to increase roof member sizes to provide additional load bearing capacity.
- 3.3 Insulation and Ventilation**
The supplier shall provision for insulation in the storage sheds for temperature control and moisture prevention. The design should optimize natural ventilation (eg. ridge vents) as fans, heating and air conditioning will not be installed within the building.
- 3.4 Site Support for Installation**
Site support from an Installation Contractor may be required during installation of the sheds.
- 3.5 Storage Requirements**
The sheds shall be supplied flat-packed. DC-D sheds will be required by Q3 2025, and the second set for DC-E will require storage for approximately 6 months before use in Q1 2026. Storage may be at the supplier premises or site. An optional day rate for storage should be included in the Schedule of Rates.

4 Bidder Documentation

Documents to be submitted with the bid are outlined in Table 1-4.

Table 1-4: Bidder Documentation

	Document
1	Manufacturer's name, location, AVL compliance etc. against each line item.
2	Compliance with the specifications listed in Table 1-3.
3	Compliance with requirements stated in Section 3.
4	Compliance to SDRL stated in Appendix C.
5	Fabrication/Production schedule
6	Sub-vendor list
7	Quality manual and ISO 9001 certificate
8	Typical Quality plan
9	Commercial proposal – To be sent to Procurement separately.
10	Schedule of rates

Appendix A – Model Shots: Chemical Storage Shed

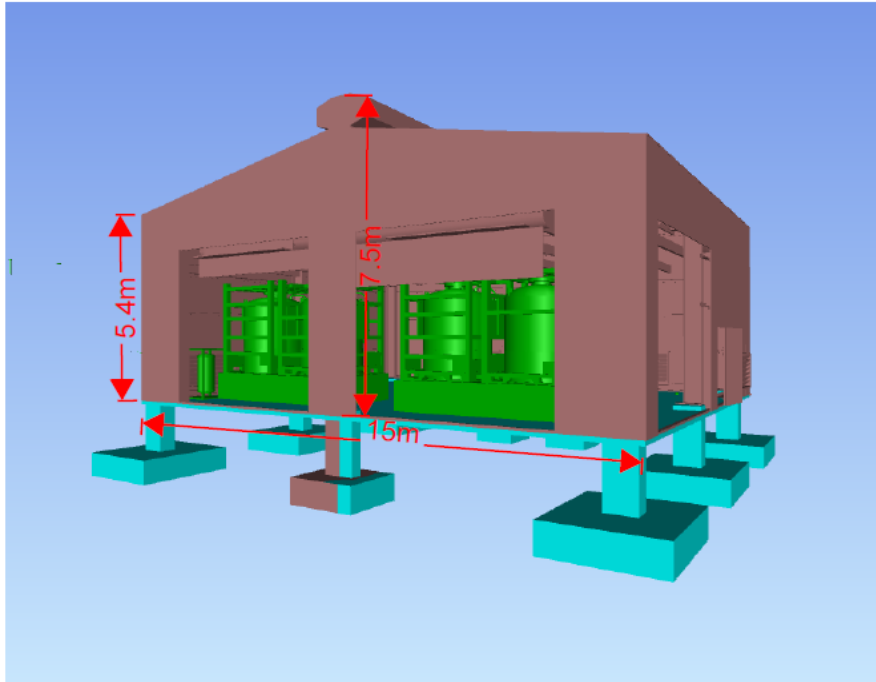

Plan View

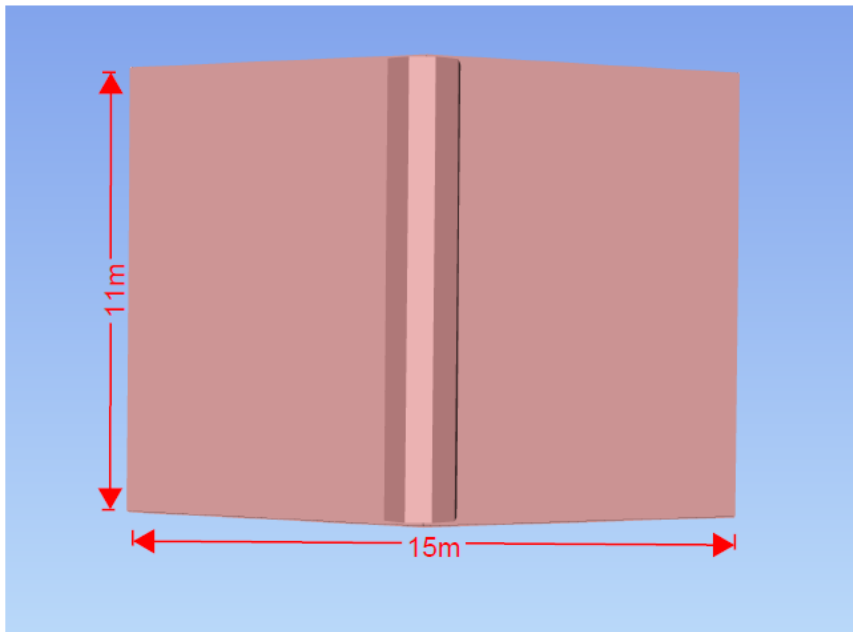

Cyclone rated roller doors
(5m wide x 4.17m high)

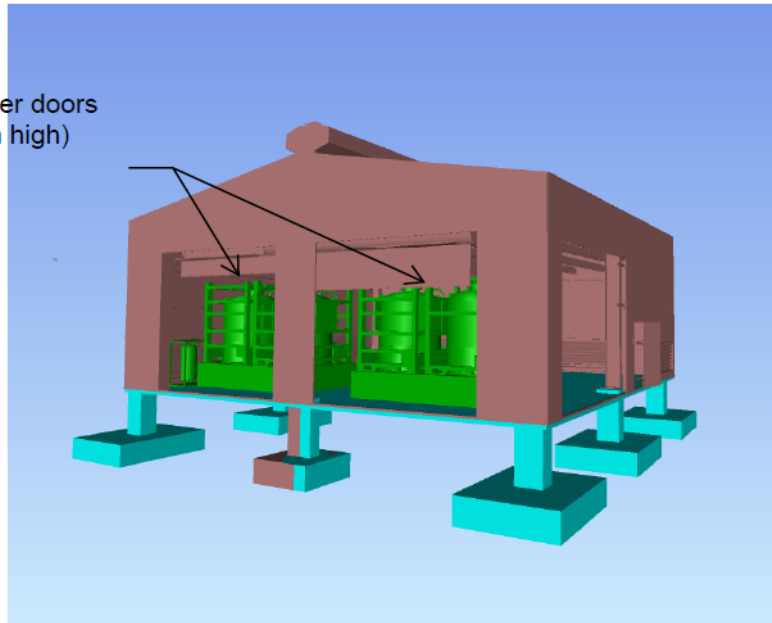

West elevation

Cyclone rated roller door
(4.5m wide x 3.95m high)

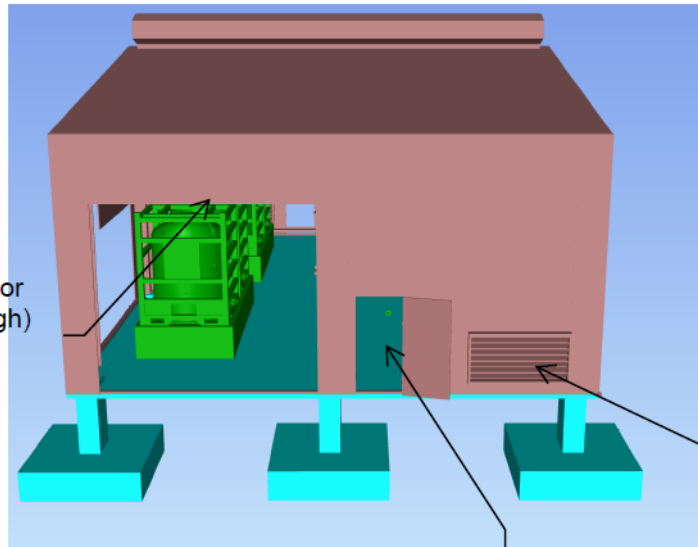

Louvre for ventilation
(2m wide x 0.97m high)

Personnel access door

South elevation

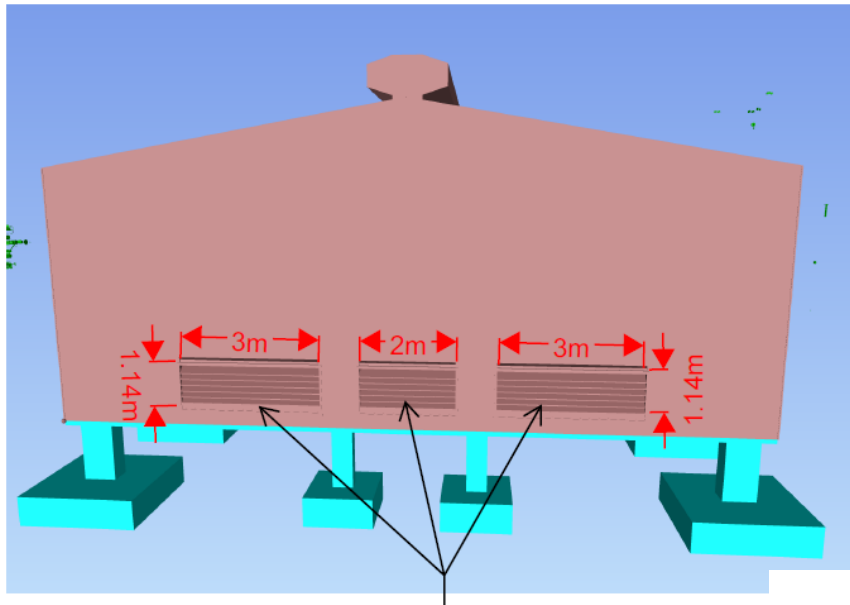

Louvres for ventilation

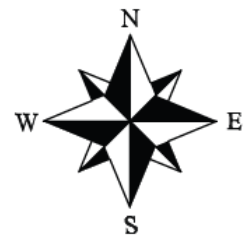

East elevation

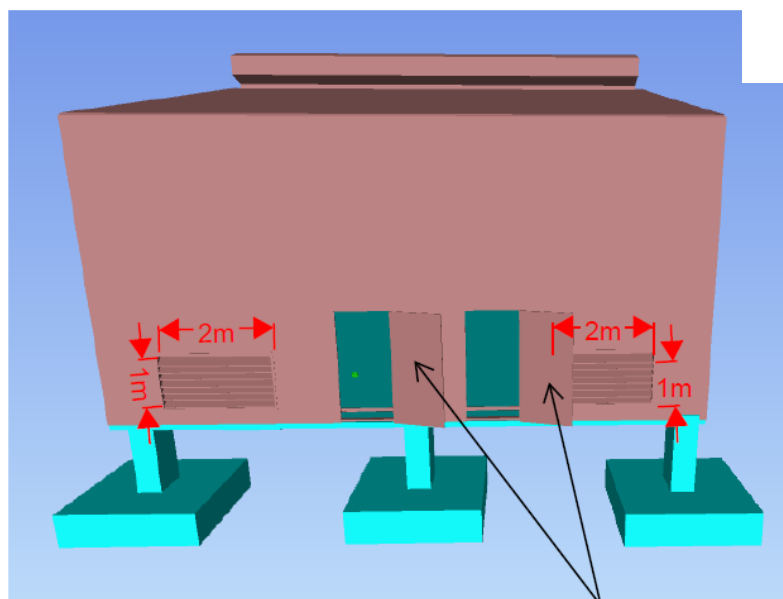

Personnel access
doorways

Equipment Layout

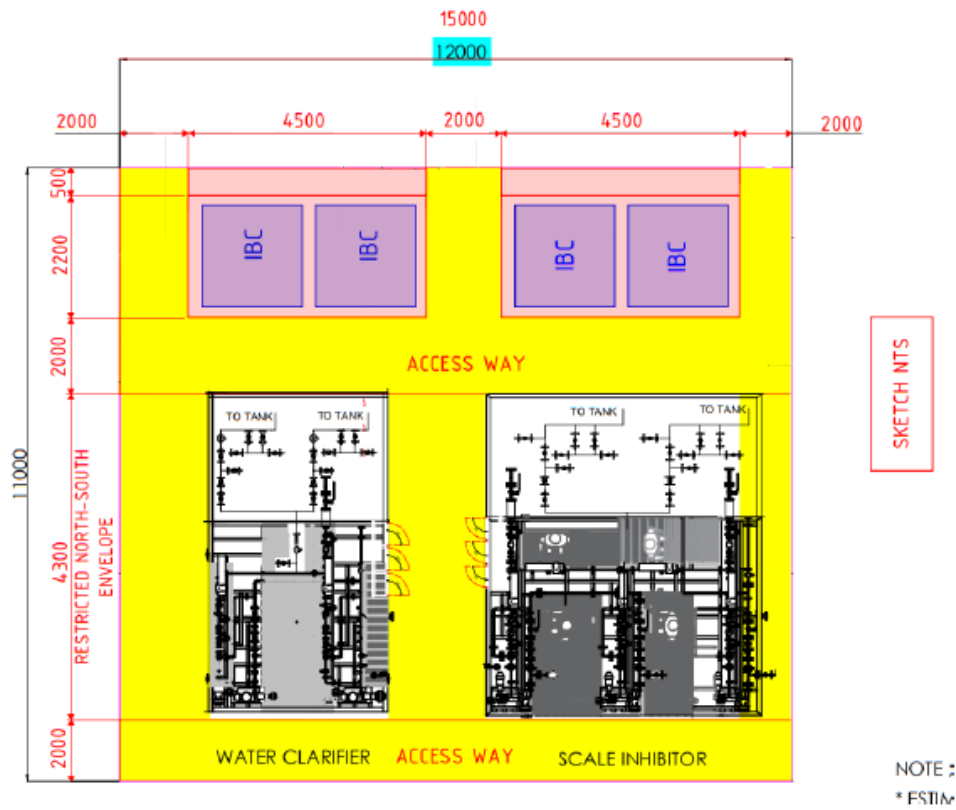

Appendix B – Model Shots: Nitrogen / Instrument Air Shed

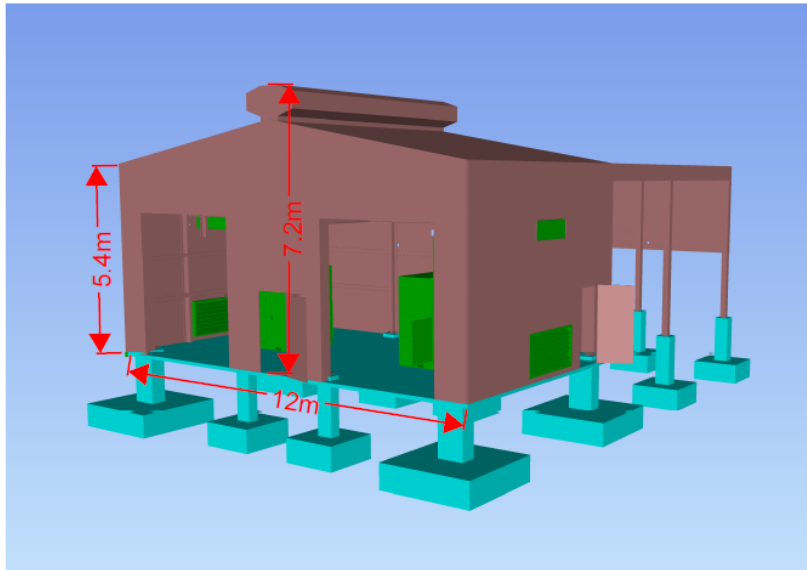

Plan view

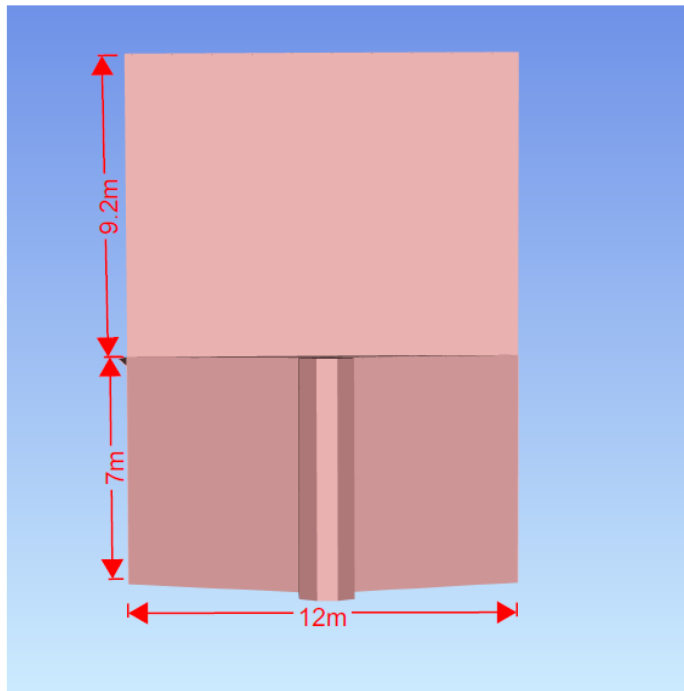

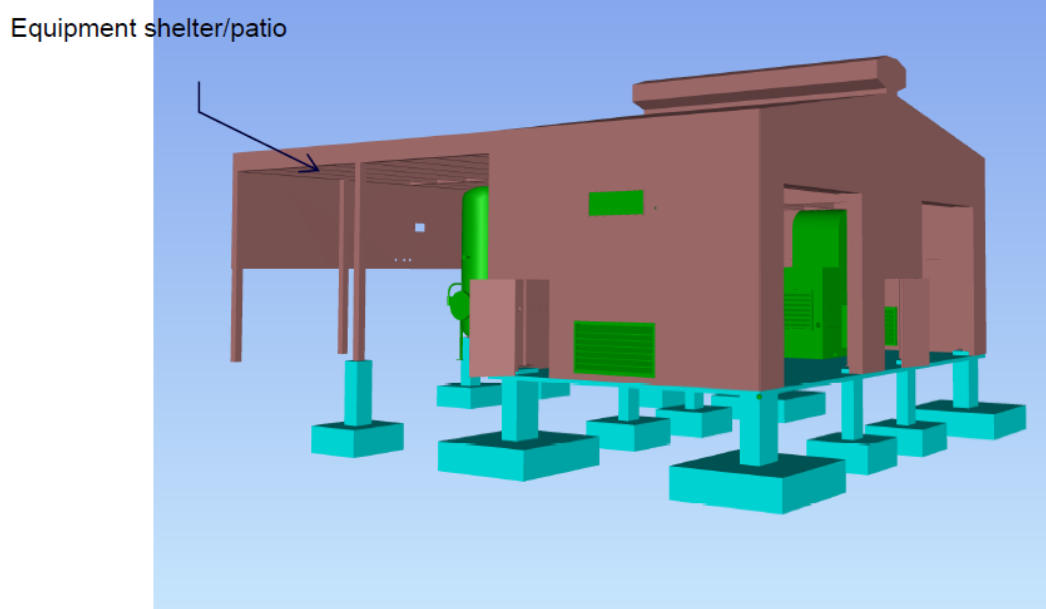
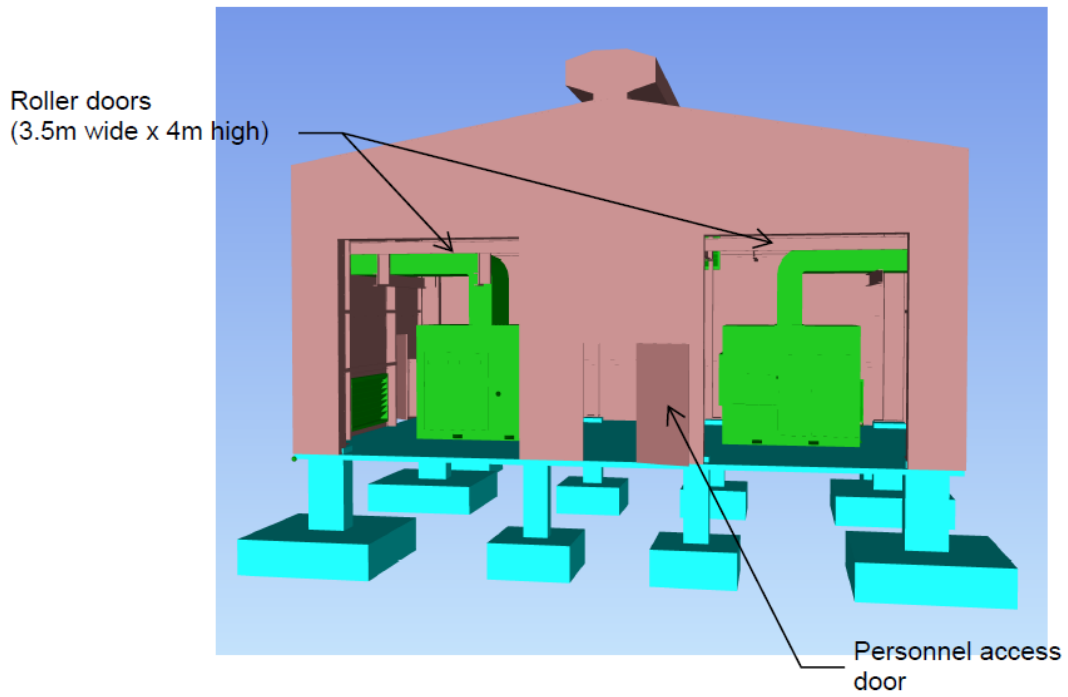

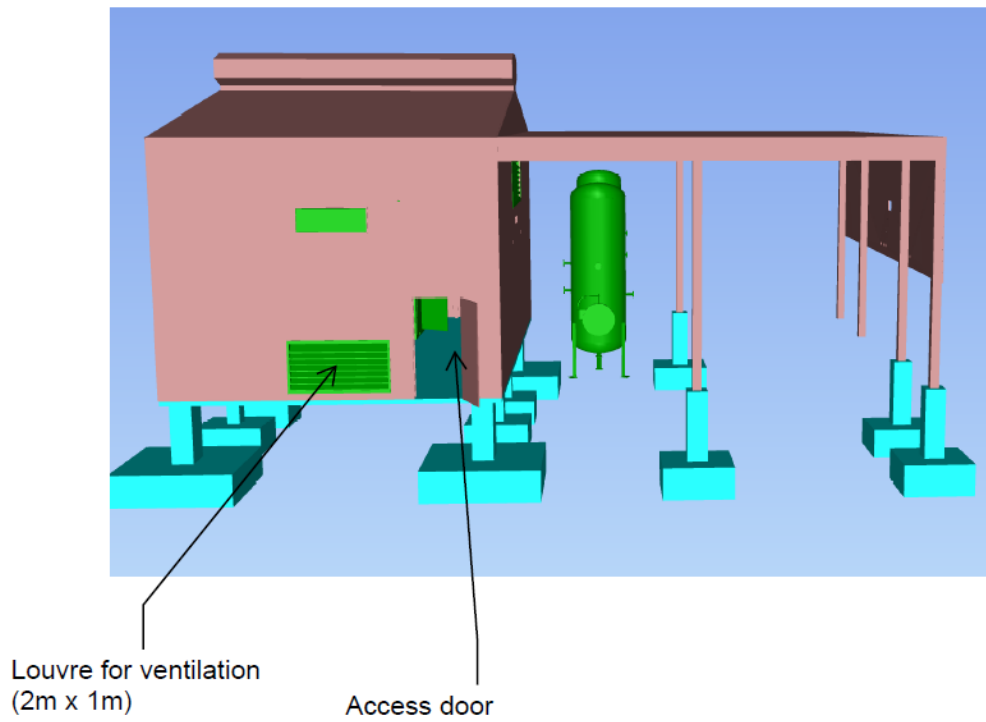
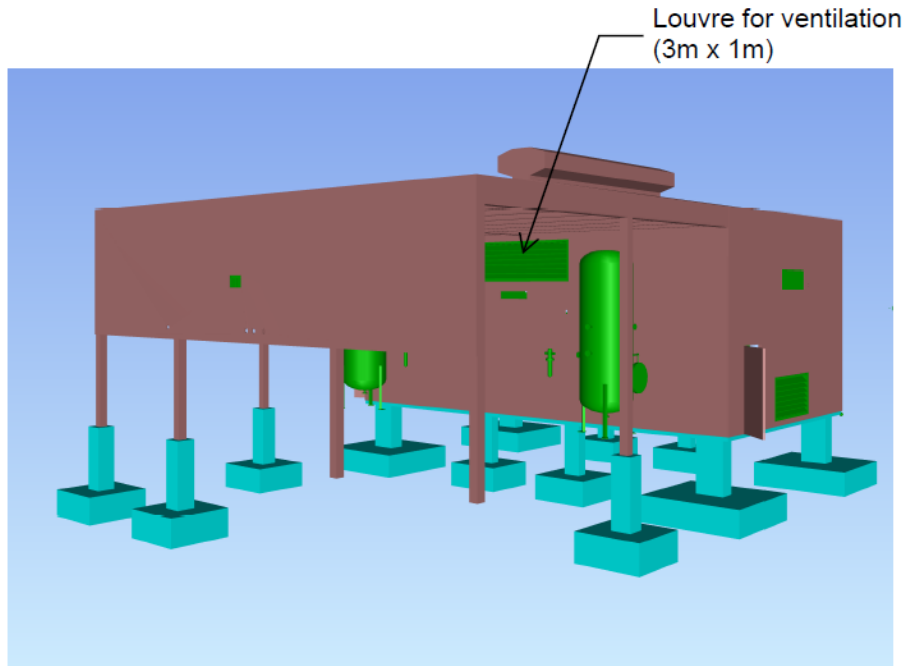

Appendix C – SDRL

APPENDIX C - SUPPLIER DATA REQUIREMENTS LIST

Customer Name: Chevron	Approved By:	Requisition No:
Project Title: CO2 LTOP DE-PMP	Approved Date:	Revision: 0
Jobsite Location: Barrow Island	Released To Proc:	Revision Date: 22-APR-2024
Project No:		Requisition Title: DE-PMP Storage Buildings

Doc Code	Description	Design Critical	With Proposal	Initial Submission					Final (Certified)			Applies to Item(s)	
				Due Date	For Information	For Review	For Review prior to Fabrication	Electronic Copy	No. of Hard Copies	Due Date	Electronic Copy		No. of Hard Copies
A101	Supplier Document Schedule (SDS)			1 APO		X		X		With MDR	X		All Items
A110	Progress Reports			Fortnightly	X			X		-			All Items
A111	Project Schedule			Fortnightly		X		X		-			All Items
A113	Sub-vendor List			2 APO	X			X		With MDR	X		All Items
C120	Structural Calculations for Each Shed			4 APO			X	X		With MDR	X		All Items
D158	Structural Drawings for Each Shed: General Arrangements / Layouts & Details			6 APO		X		X		With IOM	X		All Items
D161	Support / Foundation Load Data for Each Shed - Foundation Design by Others	Y		4 APO		X		X		With IOM	X		All Items
G102	Certificate of Compliance - Supplier			2 PTS						With MDR	X		All Items
G126	ISO 9000 Certification				X			X		With MDR	X		All Items
G129	Manufacturer's Data Report (MDR) / Manuf. Record Book (MRB)			ACR		X		X		2 AS	X		All Items
G131	Manufacturing / Fabrication Procedures			8 APO	X			X		With MDR	X		All Items
G152	Quality Plan			3 APO		X		X		With MDR	X		All Items
H103	Shipping Preparation, Packing, Handling & Storage Procedures			4 PTS		X		X		With IOM	X		All Items
J112	Installation Procedures			8 PTS		X		X		With IOM	X		All Items

Notes:			
3.1a	Items preceded with an asterisk (*) are new or have been revised.		
3.1b	Due Date Legend:	ACR - As Complete / Recurring AF - After Approval for Fabrication (Weeks) APO - After Receipt of Purchase Order (Weeks)	ARC - After Receipt of Commitment (Weeks) ARDA - After Receipt of Drawing Approval (Weeks) AS - After Shipment (Weeks)
3.1c	Items marked as "Design Critical" are critical to meeting the project's engineering schedule.		
3.1d	Refer to Supplier Data Specification (listed in Section II) for details pertaining to each document code.		
3.1e	Abbreviations:	Cert's - Certificates Cross Sect's - Cross Sections Drwgs - Drawings Equip't - Equipment ESD - Emergency Shut-Down	FAT - Factory Acceptance Test Insp. - Inspection IOM - Installation, Operating & Maintenance Manual Mat'ls - Materials MRB - Manufacturing Record Book
3.2	- All supplier documents specified for review prior to fabrication must be approved (Code 1 or Code 4) prior to fabrication.		