

# STORM WATER DRAINAGE

PROPOSED SHED, GARAGE AND OUTDOOR LIVING AREA ROOF WATER CATCHMENT TO BE CONNECTED TO THE EXISTING DWELLINGS INTERNAL STORM WATER SYSTEM - WITH DISCHARGE TO THE NOMINATE LPD LOCATION.

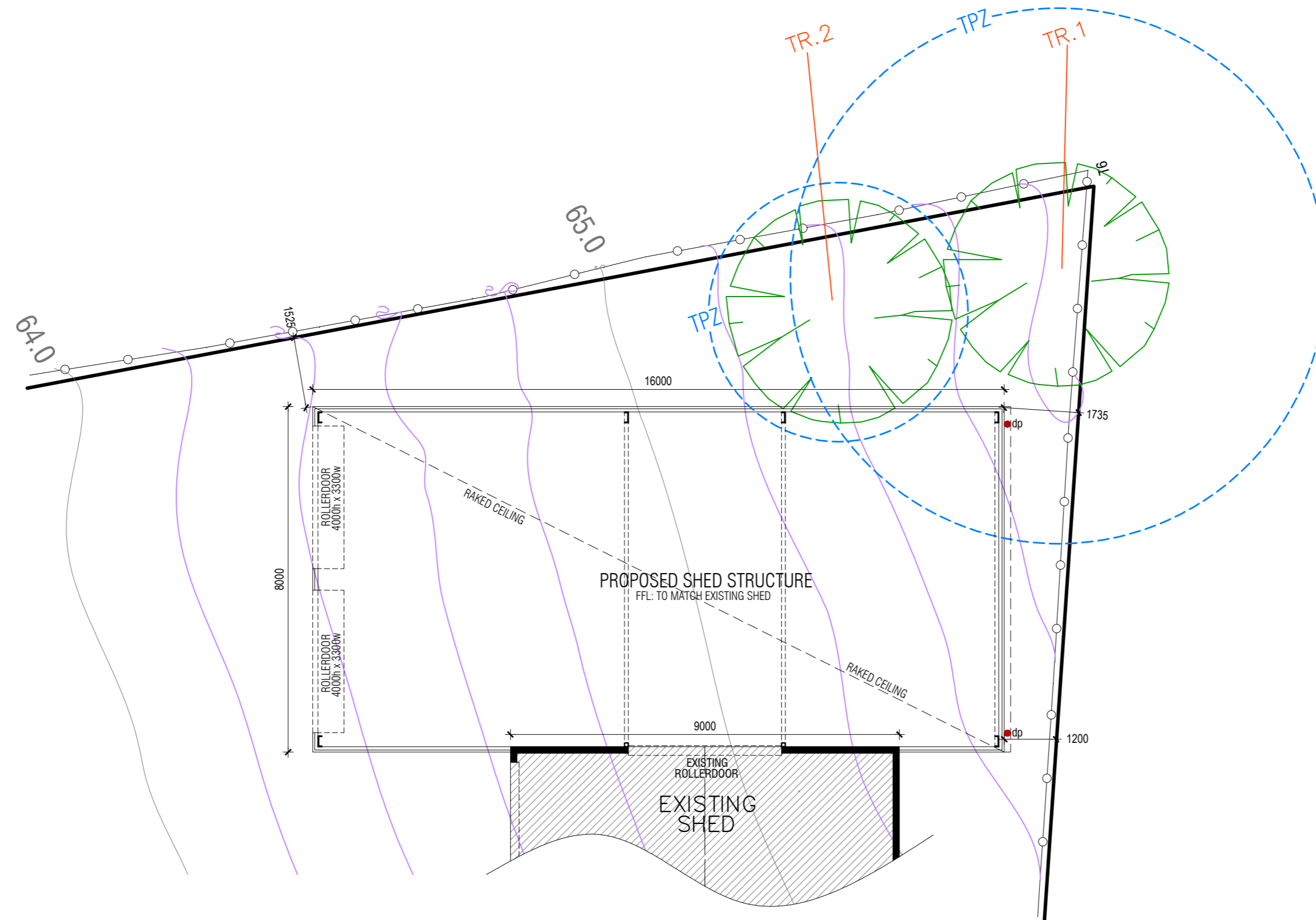

## REVISION SCHEDULE:

DATE REVISED	REV	REVISION DETAILS
02 OCT 2020	B	DESIGN DEVELOPMENT - ISSUE FOR CLIENT REVIEW
26 AUG 2021	C	DESIGN DEVELOPMENT - ISSUE FOR CLIENT REVIEW
16 JAN 2023	D	TOWN PLANNING DOCUMENTATION - ISSUE FOR CLIENT REVIEW & LODGEMENT
12 MAR 2024	E	PLANNING RFI RESPONSE - ISSUE FOR PLANNING REVIEW
28 MAY 2024	F	PLANNING RFI RESPONSE - ISSUE FOR PLANNING REVIEW
12 SEP 2024	G	SHED WORKING DRAWINGS - ISSUE FOR ENGINEERING

© ARCHEDGE DESIGN REMAINS THE PROPERTY OF ARCHEDGE DESIGN AND IS NOT TO BE REPRODUCED OR TRANSMITTED IN ANY FORM OR BY ANY MEANS, ELECTRONIC OR MECHANICAL, WITHOUT PERMISSION IN WRITING FROM ARCHEDGE DESIGN.



P: 0414 506 702 E: VINCE@ARCHEDGEDESIGN.COM.AU  
F: 9009 0823 A: PO BOX 98, EPPING 3076

DRAWING: SHED FLOOR PLAN  
PROJECT CONTEXT: NEW SHED OUTBUILDING  
SITE ADDRESS: No. 19 BADEN DRIVE, WANDONG, VIC 3758  
SITE OWNER: SHANNAN THOMAS  
P: 0418 316 156

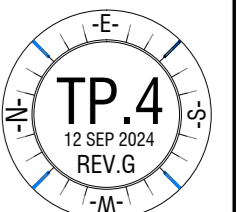

SCALE - 1:100 @ A2