

| OPTIONAL ADDITIONAL WORKS 01 - MATERIAL SCHEDULE | | | | | | | |
|--|-------|--|-----------------------------------|--|--------------|-----------|--|
| ID Code | Image | Supplier | Item Description | Model/ Finish | Test Results | Lead Time | Specification Notes |
| MT.AD1 | | Universal Anodisers Sophia Case 02 8788 2000 | Anodised Aluminium | 'Spanish Silver' Satin Finish (Clear Anodised) Microns: 25 | - | IN STOCK | To be applied according to manufacturers specifications. Refer to drawings for extent and detail. |
| MT.BA1 | | As required by contractor | External Steel Slatted Balustrade | 1100mm high steel balustrade - 12x50 Flat bar top, bottom rail and main baluster with Ø16mm vertical steel balusters at max. 100mm cts - Powdercoated Black Finish | - | IN STOCK | |
| MT.BLK1 | | Adam Ransley 0427 371 787 | 190 Blockwork | GB Smooth Face 'Pewter' Blockwork Series: 200mm Product Code: 20-01 Standard Block Size: 390L x 190W x 190H mm | - | | - Install with matching capping tile - Mortar: off white cement / white sand rolled mortar joint finish - Mortar: off white cement / white sand rolled mortar joint finish |
| MT.GAL1 | | By Contractor | Galvanised Steel | Galvanised Steel | - | | To comply with all relevant Australian Standards and building codes and suitable for exposure and location |
| MT.MS1 | | Lysaght | Metal Roof & Wall Sheeting | Profile: KLIP-LOK 700 HI Strength Finish: Colorbond 'Surfmist' | - | IN STOCK | Refer to drawings for details, direction and extent. All required components and fixings to match metal sheeting finish. To be installed as per manufacturers specifications. |
| MT.WM1 | | By Contractor | Stainless Steel Cyclone Wire Mesh | Stainless steel chain wire / cyclone fence 1.5mm diameter | - | IN STOCK | To be installed as per manufacturers specification. |

LEGEND

- GPO DOUBLE IP GPO
- DGPO DOUBLE GPO
- P PENDANT LIGHTING
- EDB LOAD CENTRE
- FX FIRE EXTINGUISHER
- RSS ROLLER SHUTTER POWER SUPPLY

| OPTIONAL ADDITIONAL WORKS 01 - SPECIALTY EQUIPMENT SCHEDULE | | | | | | |
|---|------------|--|-------------------------|--|-------------|--|
| Type Mark | Type Image | Manufacturer | Description | Model | Lead Time | Comments |
| SE.SH1 | | Dexon Greg Blackler 0414 660 522 | 6m Cantilevered Racking | Dexon Heavy Duty Cantilever Racking Racking Length: 6000mm Column Height: 3300mm Base: 1200mm Arm Length: 1200mm | 6-8 Weeks | To be installed to manufacturers specification. Contractor to fix to slab as required with masonry anchors to manufacturers specification. |
| SE.SH2 | | Dexon Greg Blackler 0414 660 522 | 4m Cantilevered Racking | Dexon Heavy Duty Cantilever Racking Racking Length: 4000mm Column Height: 3300mm Base: 1200mm Arm Length: 1200mm | 6-8 Weeks | To be installed to manufacturers specification. Contractor to fix to slab as required with masonry anchors to manufacturers specification. |
| SE.SH3 | | Dexon Greg Blackler 0414 660 522 | Longline Shelving | Spreadrack Shelving Size: 3000h x 1200w x 1200d mm | 6-8 Weeks | To be installed to manufacturers specification. Contractor to fix to slab as required with masonry anchors to manufacturers specification. |
| SE.SH4 | | Abbott Storage Systems 1300 514 152 | Vertical Timber Storage | SSKU VRT5341 Size: 3050h x 1800w x 600d mm Finish: Powdercoat Blue | 12-15 Weeks | To be installed to manufacturers specification. Contractor to fix to slab as required with masonry anchors to manufacturers specification. |

BLOCK O

BLOCK R

2 RELOCATED ACCESSIBLE PARKING (REFER TO A-1000 FOR LOCATION)

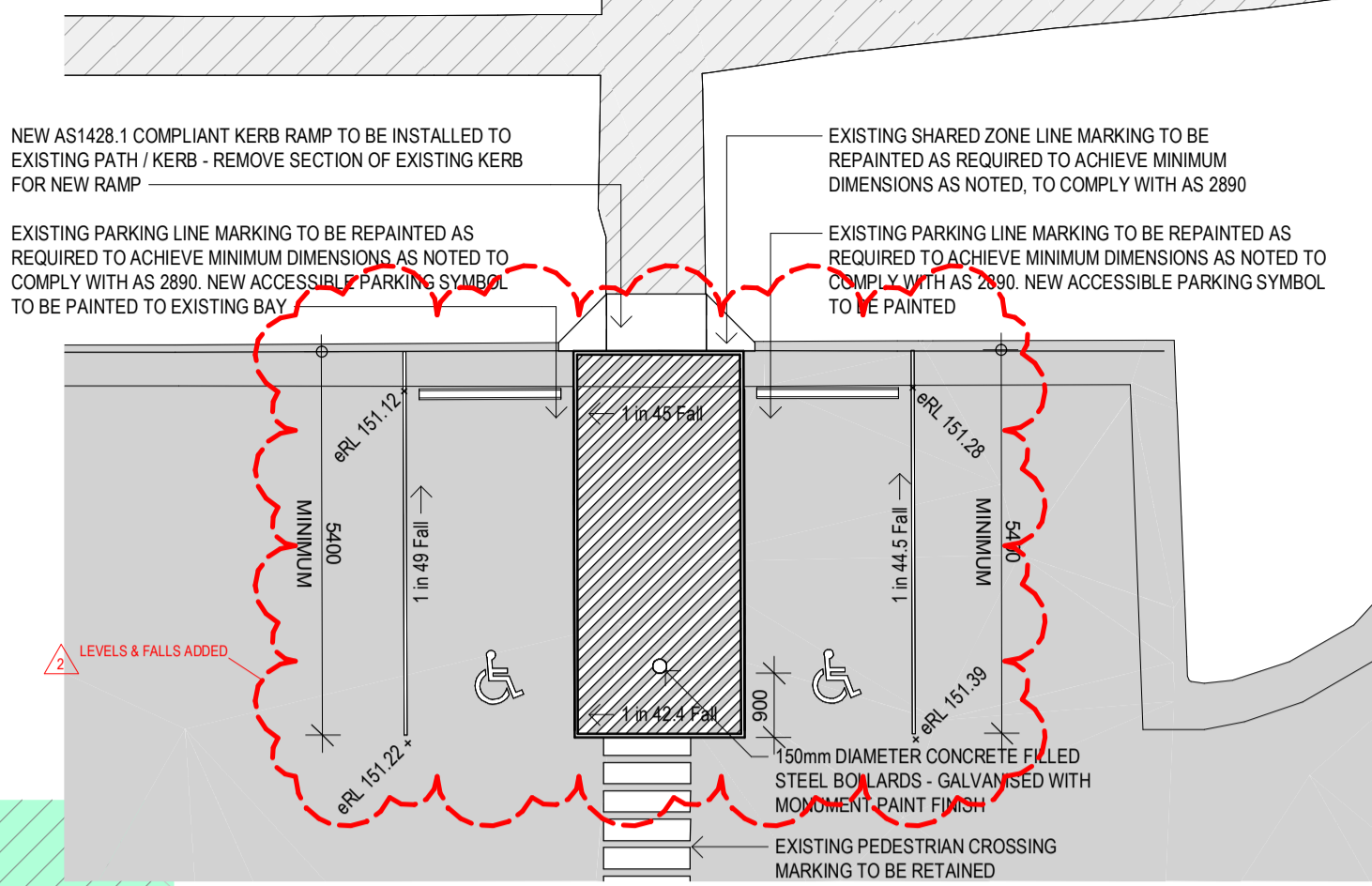
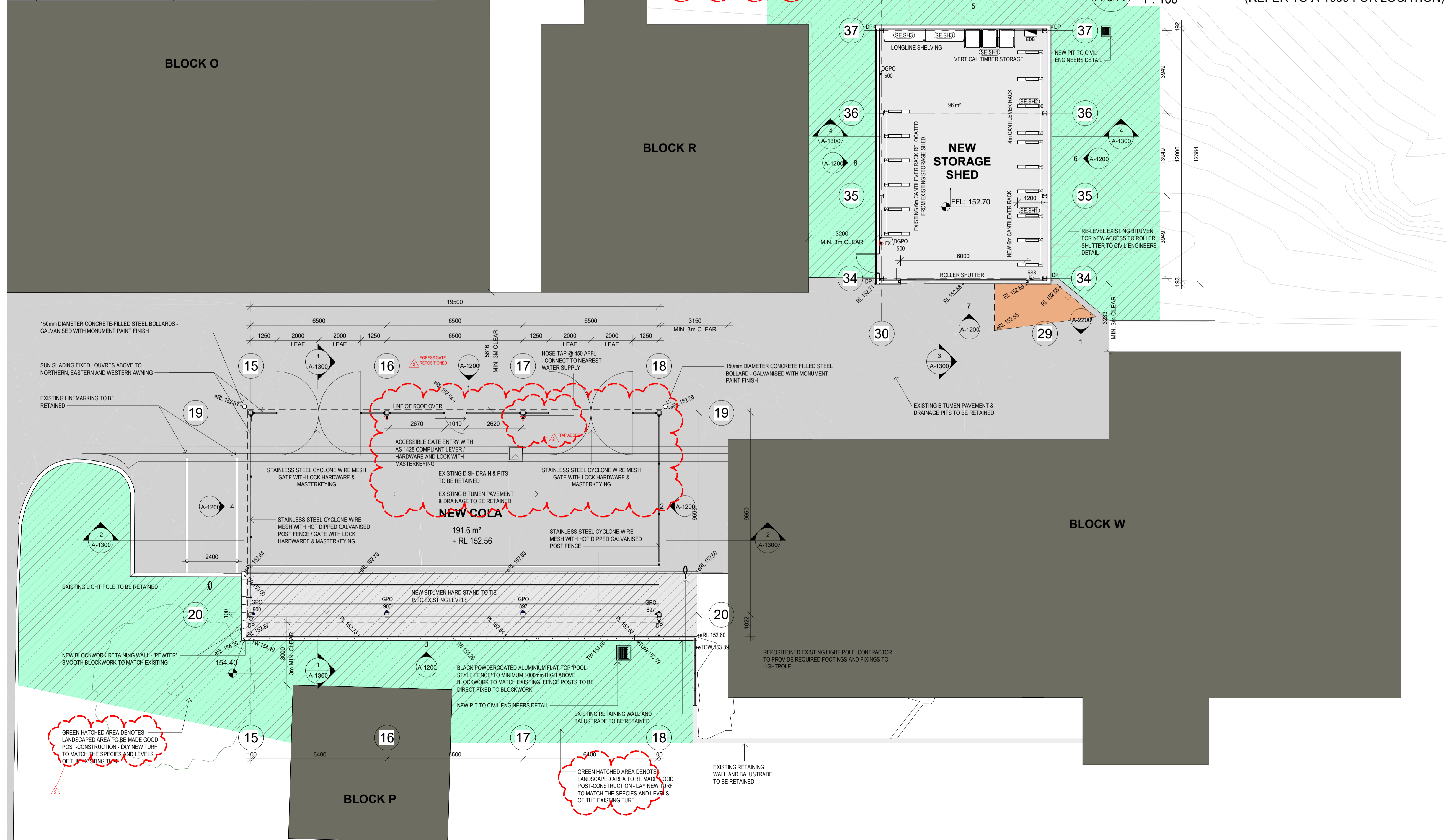

ACN 002 912 843 | ABN 82 644 649 849
 Nominated Architect - Bernard Collins
 NSW Architects Registration No 4438
 A 412 KING STREET, NEWCASTLE, NSW, 2300
 P +61 2 4929 2353 | F +61 2 4929 3069
 E mail@eje.com.au | W www.eje.com.au

COMPLETION OF THE QA CHECKS IS VERIFICATION THAT THE DOCUMENT CONFORMS WITH THE REQUIREMENTS OF THE QUALITY PROJECT PLAN, WHERE THE QUALITY ASSURANCE CHECK IS INCOMPLETE THIS DOCUMENT IS PRELIMINARY FOR INFORMATION PURPOSES ONLY, OR SUCH PURPOSES AS STATED IN THE REVISION COLUMN.

THE IDEAS, INFORMATION AND CONCEPTS CONTAINED IN THIS DOCUMENT ARE THE PROPERTY OF EJE. PHOTOCOPYING OR REPRODUCING THIS DOCUMENT AND PASSING IT ON TO OTHERS WITHOUT THE EXPRESS PERMISSION OF EJE IS AN INFRINGEMENT OF COPYRIGHT ©

WORK IN FIGURED DIMENSIONS IN PREFERENCE TO SCALE. CHECK DIMENSIONS AND LEVELS ON SITE PRIOR TO THE ORDERING OF MATERIALS OR THE COMPLETION OF WORKSHOP DRAWINGS. IF IN DOUBT ASK. REPORT ALL ERRORS AND OMISSIONS.

DRN | CHKD | WRD
 SG | TH | TH
 SG | SG

DATE
 31/07/2025
 19/06/2025

REV
 1
 2

COMMENTS
 ISSUED FOR CONSTRUCTION
 ISSUED FOR ADDENDUM 01

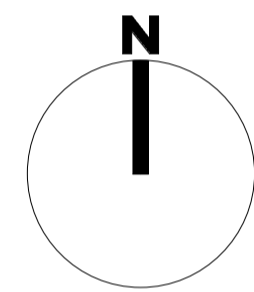

CLIENT:
 TAFE NSW

OPTIONAL ADDITIONAL WORKS 01 - FLOOR PLAN

Autodesk Docs/Muswellbrook TAFE Stage 3/15634 - Muswellbrook TAFE Stage 3 - R24.rvt

PROJECT:
 MUSWELLBROOK STAGE 3
 63 MAITLAND STREET,
 MUSWELLBROOK, NSW, 2333
 WONNARUA COUNTRY

DRAWN:
 SG

PROJECT No:
 15624

SCALE:
 1 : 100 @ A1
 1 : 200 @ A3

DATE:
 JULY 2025

PHASE:
 CD

DRAWING No:
 A-1100

REV:
 2

