

# Scope of Work

---

- The Contractor is to terminate all power and water and reinstate for the replacement shed.
- The Contractor must adhere to the independent occupations hygienist to provide technical advice regarding any special requirements pertaining to the demolition works, conduct appropriate testing of any potentially hazardous materials and verify achievement of clearance including provision of associated reports and certifications for the works. It is expected that the Contractor engages appropriately qualified and experienced consultants to inform and certify the works. It is expected that the Contractor engage the Hygienist from the Department of Education NSW approved Hygienist panel.
- The development must be carried out in accordance with AS 2601 – 2001. *The demolition of structures*, and run-off and erosion controls to prevent soil erosion, water pollution or the discharge of loose sediment on the land surrounding the development must be implemented by diverting uncontaminated run-off around cleared or disturbed areas.

## 1.3 Rebuild

- Design and construct concrete footings certified by a Structural Engineer. Cut, fill, form up and pour slab for Colorbond shed approximately 14m x 4m in the nominated area to allow for the new shed. 120mm minimum thickness 25Mpa 80mm slump. Minimum 50mm raised rebate to prevent flooding. Slab is to be hand coved finished and have saw cuts for expansion and ironed edges. Slab to be reinforced with F.72 steel mesh on chairs in the top 25mm from the top of the slab.
- Allow for all earthworks/ retaining wall as required including stormwater, ag line control.
- All down pipes are to be installed and piped to existing storm water system. All downpipes are to be fitted with galvanised guards to 1800mm high to prevent damage to the PVC pipe
- Roof pitch to be 15 degrees.
- Shed roller doors to be 2.10h x 2.57w lockable heavy-duty roller doors, one at southern end and one on the western side. All doors to be keyed to the school's master key system.
- The wall and roof cladding including guttering, downpipes, fascia, barge, ridge capping and all finishing trims are to be 0.48mm BMT colour bond custom orb finish fixed in place with matching colour tek screws.
- Appropriate roof insulation is to be installed.
- Include a new dividing wall with one personal access internal door. Allow for internal linings to kitchenette and WC areas only.
- Install 4 windows all with security bars

# Scope of Work

- Allow for a concrete path to personal access door and wider path/access ramp to R/doors for ride on lawn mowing equipment/plant.
- Allow suitable general power & lighting outlets fed from new electrical sub board. Supply and install LED strip lights in each area and six (6) double GPO's.
- Allow to supply & install new mini kitchenette and separate WC with hand wash basin with 80litre hot water system.
- Supply and install Aircell type sarking insulation over WORKCOVER approved safety wire, to whole of metal-sheeted roof area. Supply and install Aircell type sarking insulation to walls of Animal pens & Chicken Pens. Supply and install RZ.5 insulation to all walls & R4.0 to ceiling of the office
- All plumbing is to be carried out by a licensed plumber and to Australian standards. All storm water is to be connected to existing storm water.

## 1.4 Concept Plan

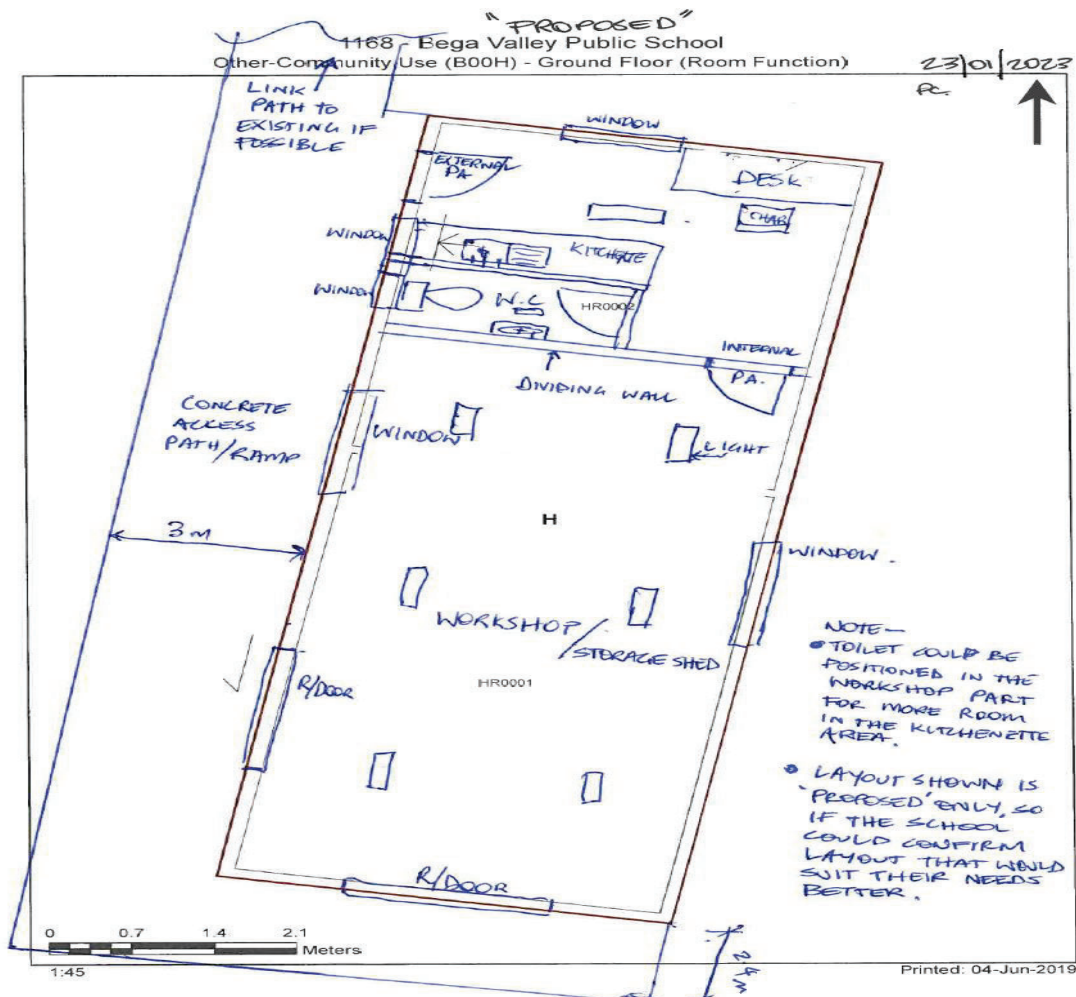

# Scope of Work

## 1.5 DoE Security Services

The Contractor is to allow to contact Department of Education (DoE) School Security in relation to any DoE Security cabling and infrastructure.

Where damage is caused to the security cabling, pits, conduits or detection components the contractor will be fully responsible for the engagement and payment of all costs in relation to the reinstatement of damage system utilising the DoE School Security preferred contractor. All as per Preliminaries Clause – Existing Services

## 1.6 Location

